

# Madspeed DriftKing 1/10 EP Drift Car Brushed/Brushless Edition

## ASSEMBLY:

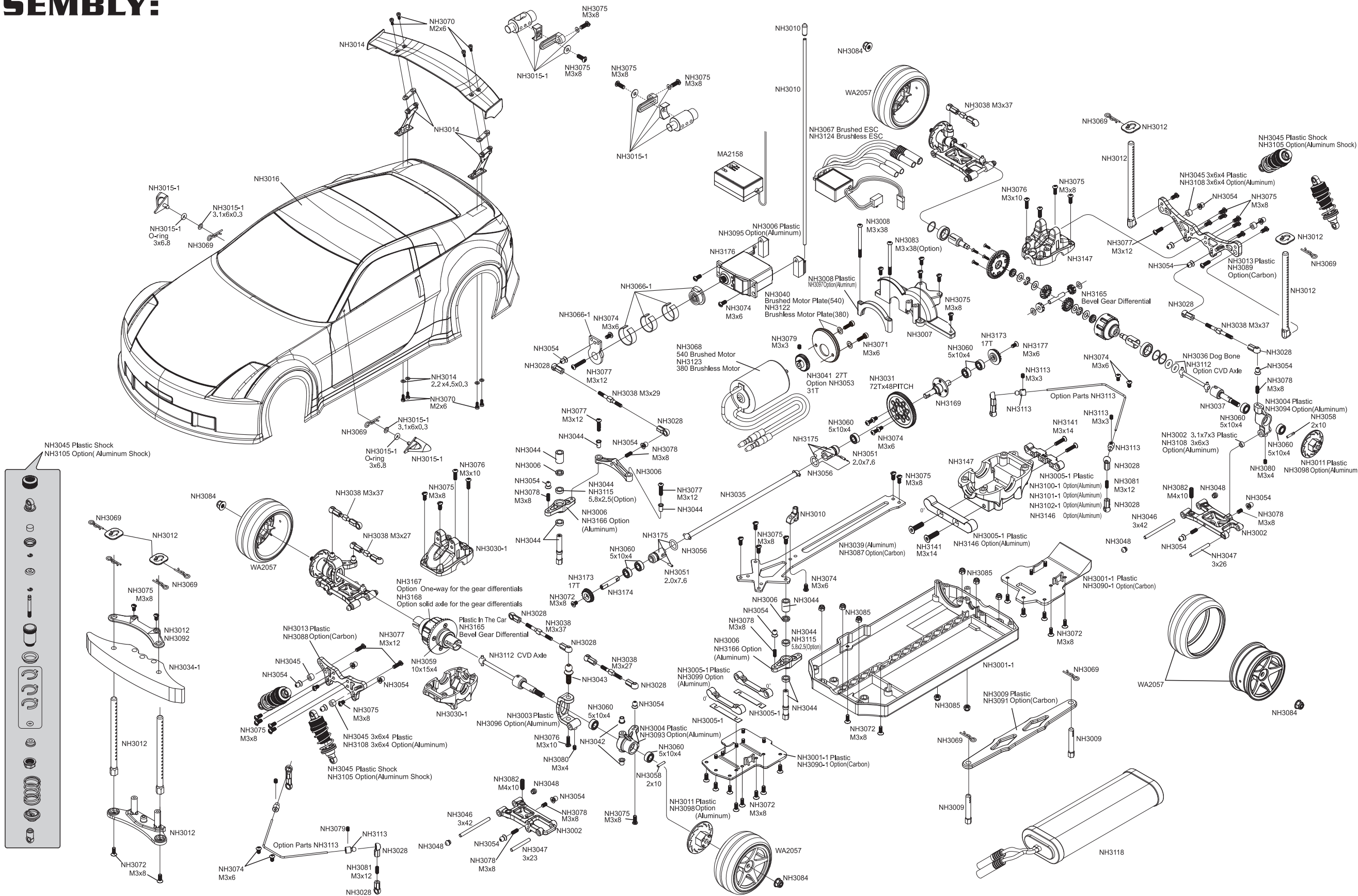

Length : 440mm  
Track Width : 188mm  
Height : 135mm  
Wheelbase : 259mm  
Radio System : 2.4GHz  
Powered  
Brushed Edition : 540 Brushed Motor  
Brushless Edition : 380 Brushless Motor  
Battery : NiMH, 2000mAh, 7.2V

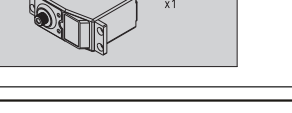
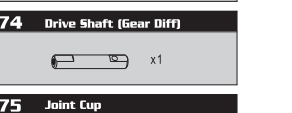
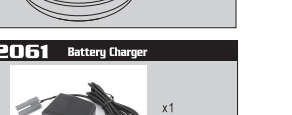
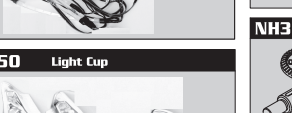
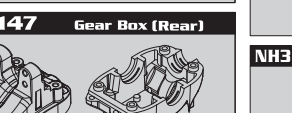
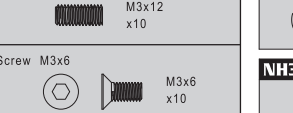
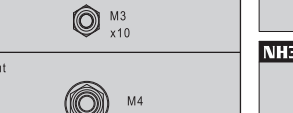
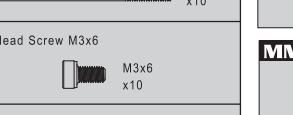
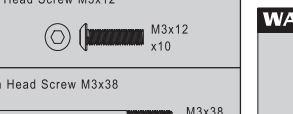
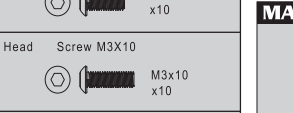
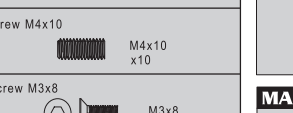
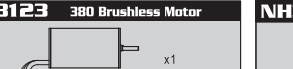
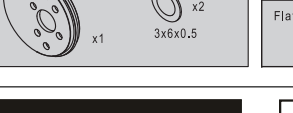
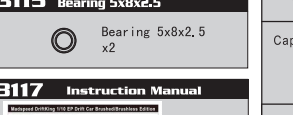
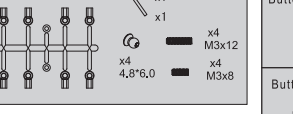
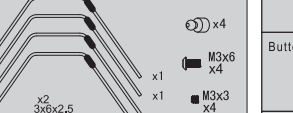
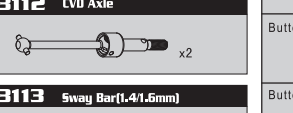
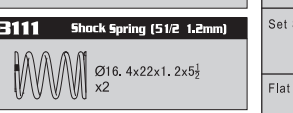
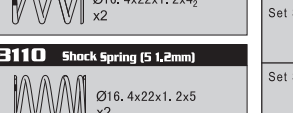
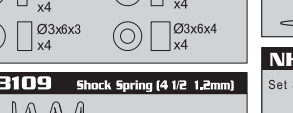
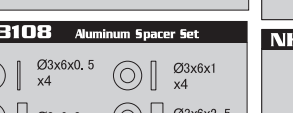
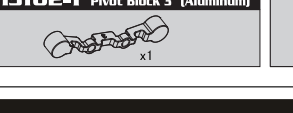
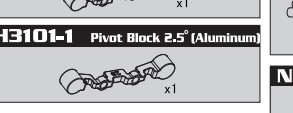
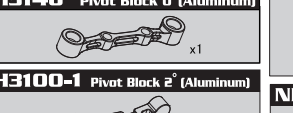
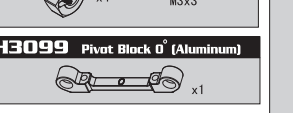
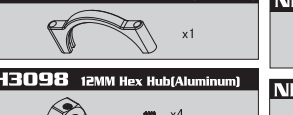
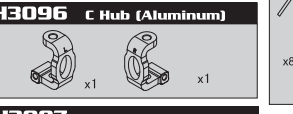
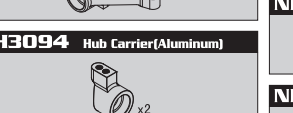
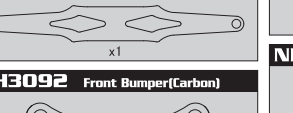
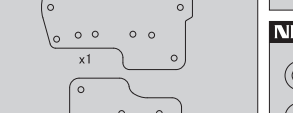
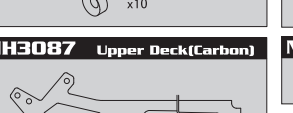
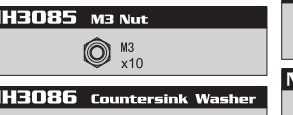
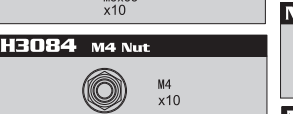
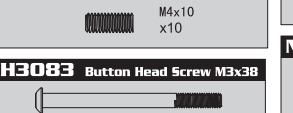
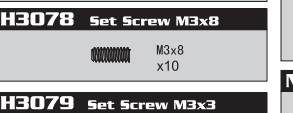
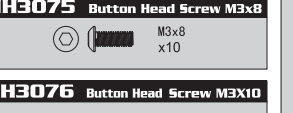
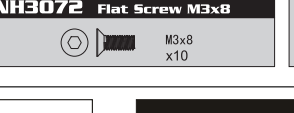
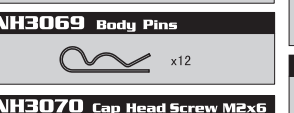
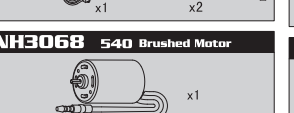
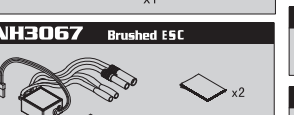
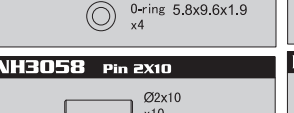
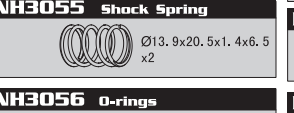
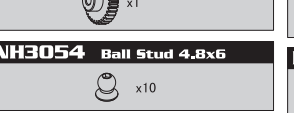
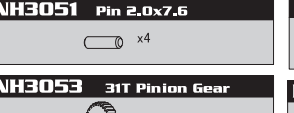
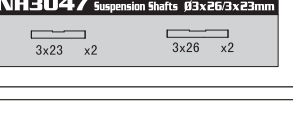
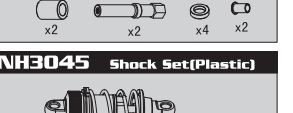
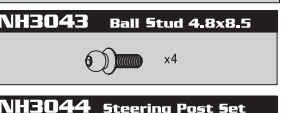
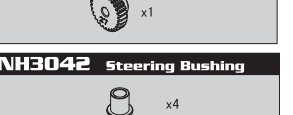
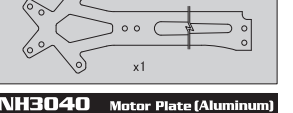
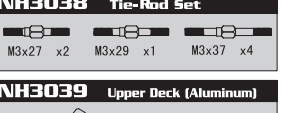
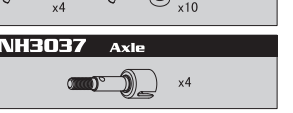
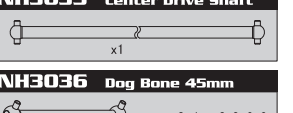
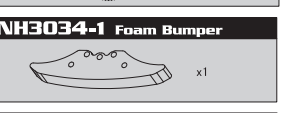
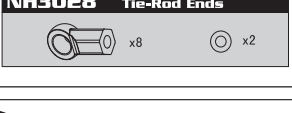
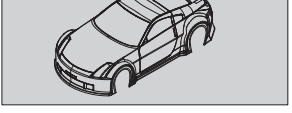
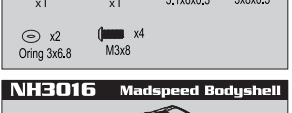
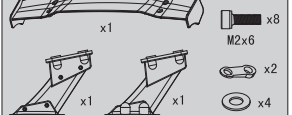
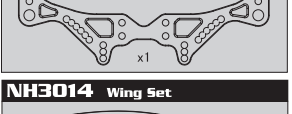
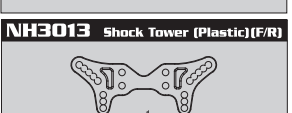
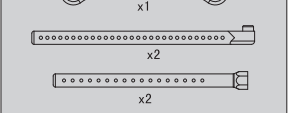
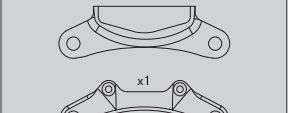
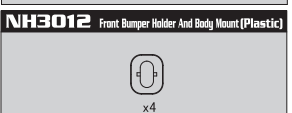
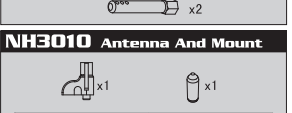
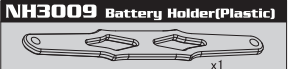
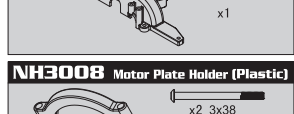
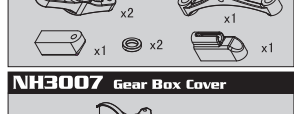
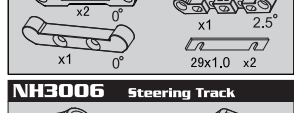
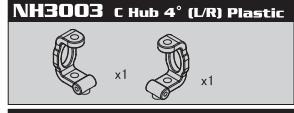
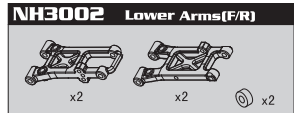
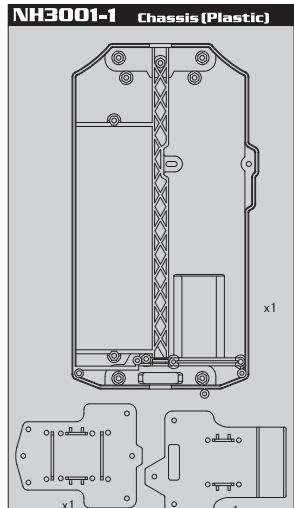

## WARNINGS

- The product is not intended for those under 14 years of age without proper adult supervision. The product is not a toy. It is a precision machine requiring proper assembly and setup to avoid accidents and it is the responsibility of the owner to operate this product in a safe manner as it can cause serious personal injury and damage to property due to carelessness or misuse.
- Do not attempt to disassemble or modify any of the product components without the assistance of an experienced RC user.
- Only use the correct type of battery to operate. Using any wrong type of battery will damage the product and possibly make it dangerous to operate.
- The motor(s) may get hot during use. Always allow 10-15 minutes between each operation for the motor to cool down. This will prolong the life of your product.
- Choose an appropriate operating site consisting of flat, smooth ground, and clear open field. Do not operate near buildings, high voltage cable lines, or trees to ensure safety operation. Operate in safe area only, away from other people. RC models are prone to accidents, failures, and crashes due to a variety of reasons including: lack of maintenance, user error, and radio interference. Users are responsible for their actions and damage or injury occurring during the operation.
- Do not operate in inclement weather, such as rain, wind, snow or darkness.
- The product is composed of precision electrical components. It is critical to keep the product away from moisture and other contaminants. Do not allow them to get wet. Electrical damage may occur that could affect safe operation.
- You should complete a successful pre-run check of your radio equipment and model prior to each run.

- After each use, always allow the battery to cool down before recharging. When charging the battery pack, do not overcharge. If batteries get hot during charging, discontinue charging immediately and disconnect the battery from the charger. Never leave battery unattended while charging. If you are unsure of how to charge this battery, please seek the advice of experienced RC users. Never let children charge the battery without adult supervision.
- Always turn on the transmitter before connecting the battery on the model. When turning off the model, always disconnect the battery first, and then turn off the transmitter. If the order is reversed, the model may become uncontrollable and cause serious damage.
- If you are in doubt of your ability to operate model, we strongly recommend that you seek assistance from experienced RC users or join your local model modeling club to gain the required knowledge and skill. As the manufacturer and distributor, we assume no liability for the use of this product.
- Before turning on your model and transmitter, please check to make sure no one else is operating under the same frequency. Frequency interference can cause your model, or other's models to crash. The guidance provided by experienced RC users will be valuable for the assembly, tuning, trimming, and actual first operation.
- Never allow batteries to run low or you might lose control of the model.
- Plastic is very susceptible to damage or deformation due to extreme heat and cold climate. Do not store the model near any source of heat such as oven or heater. Store the model indoors, in a climate-controlled, room temperature environment.

## Charge the Ni-MH battery pack

The battery should be fully charged in 2 hours. Disconnect the battery from the charger when the charging process completed. Do not charge the battery unattended at all time.

## Ni-MH Battery Warnings

- Never charge Ni-MH battery with a charger designed for Li-Po, or any other type of battery chemistry. Use ONLY charger designed for Ni-MH battery.
- Do not leave Ni-MH battery unattended during charging.
- Do not overcharge the battery.
- Always place the battery on a heat resistant surface alone when charging.
- Always put the Ni-MH battery inside a charging protection container while charging.
- Do not allow Ni-MH cells to overheat at any time. Cells which reach greater than 140 Fahrenheit (60°C) will usually become damaged and will catch fire.
- Do not allow Ni-MH cells on or near combustible materials including paper, plastic, carpets, vinyl, leather, and wood, inside an R/C model or full size automobile.
- Do not over discharge Ni-MH; doing so will damage the battery.
- Do not expose Ni-MH cell to water or moisture at any time.
- Do not store battery near open flame or heater.
- Do not assemble Ni-MH cells or pre-assembled packs together with other Ni-MH cells or packs.
- Always store Ni-MH battery in a secure location away from children.
- Always remove the Ni-MH battery if a model is involved in any kind of crash. Carefully inspect the battery and connectors for even the smallest damage. CAUTION: cells may be hot!
- Do not allow the electrolyte to get into eyes or on skin. Wash affected areas immediately if they come into contact with electrolyte. Do not alter or modify connectors or wires of a Ni-MH battery pack.
- Always inspect the condition of the battery before charging and operating.
- Do not short circuit the Ni-MH battery.
- Do not have contact with a leaky/damaged battery directly.
- Do not charge battery out of recommended temperature rang (0°C-45°C)

Exceed-RC has been making RC products aimed at making our hobby fun and exciting with an affordable price. We are confident that your experience with our products will be positive. Of all the radio controlled models out there, no question about it, RC cars are the hardest to operate. We highly recommend that you read this user manual thoroughly and carefully before assembling and operating. Please follow all precautions and recommendations located within the manual. Be sure to retain the manual for future reference, routine maintenance, and tuning. Exceed-RC guarantees this product to be free of manufacturing faults and material defects. This product has been checked and fine tuned individually by professional staff and quality control staff. The warranty does not cover any component parts damaged by use and modification. Please visit <http://www.exceedrc.com> for updated information. This product is not a toy. It is not recommended for children under 14 years old and any minor should be accompanied by an adult when operating. This product is a precision machine that requires proper assembly and setup to avoid accidents. Failure to take caution when operating this product may result in serious injury or property damage. It is the owner's responsibility to operate this product in a safe manner. Manufacturer and its distributors are not responsible in any way for any and all bodily injury(s) and/or property damage that may occur from the use of or caused by in any way of this product.



# INSTRUCTION MANUAL

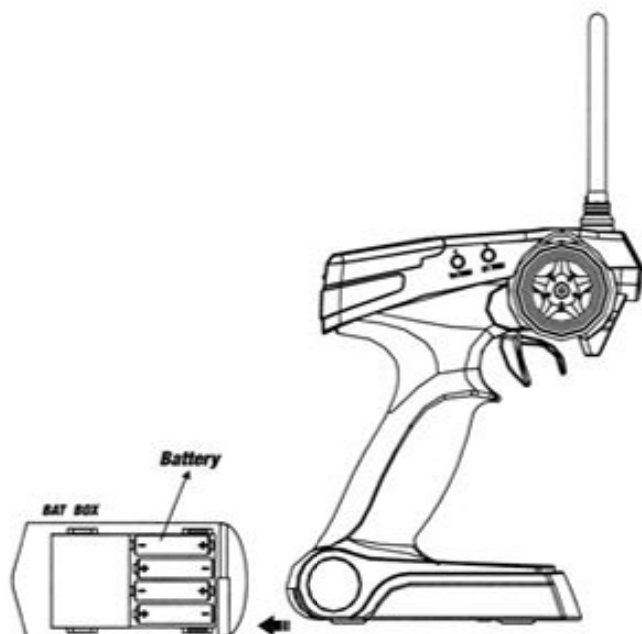

## Install the batteries

- (1) Remove the battery compartment cover.
- (2) Replace the used batteries with new AA size batteries.

Please replace batteries when the power indicator blinks or the buzzer beeps.

## Function

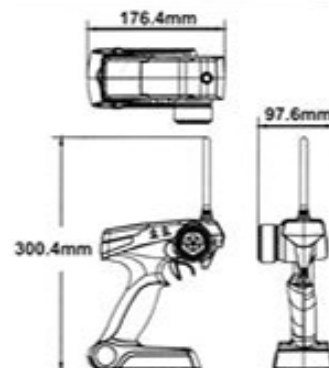
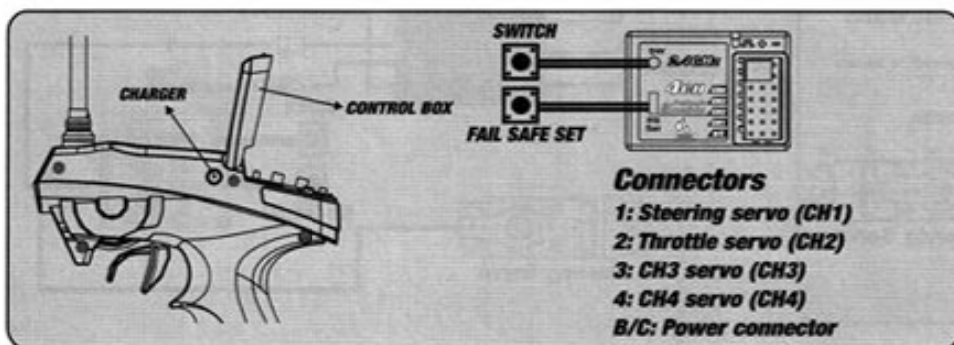
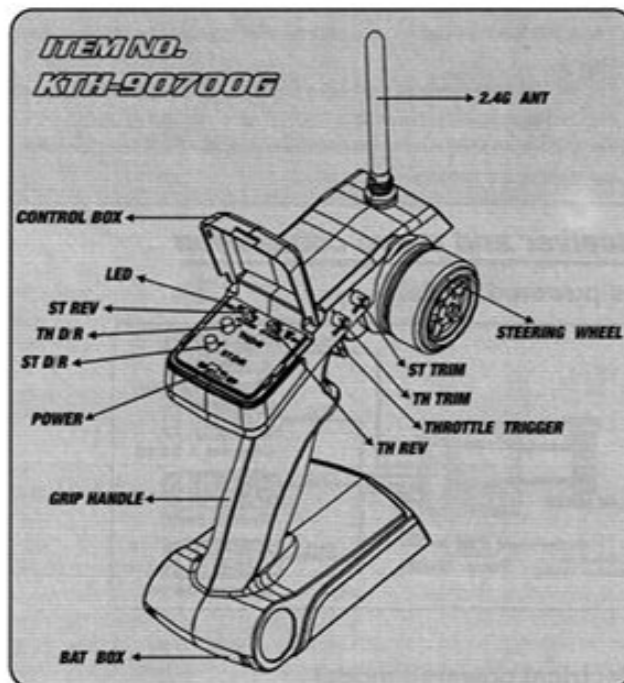
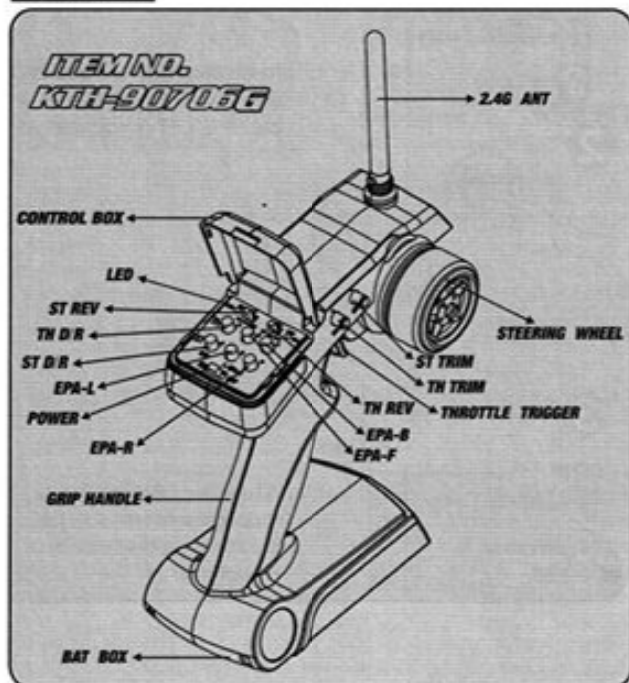



## Transmitter Adjustment

### A. Throttle Trigger

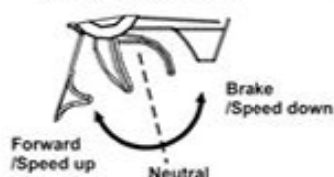

1. Push the trigger forward to slow down or brake.
2. Pull the trigger backward to accelerate.

### B. Steering Wheel

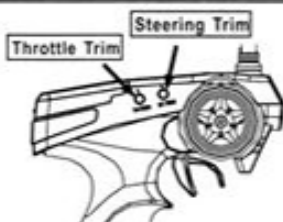
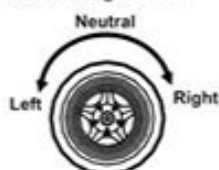

**Keep the transmitter and receiver 40cm apart when operating.**

**Use the REV switches to reverse the steering or throttle operating direction.**

**Throttle Trim:** Trim the throttle servo slightly when the trigger is at the neutral position.

**Steering Trim:** If the front wheels do not align straight, use the steering trim to adjust.

## Low battery alarm

Do not operate the radio system when the battery power is low. The battery power is low.

## Fail Safe Function Setting

1. Set the TH, ST switches to the normal position.
2. Turn on the transmitter and receiver.
3. Press the F/S SET button, the LED on the receiver should start flashing rapidly.
4. Put the throttle trigger at the brake position, press the F/S SET button, the LED should become solid.
5. For electric model, put the throttle trigger at the stop position when you are making the setting.

## Receiver and servo connection

### Gas powered model

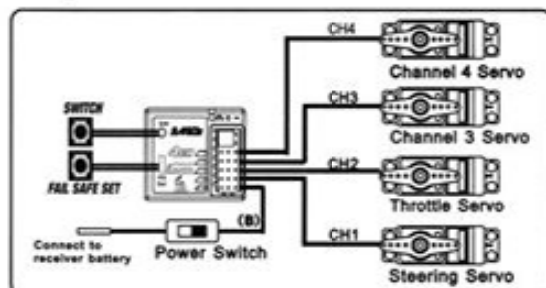

### Electrical powered model

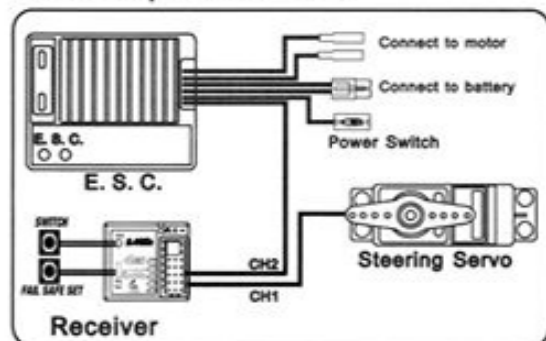

## Binding the transmitter and receiver

1. turn on the receiver power. Press the SW switch. The receiver's LED should start flashing.
2. Turn on the transmitter.
3. When the LED on the receiver becomes solid, the binding process is completed.

