

EXPLODED VIEW

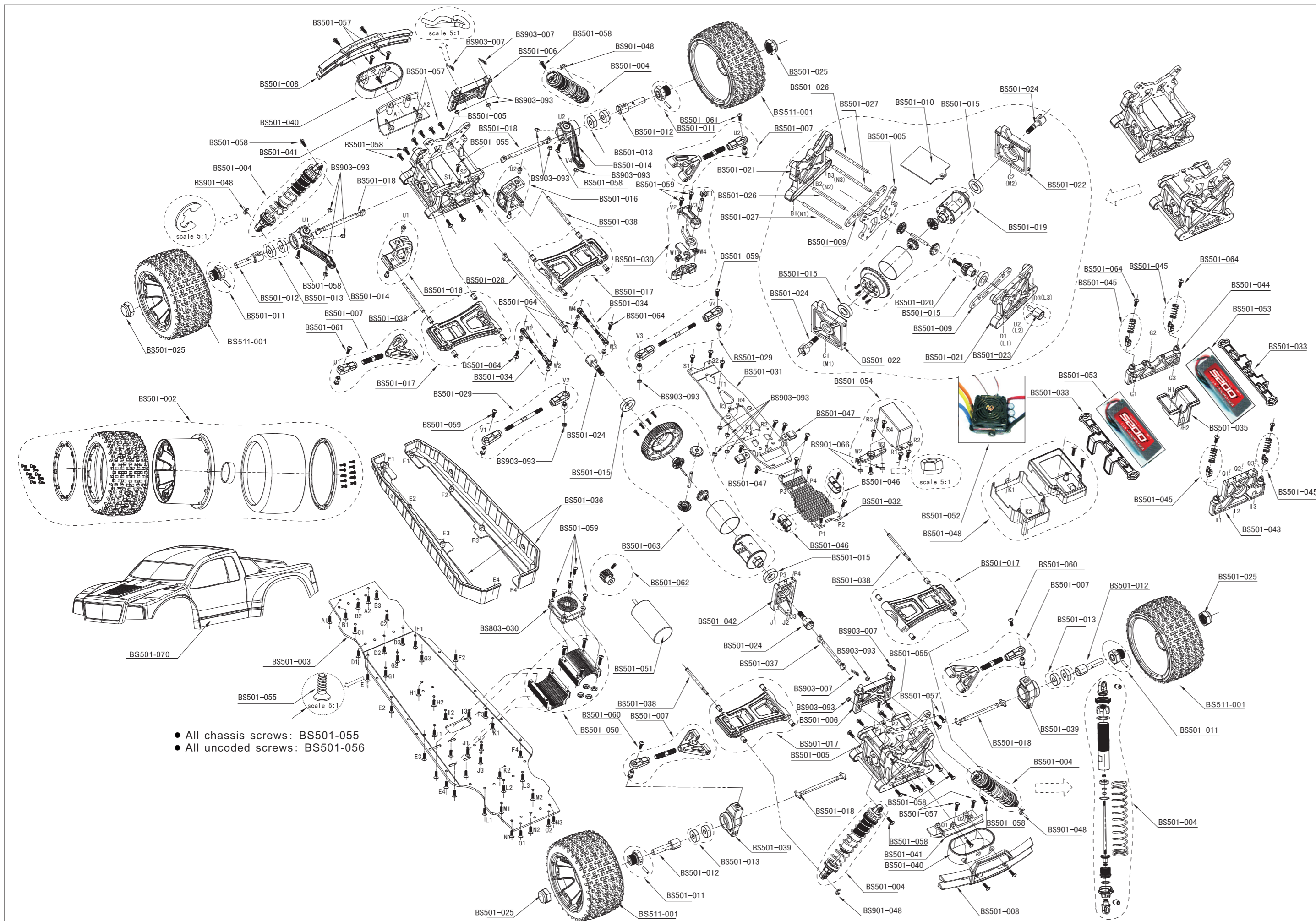

BS501-001 Tire set 2pcs	BS501-003 Chassis 1pcs	BS501-004 Shock absorber unit 2pcs	BS501-005 Shock mount 2pcs	BS501-006 Body mount 2pcs	BS501-007 Upper suspension arm 2pcs	BS501-008 Bumper 2pcs
BS501-009 Lower suspension mount 2pcs	BS501-010 Gear box upper cover 2pcs	BS501-011 Rim hub w/pins 2pcs	BS501-012 Axel 2pcs	BS501-013 Ball bearing 2 pcs (Ø10*Ø23*7mm)	BS501-014 Steering arms 2pcs	BS501-015 Ball bearing 2 pcs (Ø15*Ø28*7mm)
BS501-016 C-hub set 2pcs	BS501-017 Suspension arms set	BS501-018 Transverse driver shaft set 2pcs	BS501-019 Diff gear box unit 1 pcs	BS501-020 Pinion gear set 1 pcs (gear 15:1 pos/screws 1 pcs)	BS501-021 Diff gear front cover (pos/rear cover 1 pcs)	BS501-022 Diff gear left cover (pos/right cover 1 pcs)
BS501-023 Diff. outdrive A 1 pos/pin 1pcs	BS501-024 Diff. outdrive B 2pcs	BS501-025 M18 nut 2 pcs	BS501-026 Upper suspension arm pin 4pcs	BS501-027 Lower suspension arm pin 4pcs	BS501-028 Front drive shaft 1 pcs	BS501-029 Steering link set 2 pcs
BS501-030 Steering servo saver set 1 pcs	BS501-031 Front upper deck 1 pcs	BS501-032 Rear upper deck 1 pcs	BS501-033 Battery cover	BS501-034 Servo saver link set 2 pcs	BS501-035 Battery base 1 pcs	BS501-036 Sidguards L/R 1 set
BS501-037 Rear drive shaft 1 pcs	BS501-038 Lower suspension arm shaft 2pcs	BS501-039 Rear hub 2pcs	BS501-040 Bumper mount 2 pcs	BS501-041 Bumper chassis 2 pcs	BS501-042 Central diff rear mount 1 pcs	BS501-043 Central diff front mount 1 pcs

BS501-044 Steering saver lower mount 1 pcs	BS501-045 Battery mount	BS501-046 wire mount A,2 pcs	BS501-047 Wire mount 2 pcs	BS501-048 Receiver cover upper/lower set w/screws 2 pcs	BS501-070 Painted body 1 pcs	BS501-050 Motor mount set
BS501-051 Brushless motor KV 1820 1pcs	BS501-052 Brushless ESC 150A 1 pcs	BS501-053 Lipo batteries 7.4V 5200mAh 1 pcs	BS501-054 20KG Servo 1 pcs	BS501-055 Flat head hex fine pitch screws HM4*12/12 pcs	BS501-056 B head hex fine pitch screws HM4*12/12 pcs	BS501-057 B head hex fine pitch screws HM4*16/12 pcs
BS501-058 B head hex fine pitch screws HM4*20/12 pcs	BS501-059 B head hex fine pitch screws HM4*25/12 pcs	BS501-060 B head hex fine pitch screws HM4*30/6 pcs	BS501-061 B head hex fine pitch screws HM4*37/6 pcs	BS501-062 Motor gear set	BS501-063 Central diff unit 1 set	BS501-064 B head cross screw BM3*16 /12pcs
BS803-030 Cooling fan 1 pcs	BS903-007 Body pin 1.5 6pcs	BS903-003 M4* Nylon self-lock nut 6pcs	BS901-048 3*10.6 E-ring 12pcs	BS901-066 M3 lock nut 5pcs	B7053 2.4GHz Transmitter	B7054 2.4GHz Receiver

Upgrade Parts (For 6S LiPo Batteries Setup)

BS501-051R Brushless motor KV 1150 1pcs	BS501-053R LiPo Batteries 11.1V 5200mAh 25C 1pcs
---	--