

D10sc 1/10th Scale Electric Short Course Truck

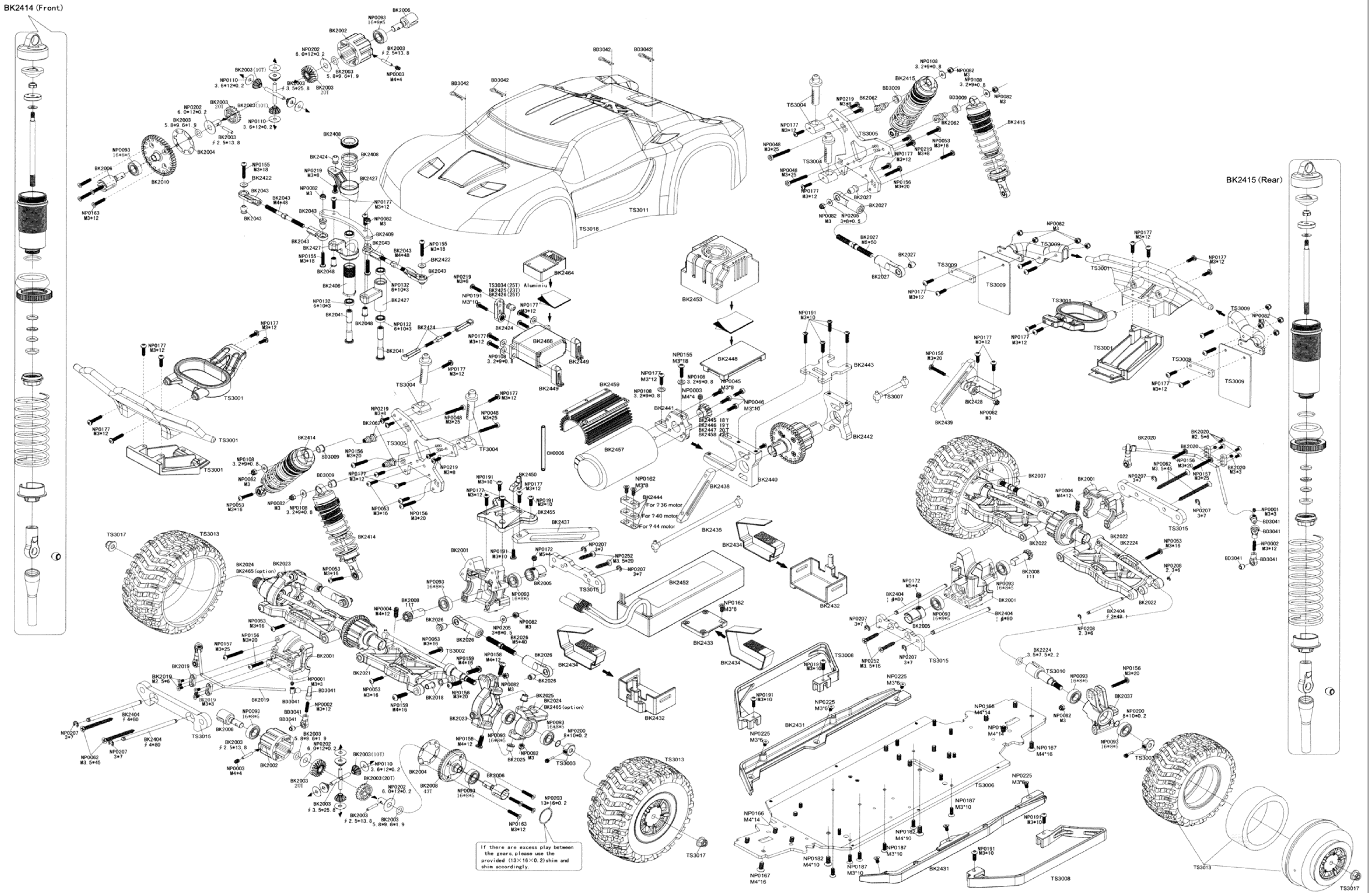

Length: 550mm
 Height: 190mm
 Tread: 300mm
 Wheelbase: 334mm

BK2001 Gear Box x1	BK2002 DIFF Cover x1	BK2003 DIFF Gear Set x1	BK2004 DIFF Seal x4	BK2005 Joint Cup x2	BK2006 DIFF Outdrives x2	BK2008 Steel DIFF Ring Gear x1	BK2009 Power Meter/Transmitter Gear 40:1 x1	BK2010 Steel Spur Gear 40:1 x1	BK2018 Center Block Bushing x4	BK2019 Anti-roll Bar Front (L-R) x1	BK2020 Anti-roll Bar Rear (L-R) x1	BK2021 Front Lower Arms x2	BK2022 Rear Lower Arms x2	BK2023 Steering Mount Set x1	BK2024 Steering Block Set x1	BK2025 Steering Block Bushing x1	BK2026 Upper Front Arms x2	BK2027 Upper Rear Tie-Rod x1	BK2037 Rear Hub Carrier x1	BK2041 Ball Crank Shafts x2	BK2043 Steering Tie-Rod x2	BK2048 Steering Rack Pinion x2	BK2062 Shock Extension Nut x4	BK2068 Body Pin (3.0mm) x10	BK2107 Dust Cover Set x2	CH0006 Antenna Pipe x2	BK2224 Dog Bone Wheel x2	BK2404 Hinge Pin And Clips x8	BK2408 Steering Spring Set (Gold) x1	BK2409 60er 16 Steering Rack (Gold) x1	BK2414 Horn Front Shock (Gold) x1	BK2415 Horn Rear Shock (Gold) x2	BK2422 Servo Mount # (AI Blue) x1	BK2424 Steering Tie-Rod x2	BK2425 Servo Horns #21 x1	BK2426 Servo Horns #27 x1	BK2427 Steering Bell Crank x1	BK2428 Chassis Brace (Gold) x1	BK2431 Splash Guards L/R x1	BK2432 Battery Box x1	BK2433 Battery Undertray x1	BK2434 Battery Tie Wrap x1	BK2435 Drive Shaft Center-Front x1	BK2437 Chassis Brace (Gold)-Front x1	BK2438 Chassis Brace (Gold)-Midst x1	BK2439 Chassis Brace (Gold)-Rear x1	BK2444 Motor (4000 RPM) x1	BK2445 13T Pinion Gear x1	BK2446 19T Pinion Gear x1	BK2447 20T Pinion Gear x1	BK2448 ESC Holder x1	BK2449 Servo Holder x1	BK2450 Antenna Set x1	BK2452 14.8V Li-Po Battery x1	BK2453 Brushless ESC (600A) x1	BK2455 Front and Rear Body Mount x1	BK2457 540L Brushless Motor x1	BK2458 13T Pinion Gear x1	BK2459 Motor Bell Crank For 540S Gold x1	BK2463 Transmitter (2.4G) x1	BK2464 Receiver (2.4G) x1	BK2465 Steering Arms x1	BK2466 Servo 15 BKG6 x1	TS3010 Wheel Axle x2	TS3011 Rudershell PVC 1.0 x1	TS3012 Decal x1	TS3013 Racing Nylon Tyres x1	TS3014 Instruction Manual x1	TS3015 Lower Suspension Mount (Gold) x1	TS3017 M5 Shim Lock Nut x1	TS3018 Clear PC Rudershell x1	TS3008 Rudershell Brass x1	TS3009 Splash Guards L/R x1	NP0005 Set screws 5*4 x10	NP0015 M3*7.5 Round Head Tapping x10	NP0017 M3*10 Round Head Tapping x10	NP0046 M3*10 Hex Head Machine x10	NP0047 M3*10 Hex Head Machine x10	NP0048 M3*10 Hex Head Machine x10	NP0053 M3*10 Hex Head Tapping x10	NP0062 M3*5*4 Flat Head Tapping x10	NP0082 M3 Hex Head Tapping x10	NP0093 M3*10*5mm Ball Bearing x10	NP0108 3.6*12*0.2mm Flat Washer x10	NP0115 5.1*9*0.5mm Flat Washer x10	NP0132 6*10*3 Ball Bearing x10	NP0135 Set screws 3*4 x10	NP0146 M3*16 Hex Head Machine x10	NP0152 M3*16 Round Head Tapping x10	NP0155 M3*16 Hex Head Tapping x10	NP0156 M3*10 Hex Head Tapping x10	NP0158 M4*16 Hex Head Tapping x10	NP0159 M4*16 Hex Head Tapping x10	NP0162 M3*8 countersunk Hex screw x10	NP0163 M3*12 countersunk Hex screw x10	NP0166 M4*14 countersunk Hex screw x10	NP0167 M4*16 countersunk Hex screw x10	NP0172 Set screws 5*4 x10	NP0177 M3*16 Hex Head Tapping x10	NP0182 M4*10 countersunk Hex screw x10	NP0187 M3*10 countersunk Hex screw x10	NP0191 M3*16 Hex Head Tapping x10	NP0194 M3*16 countersunk Hex screw x10	NP0200 6*10*0.2 Washers x10	NP0202 6.0*12*0.2mm Washers x10	NP0203 13*16*0.2mm Washers x10	NP0207 3*7*0.8 E-c clips x10	NP0208 6*7*0.8 E-c clips x10	NP0214 Set screws 3*10 x10	NP0219 M3*16 Hex Head Tapping x10	NP0225 M3*6 countersunk Hex screw x10	NP0242 5.3*7.5*0.3mm Washers x10	NP0252 M3*16 Flat Head Tapping x10
---------------------------------	-----------------------------------	--------------------------------------	----------------------------------	----------------------------------	---------------------------------------	---	--	---	---	--	---	---	--	---	---	---	---	---	---	--	---	---	--	--	---------------------------------------	-------------------------------------	---------------------------------------	--	---	---	--	---	--	---	--	--	--	---	--	------------------------------------	--	---	---	---	---	--	---	--	--	--	-----------------------------------	-------------------------------------	------------------------------------	--	---	--	---	--	---	---	--	--------------------------------------	--------------------------------------	-----------------------------------	---	------------------------------	---	---	--	---	--	---	--	--	---	--	--	--	--	--	--	---	--	--	---	---	--	--	--	--	--	--	--	--	---	---	---	--	--	---	---	--	---	--	--	---	---	---	---	--	--	---	---

WARNINGS

●The product is not intended for those under 14 years of age without proper adult supervision. The product is not a toy. It is a precision machine requiring proper assembly and setup to avoid accidents and it is the responsibility of the owner to operate this product in a safe manner as it can cause serious personal injury and damage to property due to carelessness or misuse.

●Do not attempt to disassemble or modify any of the product components without the assistance of an experienced RC user.

●Only use the correct type of battery to operate. Using any wrong type of battery will damage the product and possibly make it dangerous to operate.

●The motor(s) may get hot during use. Always allow 10-15 minutes between each operation for the motor to cool down. This will prolong the life of your product.

●Choose an appropriate operating site consisting of flat, smooth ground, and clear open field. Do not operate near buildings, high voltage cable lines, or trees to ensure safety operation. Operate in safe area only, away from other people. RC models are prone to accidents, failures, and crashes due to a variety of reasons including lack of maintenance, user error, and radio interference. Users are responsible for their actions and damage or injury occurring during the operation.

●Do not operate in inclement weather, such as rain, wind, snow or darkness.

●The product is composed of precision electrical components. It is critical to keep the product away from moisture and other contaminants. Do not allow them to get wet. Electrical damage may occur that could affect safe operation.

●You should complete a successful pre-run check of your radio equipment and model prior to each run.

●After each use, always allow the battery to cool down before recharging. When charging the battery pack, do not overcharge. If batteries get hot during charging, discontinue charging immediately and disconnect the battery from the charger. Never leave battery unattended while charging. If you are unsure of how to charge this battery, please seek the advice of experienced RC users. Never let children charge the battery without adult supervision.

●Always turn on the transmitter before connecting the battery on the model. When turning off the model, always disconnect the battery first, and then turn off the transmitter. If the order is reversed, the model may become uncontrollable and cause serious damage.

●If you are in doubt of your ability to operate model, we strongly recommend that you seek assistance from experienced RC users or join your local modeling club to gain the required knowledge and skill. As the manufacturer and distributor, we assume no liability for the use of this product.

●Before turning on your model and transmitter, please check to make sure no one else is operating under the same frequency. Frequency interference can cause your model, or other's models to crash. The guidance provided by experienced RC users will be valuable for the assembly, tuning, trimming, and actual first operation.

●Never allow batteries to run low or you might lose control of the model.

●Plastic is very susceptible to damage or deformation due to extreme heat and cold climate. Do not store the model near any source of heat such as oven or heater. Store the model indoors, in a climate-controlled, room temperature environment.

Charge the Li-Po battery pack

Disconnect the battery from the charger when the charging process completed. Do not charge the battery unattended at all time.

Lithium Polymer (LiPo) Battery Warnings

- Never charge a lithium polymer battery with a charger designed for NiCd, NiMH, or any other type of battery chemistry. Use ONLY charger designed for LiPo battery.
- Do not leave LiPo battery unattended during charging.
- Do not overcharge the battery.
- Always place the battery on a heat resistant surface alone when charging.
- Always store the LiPo battery inside a charging protection container while charging.
- Do not allow LiPo cells to overheat at any time. Cells which reach greater than 140 Fahrenheit (60°C) will usually become damaged and will catch fire.
- Do not allow LiPo cells on or near combustible materials including paper, plastic, carpets, vinyl, leather, and wood, inside an RC model or full size automobile.
- Do not over discharge LiPo; doing so will damage the battery.
- Do not expose LiPo cell to water or moisture at any time.
- Do not store battery near open flame or heater.
- Do not assemble LiPo cells or pre-assembled packs together with other LiPo cells or packs.
- Always store LiPo battery in a secure location away from children.
- Always remove the LiPo battery if model is involved in any kind of crash. Carefully inspect the battery and connectors for even the smallest damage. CAUTION: cells may be hot!
- Do not allow the electrolyte to get into eyes or on skin. Wash affected areas immediately if they come into contact with electrolyte. Do not alter or modify connectors or wires of a LiPo battery pack.
- Always inspect the condition of the battery before charging and operating.
- Do not short circuit the LiPo battery.
- Do not have contact with a leaky/damaged battery directly.
- Do not charge battery out of recommended temperature rang (0°C-45°C)