

# G8x 1/8 Scale Nitro Buggy

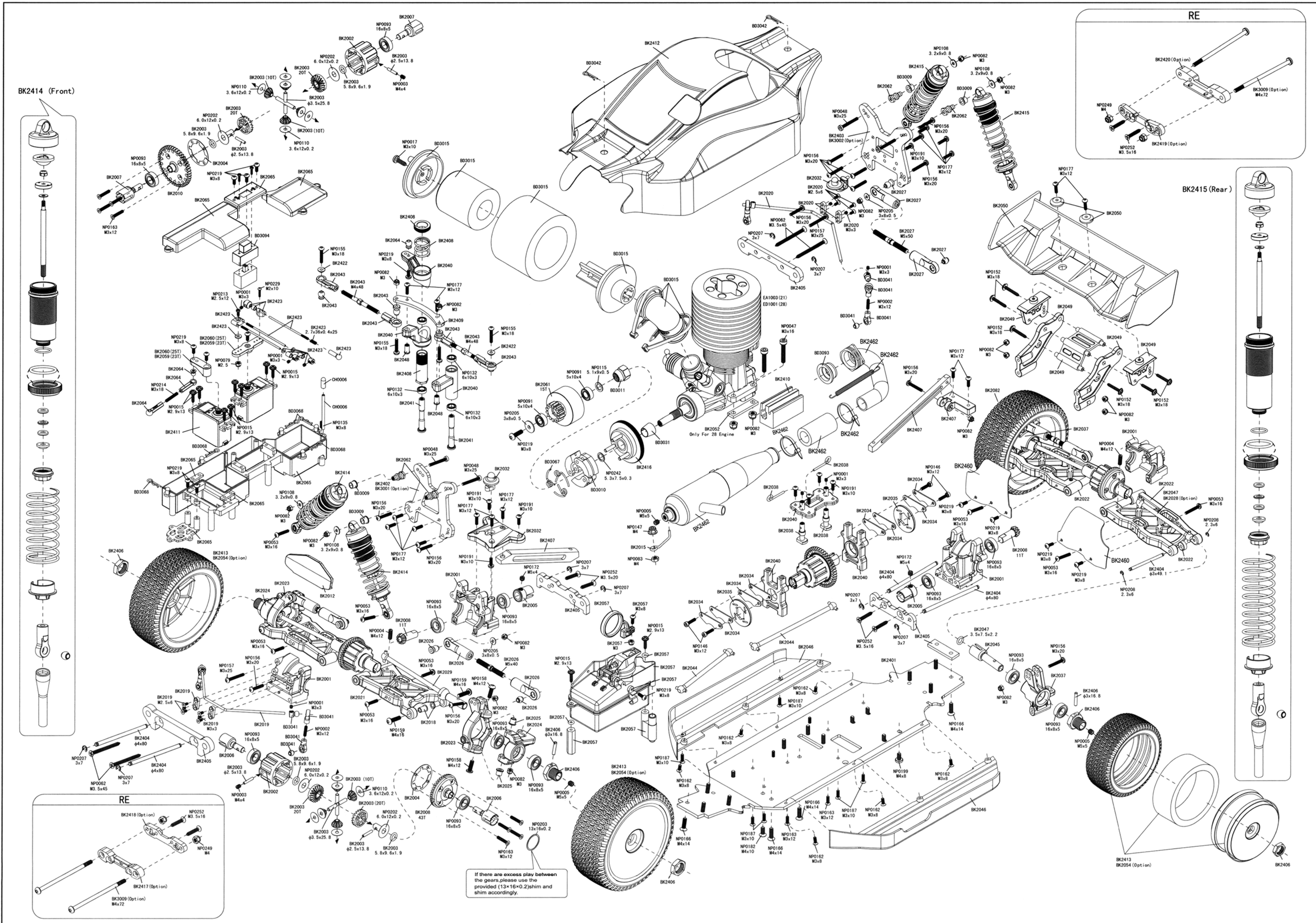

Length : 510mm  
Track Width : 305mm  
Height : 195mm  
Wheelbase : 332mm

<b>BK2001</b> Gear Box	<b>BK2019</b> Anti-roll bar front (2.4)	<b>BK2038</b> FR Brake Actuator	<b>BK2054</b> 18 Racing Spike White Dish Tires	<b>BD3015</b> Air Filter Set	<b>ED1001</b> Engine #28	<b>BK2409</b> 6061 T6 Steering Rack Gold	<b>BK2463</b> Transmitter	<b>NP0062</b> M3.5x4.5 Flat Head Tapping	<b>NP0152</b> M3x10 Round Head Tapping	<b>NP0194</b> M2.5x6 Countersunk Hex Screw
<b>BK2002</b> Diff Case	<b>BK2020</b> Anti-roll bar rear (2.4)	<b>BK2040</b> Steering Bell Cranks	<b>BK2057</b> Fuel Tank Set	<b>BD3031</b> Collar	<b>BK2411</b> Servo 13KG5	<b>BK2410</b> Engine Mounts Blue	<b>BK2464</b> Receiver (2.4G)	<b>NP0079</b> M2.5 2.5mm Lock Nut	<b>NP0155</b> M3x10 Hex Head Tapping	<b>NP0199</b> Screw M4x8
<b>BK2003</b> Diff Gear Set	<b>BK2021</b> Front Lower Arms	<b>BK2041</b> Bell Crank Shafts	<b>BK2059</b> Servo Horns 23T	<b>BD3041</b> Anti-roll bar Bell End	<b>MA2138</b> Servo 3KG5	<b>BK2412</b> Bodyshell With Decal	<b>BK3009</b> M4x12 rear suspension pin (standard)	<b>NP0082</b> M3 3mm Lock Nut	<b>NP0156</b> M3x20 Hex Head Tapping	<b>NP0202</b> 6.0x12x0.2mm Washers
<b>BK2004</b> Diff Seal	<b>BK2022</b> Rear Lower Arms	<b>BK2043</b> Steering Tie-Rod	<b>BK2060</b> Servo Horns 25T	<b>BD3042</b> Body Pin	<b>BK2401</b> 6061 T6 Chassis Gold	<b>BK2413</b> Black Dish Tires	<b>BK3001</b> Carbon Fiber Front Shock Tower	<b>NP0083</b> M4 4mm Lock Nut	<b>NP0157</b> M3x25 Hex Head Tapping	<b>NP0203</b> 13x16x0.2mm Washers
<b>BK2005</b> Joint Cup	<b>BK2023</b> Steering Mount set	<b>BK2044</b> Dog Bone Center-F/R	<b>BK2061</b> Clutch Bell 15th	<b>BD3067</b> Clutch Spring	<b>BK2402</b> 6061 T6 Front Shock Tower Gold	<b>BK2414</b> 16mm Front Shock AI Gold	<b>BK3002</b> Carbon Fiber Rear Shock Tower	<b>NP0091</b> 5x10x4mm Ball Bearing	<b>NP0158</b> M4x12 Hex Head Tapping	<b>NP0205</b> 3x8x0.5mm Washers
<b>BK2006</b> Diff Outdrives	<b>BK2024</b> Steering Block Set	<b>BK2045</b> Wheel Axle	<b>BK2062</b> Shock Extension Nut	<b>BD3068</b> Body Pins (1.0mm)	<b>BK2403</b> 6061 T6 Rear Shock Tower Gold	<b>BK2415</b> 16mm Rear Shock AI Gold	<b>NP0001</b> Setscrew 3x3	<b>NP0093</b> 8x16x5mm Ball Bearing	<b>NP0159</b> M4x16 Hex Head Tapping	<b>NP0207</b> 3x7x0.6 E-clip
<b>BK2007</b> Center Outdrives	<b>BK2025</b> Steering Block Bushing	<b>BK2046</b> Splash Guards L/R	<b>BK2064</b> Steering Tie-Rod	<b>BD3092</b> Silicone Fuel Tube	<b>BK2404</b> Hinge Pins And Clips	<b>BK2416</b> Flashwheel Blue	<b>NP0002</b> Setscrew 3x12	<b>NP0108</b> 3.5x9x0.8mm Flat Washer	<b>NP0162</b> M3x8 Countersunk Hex Screw	<b>NP0208</b> 2.3x0.8 E-clip
<b>BK2008</b> Steel Diff Ring Gear	<b>BK2026</b> Upper Front Arms	<b>BK2047</b> Dog Bone Wheel	<b>BK2065</b> Radio Plate	<b>BD3093</b> Silicone Tube For Exhaust Pipe	<b>BK2405</b> Lower Suspension Mounts Gold	<b>BK2417</b> Front Lower Suspension Mounts 4 Gold	<b>NP0003</b> Setscrew 4x4	<b>NP0110</b> 3.6x12x0.2mm Flat Washer	<b>NP0166</b> M4x14 Countersunk Hex Screw	<b>NP0213</b> M2.5x12 Round Head Machine
<b>BK2009</b> Power Metalurgy Gear 40th	<b>BK2027</b> Upper Rear Tie-Rod	<b>BK2048</b> Steering Rack Post	<b>BK2066</b> Servo Horns 25T	<b>BD3094</b> Switch Cover	<b>BK2406</b> 17mm Hex Hub Blue	<b>BK2418</b> Front Lower Suspension Mounts 4 Gold	<b>NP0004</b> Setscrew 4x12	<b>NP0115</b> 5.1x9x0.5mm Flat Washer	<b>NP0172</b> Setscrew 5x4	<b>NP0219</b> M3x8 Hex Head Tapping
<b>BK2010</b> Steel Spur Gear 40th	<b>BK2028</b> Rear Drive Shaft	<b>BK2049</b> Wing Mount Posts L/R	<b>BK2067</b> Clutch Bell 15th	<b>BD3107</b> Dust Cover Set	<b>BK2407</b> Chassis Brace Gold	<b>BK2419</b> Rear Lower Suspension Mounts 4 Gold	<b>NP0005</b> Setscrew 5x5	<b>NP0132</b> 6x10x3 Ball Bearing	<b>NP0182</b> M4x10 Countersunk Hex Screw	<b>NP0229</b> Setscrew 2x10
<b>BK2012</b> Front Bumper	<b>BK2032</b> Front Brace And Front Body Mounts	<b>BK2050</b> Wing	<b>BK2068</b> Servo Horns 25T	<b>CH0006</b> Antenna Pipe	<b>BK2408</b> Steering Spring Set Blue	<b>BK2420</b> Rear Lower Suspension Mounts 4 Gold	<b>NP0015</b> M2.5x13 Round Head Tapping	<b>NP0147</b> M4 4mm Lock Nut	<b>NP0191</b> M3x10 Hex Head Tapping Screw	<b>NP0252</b> M3.5x16 Flat Head Tapping
<b>BK2015</b> Exhaust Bolt	<b>BK2034</b> Brake Caliper	<b>BK2052</b> Engine Mounts (for 28) Load Bar	<b>BK2069</b> Servo Horns 25T	<b>EA1003</b> Engine #21		<b>BK2421</b> Instruction Manual	<b>NP0017</b> M3x10 Round Head Tapping	<b>NP0148</b> M3x12 Hex Hex Head Machine		
<b>BK2018</b> Caster Block Bushing	<b>BK2035</b> Break Disk	<b>BK2053</b> Engine Mounts (for 28) Load Bar	<b>BK2070</b> Servo Horns 25T	<b>EA2001</b> Pull Start #1		<b>BK2422</b> Senkenschütz Blue	<b>NP0047</b> M3x10 Hex Hex Head Machine	<b>NP0149</b> M3x12 Hex Hex Head Machine		
	<b>BK2037</b> Rear Hub Carrier	<b>BK2054</b> 18 Racing Spike White Dish Tires	<b>BK2071</b> Servo Horns 25T	<b>ED2001</b> Pull Start #2		<b>BK2423</b> Throttle And Brake Linkage	<b>NP0048</b> M3x25 Hex Hex Head Machine	<b>NP0150</b> M3x12 Hex Hex Head Machine		
						<b>BK2424</b> Body Window Decal	<b>NP0053</b> M3x16 Hex Head Tapping			

## WARNINGS

•The product is not intended for those under 14 years of age without proper adult supervision. The product is not a toy. It is a precision machine requiring proper assembly and setup to avoid accidents and it is the responsibility of the owner to operate this product in a safe manner as it can cause serious personal injury and damage to property due to carelessness or misuse.  
•Do not attempt to disassemble or modify any of the product components without the assistance of an experienced RC user.  
•Only use the correct type of battery to operate. Using any wrong type of battery will damage the product and possibly make it dangerous to operate.  
•The motor(s) may get hot during use. Always allow 10-15 minutes between each operation for the motor to cool down. This will prolong the life of your product.  
•Choose an appropriate operating site consisting of flat, smooth ground, and clear open field. Do not operate near buildings, high voltage cable lines, or trees to ensure safety operation. Operate in safe area only, away from other people. RC models are prone to accidents, failures, and crashes due to a variety of reasons including, lack of maintenance, user error, and radio interference. Users are responsible for their actions and damage or injury occurring during the operation.  
•Do not operate in inclement weather, such as rain, wind, snow or darkness.  
•The product is composed of precision electrical components. It is critical to keep the product away from moisture and other contaminants. Do not allow them to get wet. Electrical damage may occur that could affect safe operation.  
•You should complete a successful pre-run check of your radio equipment and model prior to each run.

•After each use, always allow the battery to cool down before recharging. When charging the battery pack, do not overcharge! If batteries get hot during charging, discontinue charging immediately and disconnect the battery from the charger. Never leave battery unattended while charging. If you are unsure of how to charge this battery, please seek the advice of experienced RC users. Never let children charge the battery without adult supervision.  
•Always turn on the transmitter before connecting the battery on the model. When turning off the model, always disconnect the battery first, and then turn off the transmitter. If the order is reversed, the model may become uncontrollable and cause serious damage.  
•If you are in doubt of your ability to operate model, we strongly recommend that you seek assistance from experienced RC users or join your local modeling club to gain the required knowledge and skill. As the manufacturer and distributor, we assume no liability for the use of this product.  
•Before turning on your model and transmitter, please check to make sure no one else is operating under the same frequency. Frequency interference can cause your model, or other's models to crash. The guidance provided by experienced RC users will be valuable for the assembly, tuning, trimming, and actual first operating.  
•Never allow batteries to run low or you might lose control of the model.  
•Plastic is very susceptible to damage or deformation due to extreme heat and cold climate. Do not store the model near any source of heat such as oven or heater. Store the model indoors, in a climate-controlled, room temperature environment.