

6" Sloped Reflector Trim - EL616



Features

- Sloped Reflector.
- Lamp: 75W MAX PAR30 or 150W MAX PAR38.
- O.D.: 7 3/8" x 7 5/8".

Technical Details

Construction: Meticulously manufactured trim with a powder coated or anodized finish.

Installation: Clips securely mount trim into the housing and keeps ring flush with ceiling.

Compatible Housings: EL936ICA, EL918ICA, EL918RICA, EL900HT, EL900RT.

Lamp: Compatible with Medium base (E26) PAR type.

Options



All White Black w/White Ring Clear w/White Ring

Product Number

| Item | Description | Finish |
|---------|--------------------------------|--------------------|
| EL616KC | with Adjustable Socket Bracket | Clear w/White Ring |

Product Number Builder Example: EL616W

| | | |
|------------------------------------|---------------------------------------|---|
| 6" Sloped Reflector Trim | Socket Bracket | Finish |
| <input type="text" value="EL616"/> | <input type="text"/> | <input type="text"/> |
| | no Socket Bracket K Socket Bracket | W All White B Black w/White Ring C Clear w/White Ring |

Product Custom Image

Compatible Products

For use with **6" Sloped Trims**

6" E26 Base Sloped Ceiling Housings

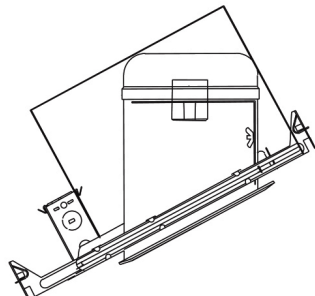

6" E26 Medium Base Sloped Housing
New Construction

| CAT NO. | SPECIFICATIONS |
|----------|----------------|
| EL936ICA | 90W Max. |

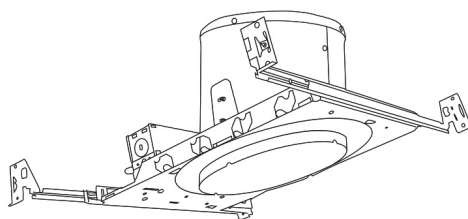

6" E26 Medium Base Sloped Housing
New Construction

| CAT NO. | SPECIFICATIONS |
|----------|----------------|
| EL918ICA | 75W Max. |

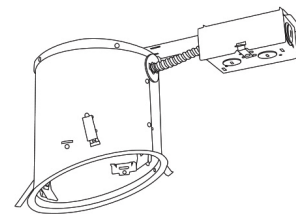

6" E26 Medium Base Sloped Housing
Remodel

| CAT NO. | SPECIFICATIONS |
|-----------|----------------|
| EL918RICA | 75W Max. |

6" E26 Base Sloped Ceiling Non-IC Housings

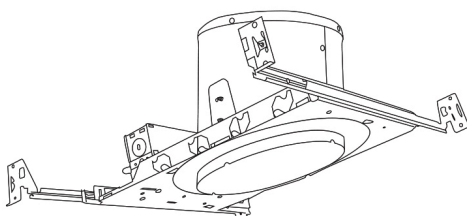

6" E26 Medium Base Sloped Housing
Remodel

| CAT NO. | SPECIFICATIONS |
|---------|----------------|
| EL900HT | 150W Max. |

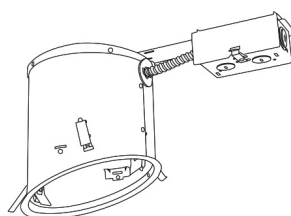

6" E26 Medium Base Sloped Housing
Remodel

| CAT NO. | SPECIFICATIONS |
|---------|----------------|
| EL900RT | 150W Max. |