

5" Sloped Ceiling LED Baffle Inserts

Sloped Ceiling LED inserts feature an integral gimbal for $\pm 25^\circ$ adjustability. Compatible with most incandescent and electronic low voltage dimmers.



Features

- 5" Sloped Ceiling LED Inserts feature an integral gimbal for $\pm 25^\circ$ tilt adjustability.
- Compatible with most incandescent and electronic low voltage dimmers.
- ENERGY STAR® Certified. California Title 24 (JA8-2016-E).
- Life Span: 50,000 hours L70.

Specifications

Wattage	15W
Lumens	1050 lm
Voltage	120V
Color Temp.	2700K, 3000K, 3500K, 4000K, 5000K
Dimmable	Triac/ELV
Lamp Type	LED
CRI	90+
Damp Location	Listed

Options



White

Black w/White Ring

Bronze

Technical Details

Optics: LED light engine has frosted polycarbonate lens with reflector to diffuse light evenly while reducing glare.

Construction: Deep baffle trim with torsion springs to be held into the housing. High quality powder coat finish preventing rust and paint cracking on metal parts. Integral gimbal allows for 25° adjustability to match slope.

Installation: Designed to install into ELCO 5" Sloped ceiling housing with torsion springs brackets. For retrofitting other manufacturers sloped ceiling cans always test the product to ensure proper fit and function.

Electrical:

- Driver connects to 120VAC power supply.
- High efficiency, high power factor > 0.9 driver.

LED Technology:

- Accurate color rendering with 90+ CRI.
- Lumen Maintenance of 50,000 hours L70 Life based on LM80 standardized test results.
- Superior Thermal Management by utilizing aluminum diecast heat sink.

Dimmability:

- Dimmable with most standard TRIAC and ELV type dimmers.
- Dimming range of 100% down to 10%. Dimming range may vary depending on dimmer model.
- For full list of dimmers refer to the Dimmer Compatibility List.

Listings:

- UL Listed for Damp Location.
- ENERGY STAR® Certified.
- California Title 24 (JA8-2016-E).

Dimensions

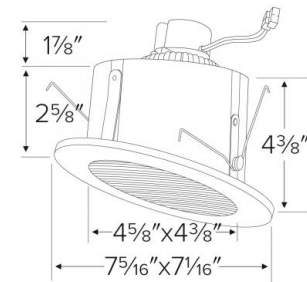

Product Numbers

Item	Lamp type	Lumens	CCT	Watts	Voltage	Dimming	Finish
EL511CT5W	LED	1050 lm	2700K, 3000K, 3500K, 4000K, 5000K	15W	120V	Triac/ELV	White
EL511CT5B	LED	1050 lm	2700K, 3000K, 3500K, 4000K, 5000K	15W	120V	Triac/ELV	Black w/White Ring
EL511CT5BZ	LED	1050 lm	2700K, 3000K, 3500K, 4000K, 5000K	15W	120V	Triac/ELV	Bronze

Product Number Builder Example: EL511CT5W

ELCO 5" Baffle Insert	Color Temp.	Finish
EL511	CT5 2700K - 5000K	W All White B Black w/White Ring BZ All Bronze

Compatible Products



For use with **5" LED Sloped Inserts**

5" Dedicated LED Sloped Ceiling IC Housings

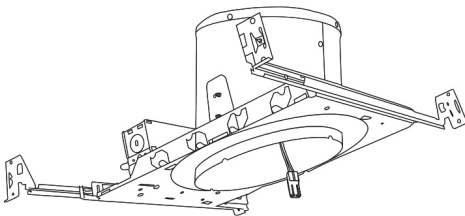

5" Dedicated LED Sloped Housing
New Construction

CAT NO.	SPECIFICATIONS
EL590ICA	24W Max.

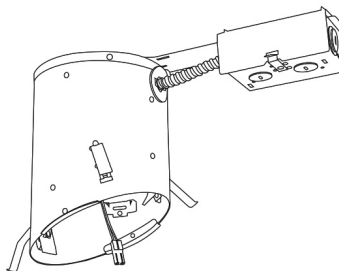

5" Dedicated LED Sloped Housing
Remodel

CAT NO.	SPECIFICATIONS
EL590RICA	24W Max.

5" E26 Base Sloped Ceiling Housings

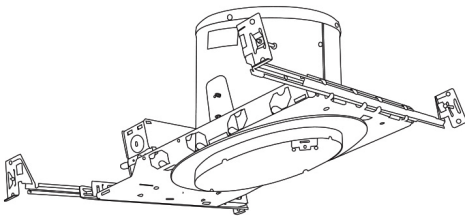

5" E26 Medium Base Sloped Housing
New Construction

CAT NO.	SPECIFICATIONS
EL518ICA	75W Max.

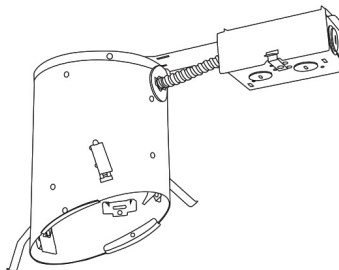

5" E26 Medium Base Sloped Housing
Remodel

CAT NO.	SPECIFICATIONS
EL518RICA	75W Max.



PSA30
Medium base to Ideal terminal connector

Sloped LED Baffle Insert

Multiplier: 2700K (x 0.96)

PHOTOMETRIC REPORT

Product #: EL51130
 Wattage/Lumens: 17.4W/ 1108 Lm
 Luminaire LPW: 64 Lm/W

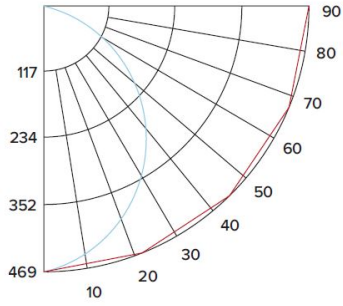

CANDLE POWER SUMMARY

Degrees Vertical	0°
0	469
5	467
15	451
25	420
35	366
45	281
55	176
65	87
75	36
85	9
90	1.6

ILLUMINANCE AT A DISTANCE

Distance to Target Plane	Footcandles Beam Center	Beam Diameter
4'	29.3	9.4'
6'	13.0	14.1'
8'	7.33	18.8'
10'	4.69	23.5'

ZONAL LUMEN SUMMARY

Zone	Lumens	% Luminaire
0-30°	365.43	33.00
0-40°	593.56	53.50
0-60°	967.13	87.20
0-90°	1104.15	99.60