

# 5" Sloped Ceiling LED Reflector Inserts

Sloped Ceiling LED inserts feature an integral gimbal for  $\pm 25^\circ$  adjustability. Compatible with most incandescent and electronic low voltage dimmers.



## Features

- 5" Sloped Ceiling LED Inserts feature an integral gimbal for  $\pm 25^\circ$  tilt adjustability.
- Compatible with most incandescent and electronic low voltage dimmers.
- ENERGY STAR® Certified. California Title 24 (JA8-2016-E).
- Life Span: 50,000 hours L70.

## Specifications

<b>Wattage</b>	15W
<b>Lumens</b>	1050 lm
<b>Voltage</b>	120V
<b>Color Temp.</b>	2700K - 3000K
<b>Dimmable</b>	Triac/ELV
<b>Lamp Type</b>	LED
<b>CRI</b>	90+
<b>Damp Location</b>	Listed

## Options



White



Clear/White Ring



Black/White Ring

## Technical Details

**Optics:** LED light engine has frosted polycarbonate lens with reflector to diffuse light evenly while reducing glare.

**Construction:** Deep reflector trim with torsion springs to be held into the housing. High quality powder coat finish preventing rust and paint cracking on metal parts. Integral gimbal allows for  $25^\circ$  adjustability to match slope.

**Installation:** Designed to install into ELCO 5" Sloped ceiling housing with torsion springs brackets. For retrofitting other manufacturers sloped ceiling cans always test the product to ensure proper fit and function.

### Electrical:

- Driver connects to 120VAC power supply.
- High efficiency, high power factor  $> 0.9$  driver.
- Ambient operating temperature  $-40^\circ\text{F}$  ( $-40^\circ\text{C}$ ) to  $104^\circ\text{F}$  ( $40^\circ\text{C}$ ).

### LED Technology:

- Accurate color rendering with 90+ CRI.
- Lumen Maintenance of 50,000 hours L70 Life based on LM80 standardized test results.
- Superior Thermal Management by utilizing aluminum diecast heat sink.

### Dimmability:

- Dimmable with most standard TRIAC and ELV type dimmers.
- Dimming range of 100% down to 10%. Dimming range may vary depending on dimmer model.
- For full list of dimmers refer to the Dimmer Compatibility List.

**Listings:** UL Listed for Damp Location. ENERGY STAR® Certified. California Title 24 (JA8-2016-E).

**Warranty:** ELCO Products are built to last. 5-year Limited warranty.

## Dimensions

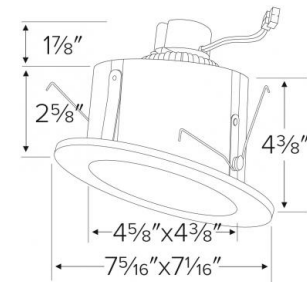

## Product Numbers

Item	Lamp type	Lumens	CCT	Watts	Voltage	Dimming	Finish
EL512CT5W	LED	1050 lm	2700K, 3000K, 3500K, 4000K, 5000K	15W	120V	Triac/ELV	White
EL51227C	LED	1050 lm	2700K	15W	120V	Triac/ELV	Clear w/White Ring
EL51230C	LED	1050 lm	3000K	15W	120V	Triac/ELV	Clear w/White Ring
EL512CT5C	LED	1050 lm	2700K, 3000K, 3500K, 4000K, 5000K	15W	120V	Triac/ELV	Clear w/White Ring

Item	Lamp type	Lumens	CCT	Watts	Voltage	Dimming	Finish
<b>EL512CT5B</b>	LED	1050 lm	2700K, 3000K, 3500K, 4000K, 5000K	15W	120V	Triac/ELV	Black w/White Ring

## Product Number Builder Example: EL512CT5W

ELCO 5" Reflector Insert	Color Temp.	Finish
<b>EL512</b>		
<b>27</b> 2700K <b>30</b> 3000K <b>CT5</b> 2700K - 5000K	<b>W</b> White <b>B</b> Black w/White Ring <b>C</b> Clear w/White Ring	

### Sloped LED Reflector Insert

Multiplier: 2700K (x 0.96)

#### PHOTOMETRIC REPORT

Product #: EL51230  
 Wattage/Lumens: 14.7W/ 1108 Lm  
 Luminaire LPW: 75 Lm/W

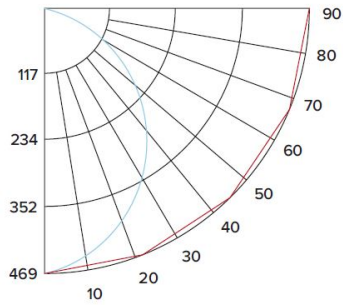

#### CANDLE POWER SUMMARY

Degrees Vertical	Candle Power
0°	469
5°	467
15°	451
25°	420
35°	366
45°	281
55°	176
65°	87
75°	36
85°	9
90°	1.6

#### ILLUMINANCE AT A DISTANCE

Distance to Target Plane	Footcandles Beam Center	Beam Diameter
4'	29.3	9.4'
6'	13.0	14.1'
8'	7.33	18.8'
10'	4.69	23.5'

#### ZONAL LUMEN SUMMARY

Zone	Lumens	% Luminaire
0-30°	365.43	33.00
0-40°	593.56	53.50
0-60°	967.13	87.20
0-90°	1104.15	99.60

# Compatible Products

For use with 5" LED Sloped Inserts

---

## 5" Dedicated LED Sloped Ceiling IC Housings

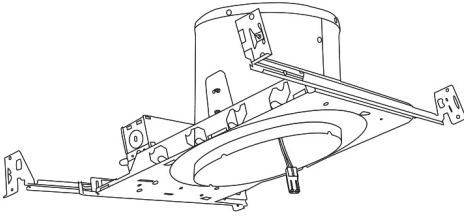

5" Dedicated LED Sloped Housing  
**New Construction**

CAT NO.	SPECIFICATIONS
EL590ICA	24W Max.

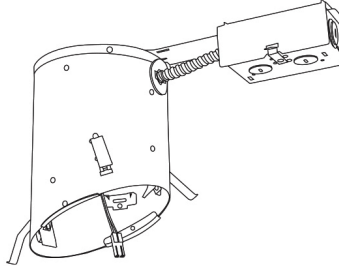

5" Dedicated LED Sloped Housing  
**Remodel**

CAT NO.	SPECIFICATIONS
EL590RICA	24W Max.

---

## 5" E26 Base Sloped Ceiling Housings

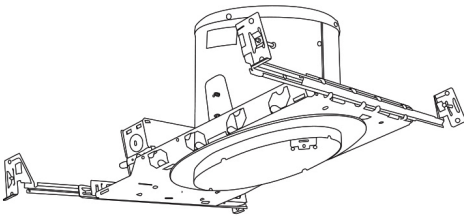

5" E26 Medium Base Sloped Housing  
**New Construction**

CAT NO.	SPECIFICATIONS
EL518ICA	75W Max.

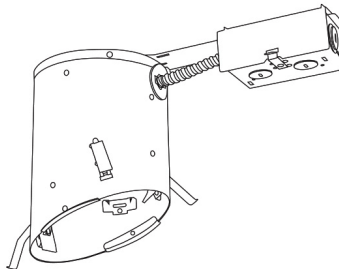

5" E26 Medium Base Sloped Housing  
**Remodel**

CAT NO.	SPECIFICATIONS
EL518RICA	75W Max.

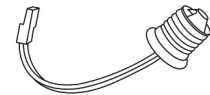

**PSA30**  
Medium base to Ideal terminal connector