

6" Sloped Ceiling LED Baffle Insert

Sloped Ceiling LED inserts feature an integral gimbal for $\pm 25^\circ$ adjustability. Compatible with most incandescent and electronic low voltage dimmers.



Features

- Sloped Ceiling LED Inserts feature an integral gimbal for $\pm 25^\circ$ adjustability.
- Compatible with most incandescent and electronic low voltage dimmers.
- ENERGY STAR® Certified. California Title 24 (JA8-2016-E).
- Life Span: 50,000 hours L70.

Specifications

Wattage	15W - 18W
Lumens	1050 lm - 1200 lm
Voltage	120V
Color Temp.	2700K - 3000K
Dimmable	Triac/ELV
Lamp Type	LED
CRI	90+
Damp Location	Listed

Options



White

Black w/White Ring

Bronze

Technical Details

Optics: LED light engine has frosted polycarbonate lens with reflector to diffuse light evenly throughout while reducing glare.

Construction: Deep phenolic baffle trim with torsion springs to be held into the housing. High quality powder coat finish preventing rust and paint cracking on metal parts. Integral gimbal allows for 25° adjustability to match slope.

Installation: Designed to install into ELCO 6" Sloped ceiling housing with torsion springs brackets. For retrofitting other manufacturers sloped ceiling cans always test the product to ensure proper fit and function.

Electrical:

- Driver connects to 120VAC power supply.
- High efficiency, high power factor > 0.9 driver.

LED Technology:

- Accurate color rendering with 90+ CRI.
- Lumen Maintenance of 50,000 hours L70 Life based on LM80 standardized test results.
- Superior Thermal Management by utilizing aluminum diecast heat sink.

Housings: Compatible with EL970ICA, EL970RICA.

Dimmability:

- Dimmable with most standard TRIAC and ELV type dimmers.
- Dimming range of 100% down to 10%. Dimming range may vary depending on dimmer model.
- For full list of dimmers refer to the Dimmer Compatibility List.

Listings:

- UL Listed for Damp Location.
- ENERGY STAR® Certified.
- California Title 24 (JA8-2016-E).

Dimensions

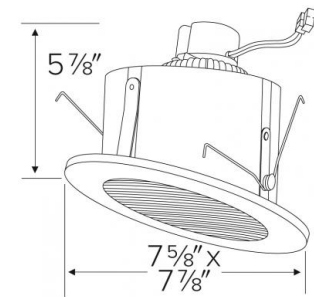

Product Numbers

Item	Lamp type	Lumens	CCT	Watts	Voltage	Dimming	Finish
EL71327B	LED	1050 lm	2700K	15W	120V	Triac/ELV	Black w/White Ring
EL71330B	LED	1050 lm	3000K	15W	120V	Triac/ELV	Black w/White Ring
EL713CT5B	LED	1050 lm	2700K, 3000K, 3500K, 4000K, 5000K	15W	120V	Triac/ELV	Black w/White Ring
EL71427B	LED	1200 lm	2700K	18W	120V	Triac/ELV	Black w/White Ring
EL71430B	LED	1200 lm	3000K	18W	120V	Triac/ELV	Black w/White Ring

Warranty: ELCO Products are built to last. 5-year Limited warranty.

Item	Lamp type	Lumens	CCT	Watts	Voltage	Dimming	Finish
EL714CT5B	LED	1200 lm	2700K, 3000K, 3500K, 4000K, 5000K	18W	120V	Triac/ELV	Black w/White Ring
EL71327BZ	LED	1050 lm	2700K	15W	120V	Triac/ELV	Bronze
EL71330BZ	LED	1050 lm	3000K	15W	120V	Triac/ELV	Bronze
EL713CT5BZ	LED	1050 lm	2700K, 3000K, 3500K, 4000K, 5000K	15W	120V	Triac/ELV	Bronze
EL71427BZ	LED	1200 lm	2700K	18W	120V	Triac/ELV	Bronze
EL71430BZ	LED	1200 lm	3000K	18W	120V	Triac/ELV	Bronze
EL714CT5BZ	LED	1200 lm	2700K, 3000K, 3500K, 4000K, 5000K	18W	120V	Triac/ELV	Bronze
EL71327W	LED	1050 lm	2700K	15W	120V	Triac/ELV	White
EL71330W	LED	1050 lm	3000K	15W	120V	Triac/ELV	White
EL713CT5W	LED	1050 lm	2700K, 3000K, 3500K, 4000K, 5000K	15W	120V	Triac/ELV	White
EL71427W	LED	1200 lm	2700K	18W	120V	Triac/ELV	White
EL71430W	LED	1200 lm	3000K	18W	120V	Triac/ELV	White
EL714CT5W	LED	1200 lm	2700K, 3000K, 3500K, 4000K, 5000K	18W	120V	Triac/ELV	White

Product Number Builder Example: EL71327B

ELCO 6" Sloped Ceiling LED Inserts	Wattage	Color Temp.	Finish
EL71			
	3 15W 4 18W	27 2700K 30 3000K CT5 2700K - 5000K	W White B Black BZ Bronze

Compatible Products

For use with 6" LED Sloped Inserts

6" Dedicated LED Sloped Ceiling IC Housings

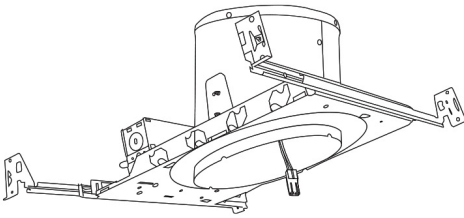

6" LED Sloped Housing
New Construction

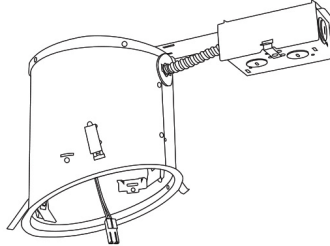

6" LED Sloped Housing
Remodel

CAT NO.	SPECIFICATIONS
EL970ICA	24W Max.

CAT NO.	SPECIFICATIONS
EL970RICA	24W Max.

6" E26 Base Sloped Ceiling Housings

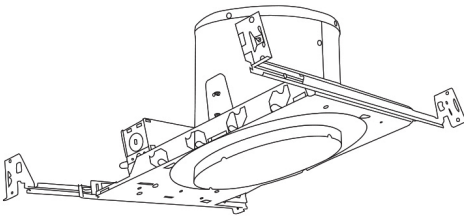

6" E26 Medium Base Sloped Housing
New Construction

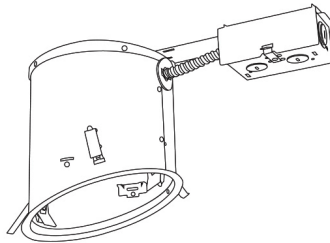

6" E26 Medium Base Sloped Housing
Remodel

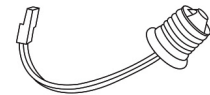

PSA30
Medium base to ideal terminal connector

CAT NO.	SPECIFICATIONS
EL918ICA	75W Max.

CAT NO.	SPECIFICATIONS
EL918RICA	75W Max.

Sloped Ceiling LED Baffle Insert

Multiplier: 2700K (x 0.96)

PHOTOMETRIC REPORT

Product #: EL71430
 Wattage/Lumens: 17.2W/ 1210 Lm
 Luminaire LPW: 70 Lm/W

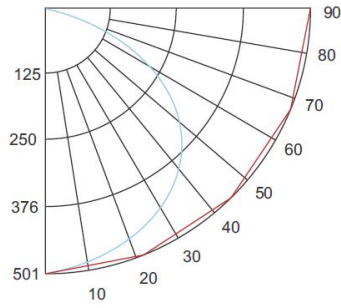

CANDLE POWER SUMMARY

Degrees Vertical	Candle Power
0°	494
5	500
15	495
25	469
35	425
45	362
55	273
65	155
75	50
85	19
90	9

ILLUMINANCE AT A DISTANCE

Distance to Target Plane	Footcandles Beam Center	Beam Diameter
4'	30.9	10.0'
6'	13.7	15.0'
8'	7.73	20.0'
10'	4.95	25.0'

ZONAL LUMEN SUMMARY

Zone	Lumens	% Luminaire
0-30°	384.64	31.80
0-40°	628.94	52.00
0-60°	1061.54	87.80
0-90°	1205.84	99.70