



## ALED52™ Series INSTALLATION INSTRUCTIONS



ALED52  
Standard (15 Deg)



ALEDC52  
Cutoff (7.5 Deg)



ALEDFC52  
Full Cutoff (0 Deg)

Thank you for buying RAB lighting fixtures. Our goal is to design the best quality products to get the job done right. We'd like to hear your comments. Call the us at 888- RAB-1000, or email: [marketing@rabweb.com](mailto:marketing@rabweb.com)

### IMPORTANT

**READ CAREFULLY BEFORE INSTALLING FIXTURE. RETAIN THESE INSTRUCTIONS FOR FUTURE REFERENCE.**

RAB fixtures must be wired in accordance with the National Electrical Code and all applicable local codes. Proper grounding is required for safety. THIS PRODUCT MUST BE INSTALLED IN ACCORDANCE WITH THE APPLICABLE INSTALLATION CODE BY A PERSON FAMILIAR WITH THE CONSTRUCTION AND OPERATION OF THE PRODUCT.

**WARNING: Make certain power is OFF before installing or maintaining fixture. No user serviceable parts inside.**

### MOUNTING ALED52 TO POLE

Mount directly to 4" or larger square steel pole. Do not separate **Pole Arm** from **Housing**.

1. Remove **Pole Arm Cover Plate** by loosening two screws.
2. Place **Pole Gasket** between the **Pole Arm** and drilled **Pole** as shown. Line up center hole with center hole in the pole drilling pattern.
3. Insert 3/8-16 x 1 1/4" **Bolts** from the **Pole Arm** thru the top hole of the **Pole** and thread into the **Bolster Plate**. Longer 2 1/4" bolts provided for use with round pole and round pole adaptor. For PAD4 applications use **bolts, nuts, lockwashers** and washers and tighten inside the PAD4. Do not use **bolster plate**.
4. Knot wires in pole for strain relief and feed wires from the pole into the **Pole Arm**. Make the necessary wiring connections in the **Pole Arm**.
5. Install the **Arm Gasket** on to the **Pole Arm Cover Plate** and secure it with the screws. Cover the screws with provided caps. Install the **Pole Cap**.

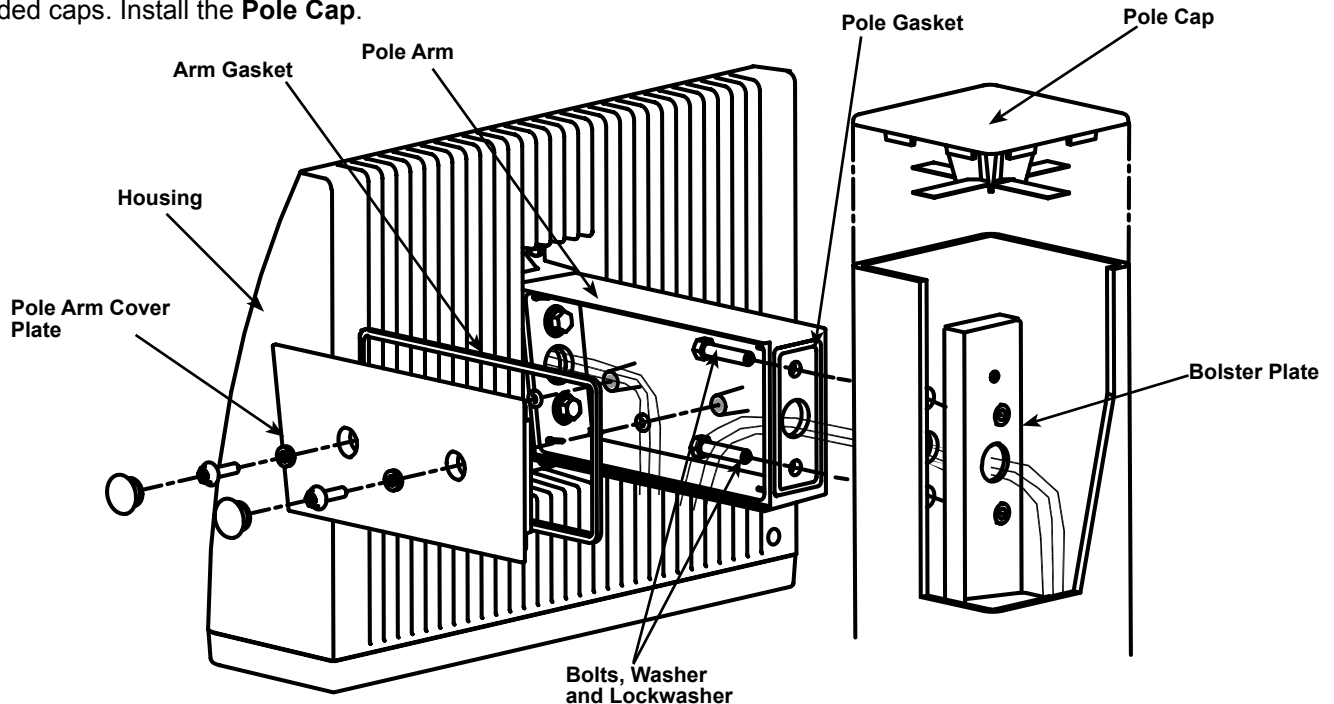

## ALED52™ Series INSTALLATION INSTRUCTIONS

### WIRING

Universal voltage driver permits operation at 120V to 277VAC, 50 or 60 Hz except fixtures factory ordered with a 120V photocell (/PC)

1. Connect the black fixture lead to the (+) LINE supply lead.
2. Connect the white fixture lead to the (-) COMMON supply lead.
3. Connect the bare copper Ground wire from fixture to supply ground.

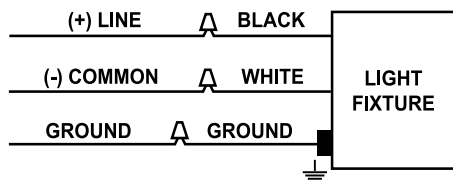

### CLEANING & MAINTENANCE

**CAUTION:** Be sure fixture temperature is cool enough to touch. Do not clean or maintain while fixture is energized.

1. Clean glass lens with non-abrasive glass cleaning solution.
2. Do not open the fixture to clean the LED. Do not touch the LED.

### TROUBLESHOOTING

1. Check that the line voltage at the fixture is correct. Refer to wiring directions.
2. Is the fixture is grounded properly?
3. Is the photocell, if used, functioning properly.

### Pole Drilling Detail

For non-RAB poles use these dimensions to drill the pole. This template is not to scale. Please use measurements shown.

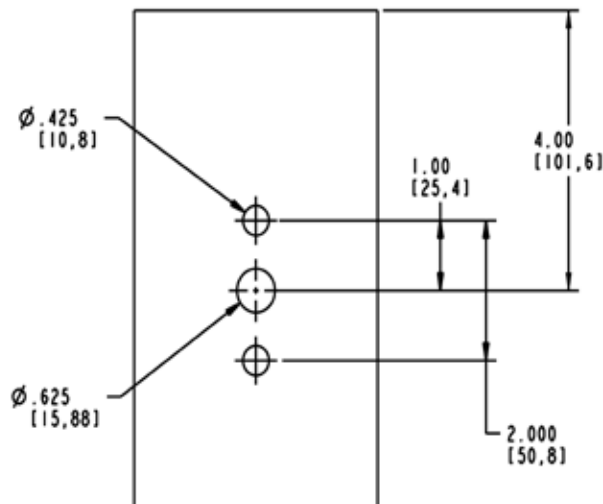

## ALED52™ Series INSTALLATION INSTRUCTIONS

### ALED52

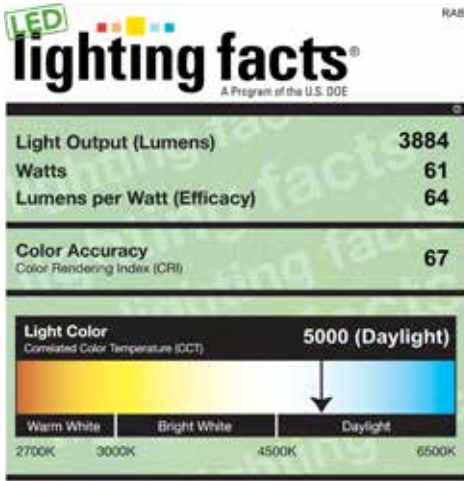

All results are according to IESNA LM-79-2008: Approved Method for the Electrical and Photometric Testing of Solid-State Lighting. The U.S. Department of Energy (DOE) verifies product test data and results.

Visit [www.lightingfacts.com](http://www.lightingfacts.com) for the Label Reference Guide.

Registration Number: WVMA-MWSZNA (3/29/2012)  
Model Number: ALED52 Upgraded 03/2012  
Type: Outdoor area/roadway fixture

### ALEDC52

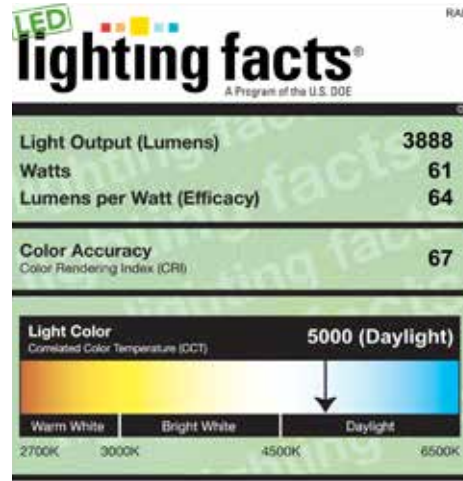

All results are according to IESNA LM-79-2008: Approved Method for the Electrical and Photometric Testing of Solid-State Lighting. The U.S. Department of Energy (DOE) verifies product test data and results.

Visit [www.lightingfacts.com](http://www.lightingfacts.com) for the Label Reference Guide.

Registration Number: WVMA-XEEBLT (3/29/2012)  
Model Number: ALEDC52 Upgraded 3/2012  
Type: Outdoor area/roadway fixture

### ALED52FC52

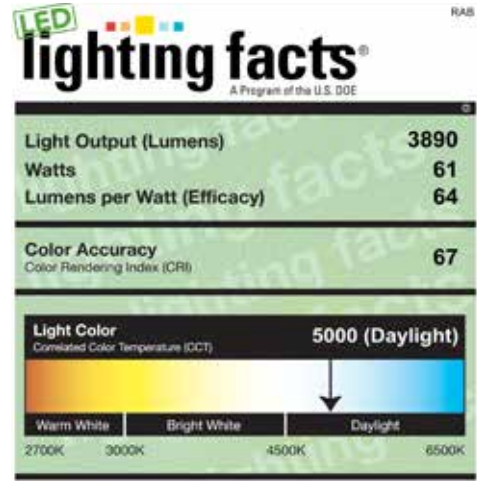

All results are according to IESNA LM-79-2008: Approved Method for the Electrical and Photometric Testing of Solid-State Lighting. The U.S. Department of Energy (DOE) verifies product test data and results.

Visit [www.lightingfacts.com](http://www.lightingfacts.com) for the Label Reference Guide.

Registration Number: WVMA-4JFPD6 (3/29/2012)  
Model Number: ALED52FC52 Upgraded 03/2012  
Type: Outdoor area/roadway fixture

### ALED52N



All results are according to IESNA LM-79-2008: Approved Method for the Electrical and Photometric Testing of Solid-State Lighting. The U.S. Department of Energy (DOE) verifies product test data and results.

Visit [www.lightingfacts.com](http://www.lightingfacts.com) for the Label Reference Guide.

Registration Number: WVMA-ABA1W8H (5/3/2012)  
Model Number: ALED52N Upgraded 4/2012  
Type: Outdoor area/roadway fixture

### ALEDC52N



All results are according to IESNA LM-79-2008: Approved Method for the Electrical and Photometric Testing of Solid-State Lighting. The U.S. Department of Energy (DOE) verifies product test data and results.

Visit [www.lightingfacts.com](http://www.lightingfacts.com) for the Label Reference Guide.

Registration Number: WVMA-BCSTT2 (5/3/2012)  
Model Number: ALEDC52N Upgraded 4/2012  
Type: Outdoor area/roadway fixture

### ALED52FC52N



All results are according to IESNA LM-79-2008: Approved Method for the Electrical and Photometric Testing of Solid-State Lighting. The U.S. Department of Energy (DOE) verifies product test data and results.

Visit [www.lightingfacts.com](http://www.lightingfacts.com) for the Label Reference Guide.

Registration Number: WVMA-FHX8B (5/3/2012)  
Model Number: ALED52FC52N Upgraded 4/2012  
Type: Outdoor area/roadway fixture