



Westinghouse



**Durable,  
Dependable and  
Adaptable**

*Our complete line of patented support boxes and braces are quick and easy to install.*

*Solid support,  
Quality materials,  
Great value.*

*Contractors and homeowners trust sturdy  
Westinghouse braces to protect their  
fan and lighting investments.  
For new construction or remodel,  
we have the products to secure any job.*



Installation is a breeze!

## Saf-T-Bar®

Ideal for New Construction or  
Where Attic is Accessible

- Easy 4-step installation
- Position box anywhere along the brace

*Can be used with Engineered Truss*

01525 & 0152511

**Saf-T-Bar®**

6 Knockouts for Conduit or Romex

1 Romex Connector

Box Depth 1½"

Heavy Duty, 15.5 Cubic Inch Dual Mount\* Electrical Box

### Engineered Truss Application



\*Dual Mount = Box is threaded for 8-32 (ideal for box covers and light weight fixtures) and 10-24 screws (ideal for heavier fixtures and fans).

Ideal for Retrofit Application  
No Attic Access Required

- Position box anywhere along the brace

# Saf-T-Brace®

Patented Design on 01010, 01100 and 01400  
Provides Fast, Fingertip Expansion and Positive Attachment to Joists

## Additional Security from Screw Connector

**01010**  
**Saf-T-Brace®**  
6 Knockouts for Conduit or Romex  
1 Romex Connector  
Box Depth 1½"  
Heavy Duty, 15.5 Cubic Inch Dual Mount\* Electrical Box  
**Extra Strong Grip**



### Step 1

Easy installation from below ceiling through any 4" diameter hole.

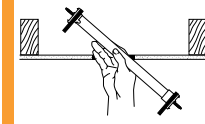

### Step 2

Install end "A" by turning unit clockwise and applying pressure toward the ceiling joist.

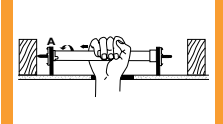

### Step 3

Slide unit toward other joist and again apply clockwise pressure.

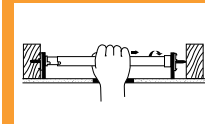

### Step 4

Attach electrical box and install fan or lighting fixture per manufacturer's instructions.

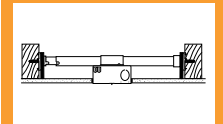

Installation Steps for 01010

## Teeth Twist and Lock into Joist to Create More Secure Connection

**01100**  
**Saf-T-Brace®**  
6 Knockouts for Conduit or Romex  
1 Romex Connector  
Box Depth 1½"  
Heavy Duty, 15.5 Cubic Inch Dual Mount\* Electrical Box  
**Strong Grip**



### Step 1

Easy installation from below ceiling through any 4" diameter hole.

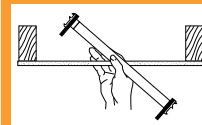

### Step 2

Rotate bar until teeth are fully embedded into joist.

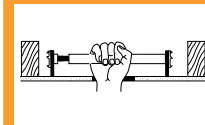

### Step 3

Attach electrical box and install fan or lighting fixture per manufacturer's instructions.

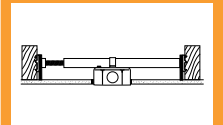

Installation Steps for 01100 and 01400

## Includes Larger Box for Increased Wire Capacity

**01400**  
**Saf-T-Brace®**  
6 Knockouts for Conduit or Romex  
1 Romex Connector  
**Box Depth 2⅛"**  
Heavy Duty, 21.5 Cubic Inch Dual Mount\* Electrical Box  
**Strong Grip**

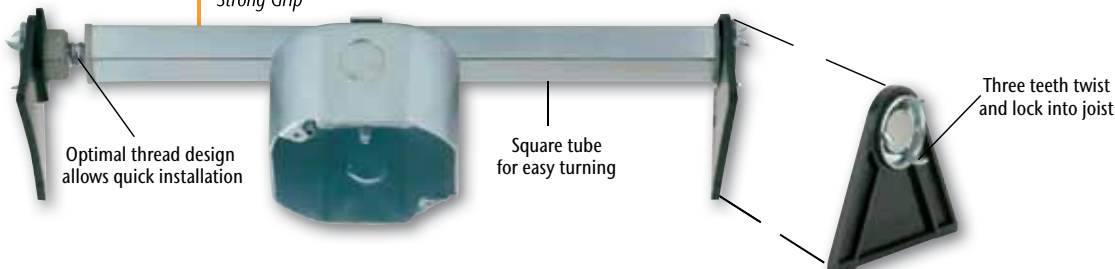

\*Dual Mount = Box is threaded for 8-32 (ideal for box covers and light weight fixtures) and 10-24 screws (ideal for heavier fixtures and fans).

# Saf-T-Grid®

Safely Installs Fans and Fixtures in Suspended Ceiling Applications

- Reduce ceiling vibration and provide safe secure installation
- Fits 2' x 2' and 2' x 4' ceiling tile gridwork
- Position box anywhere along the brace

All weight is carried by building structure, not by gridwork

Turnbuckle for easy height adjustment

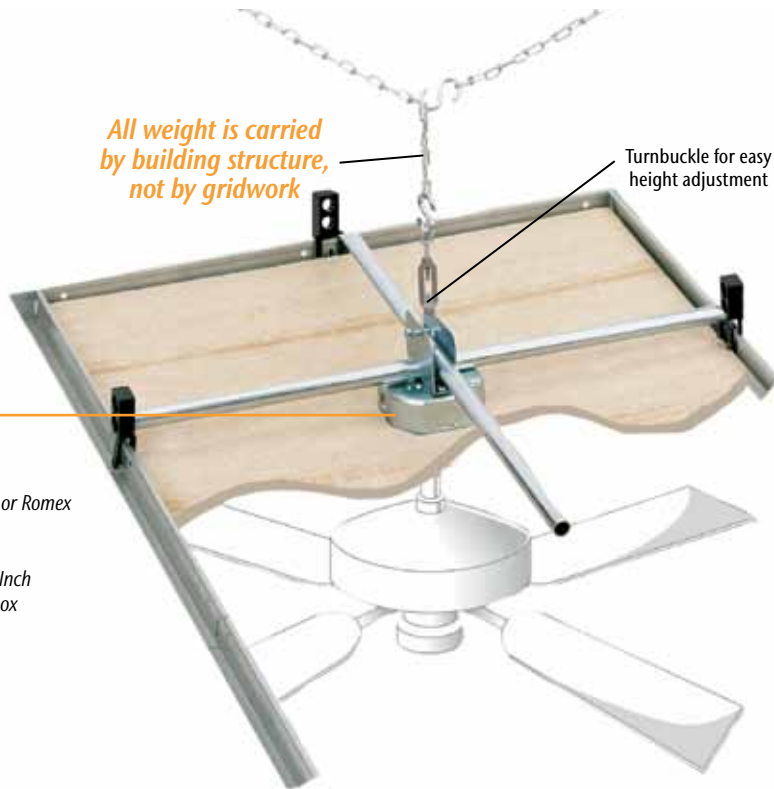

01070

## Saf-T-Grid®

6 Knockouts for Conduit or Romex  
 1 Romex Connector  
 Box Depth 1½"  
 Heavy Duty, 15.5 Cubic Inch  
 Dual Mount\* Electrical Box

\*Dual Mount = Box is threaded for 8-32 (ideal for box covers and light weight fixtures) and 10-24 screws (ideal for heavier fixtures and fans).

# HERCULES™

Heavy-Duty Chandelier & Fixture Brace

For New Construction or for Applications Where Attic is Accessible

- Adjustable for all size ceiling joists
- Can be installed easily in upper attic space
- Includes certificate of installation for building inspectors
- UL listed for fixture support of 800 lbs. or less
- Developed by a licensed contractor to provide a safe and fast way to install heavy chandeliers and fixtures

Pre-assembled adjustable mounting brackets



01800

## Heavy Chandelier and Fixture Brace

8 Knockouts for Conduit or Romex  
 Box Depth 2½"  
 21.5 Cubic Inch Electrical Box



# Saf-T-Box®

Heavy Duty Support for New Construction or  
for Applications Where Attic is Accessible



## 01020 & 0102011

### Saf-T-Box®

3 Knockouts for Conduit or Romex

2 Romex Clamps

Box Depth 1½"

Heavy Duty, 15.5 Cubic Inch Electrical Box

10-24 Threads for Fixtures and Fans



## 01050 & 0105011

### Saf-T-Box®

**3 Knockouts for  
Conduit or Romex**

2 Romex Clamps

Box Depth 1½"

Heavy Duty, 15.5 Cubic Inch

Dual Mount\* Electrical Box

## 0104011

### Saf-T-Box®

3 Knockouts for Conduit or Romex

2 Romex Clamps

**Box Depth 2⅛"**

Heavy Duty, 21.5 Cubic Inch

Dual Mount\* Electrical Box



## 0105211

### Saf-T-Box®

**6 Knockouts for  
Conduit or Romex**

1 Romex Connector

Box Depth 1½"

Heavy Duty, 15.5 Cubic Inch

Dual Mount\* Electrical Box

\*Dual Mount = Box is threaded for 8-32 (ideal for box covers and light weight fixtures) and 10-24 screws (ideal for heavier fixtures and fans).



# Engineered Simplicity

## Sidemount Plus Fan Box®

Ideal for Remodel Applications

- Sidemount bracket is removable for easy replacement of existing nail-on boxes without attic access



01240 & 0124011  
**Sidemount Plus Fan Box®**  
 3 Knockouts for Conduit or Romex  
 2 Romex Clamps  
**Box Depth 2 1/8"**  
 Heavy Duty, 21.5 Cubic Inch Dual Mount\* Electrical Box

Easy to Install through 4" Hole in Sheetrock

**Step 1**

Mount bracket to joist through 4" hole in sheetrock.

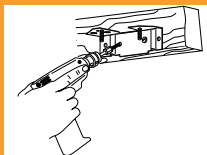

**Step 2**

Pull wire into box and remount box to bracket.

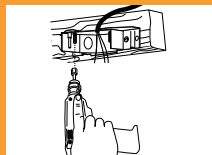

01250 & 0125011  
**Sidemount Plus Fan Box®**  
 3 Knockouts for Conduit or Romex  
 2 Romex Clamps  
**Box Depth 1 1/2"**  
 Heavy Duty, 15.5 Cubic Inch Dual Mount\* Electrical Box

\*Dual Mount = Box is threaded for 8-32 (ideal for box covers and light weight fixtures) and 10-24 screws (ideal for heavier fixtures and fans).

# Saf-T-Pan®

Ideal for New Construction  
or Remodel Applications



01030 & 0103011  
Saf-T-Pan®

**Box Depth 5/8"**  
2 Knockouts for Conduit or Romex  
1 Romex Connector  
Heavy Duty, 8 Cubic Inch  
Dual Mount\* Electrical Pan



01036 & 0103611  
Saf-T-Pan®

**Box Depth 1/2"**  
5 Knockouts for Conduit or Romex  
1 Romex Connector  
Heavy Duty, 6 Cubic Inch Dual Mount\* Electrical Pan



0252511  
Fan Master Jr.®  
Height 4"  
Box Depth 1/2"  
13.4 Cubic Inch  
Wiring Capacity

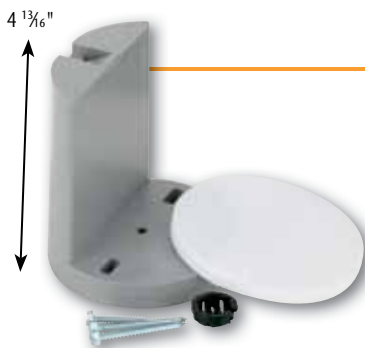

0200011  
Fan Master®  
Height 4 13/16"  
Box Depth 5/8"  
16.5 Cubic Inch  
Wiring Capacity

## Fan Master Jr.® & Fan Master®

Get the Wiring Space You Need...  
Where You Need It!

- Fits all ceiling fans
- 2 knockouts for conduit or Romex
- 1 Romex clamp
- 1 Romex connector
- Two hour fire rating



\*Dual Mount = Box is threaded for 8-32 (ideal for box covers and light weight fixtures) and 10-24 screws (ideal for heavier fixtures and fans).

## Specifications for Support Boxes and Braces

Item #	New Construction	Remodel	Electrical Box Depth	Electrical Box Volume (Cubic Inches)	# of 1/2" Romex or conduit knock-outs	Pack Type (Individual or Bulk)	Feature	Dual Mount *	Max Load Fan/Fixture 16" on Center	Max Load Fan/Fixture 24" on Center
<b>Sidemount Plus Fan Box®</b>										
01240	X	X	2 1/8"	21.5	3	Individual	Removable Side Mount Bracket Includes 2 Sets of Romex Knockouts and Integral Romex Clamps	Y	70/70 lbs.	70/70 lbs.
0124011	X	X	2 1/8"	21.5	3	Bulk	Removable Side Mount Bracket Includes 2 Sets of Romex Knockouts and Integral Romex Clamps	Y	70/70 lbs.	70/70 lbs.
01250	X	X	1 1/2"	15.5	3	Individual	Removable Side Mount Bracket Includes 2 Sets of Romex Knockouts and Integral Romex Clamps	Y	70/70 lbs.	70/70 lbs.
0125011	X	X	1 1/2"	15.5	3	Bulk	Removable Side Mount Bracket Includes 2 Sets of Romex Knockouts and Integral Romex Clamps	Y	70/70 lbs.	70/70 lbs.
<b>Saf-T-Pan®</b>										
01030	X	X	5/8"	8	2	Individual	Includes 1 Romex Connector	Y	70/150 lbs.	70/150 lbs.
0103011	X	X	5/8"	8	2	Bulk	Includes 1 Romex Connector	Y	70/150 lbs.	70/150 lbs.
01036	X	X	1/2"	6	5	Individual	Includes 1 Romex Connector	Y	70/150 lbs.	70/150 lbs.
0103611	X	X	1/2"	6	5	Bulk	Includes 1 Romex Connector	Y	70/150 lbs.	70/150 lbs.
<b>Saf-T-Grid®</b>										
01070	-	-	1 1/2"	15.5	6	Individual	For Suspended Ceilings	Y	50/50 lbs.	50/50 lbs.
<b>Hercules™</b>										
01800	X	**	2 1/8"	21.5	8	Individual	For Fixture Supports Up to 800 lbs.	N	800 lbs.	800 lbs.
<b>Fan Master Jr®/Fan Master®</b>										
0252511	X	-	1/2"	13.4	2	Bulk	Includes 1 Integral Romex Clamp and 1 Plastic Romex Connector 2 Hour Fire Rating	N	70/150 lbs.	70/150 lbs.
0200011	X	-	5/8"	16.5	2	Bulk	Includes 1 Integral Romex Clamp and 1 Plastic Romex Connector 2 Hour Fire Rating	N	70/150 lbs.	70/150 lbs.
<b>Saf-T-Brace®</b>										
01010	X	X	1 1/2"	15.5	6	Individual	4 Teeth & Single Screw - Extra Strong Grip Includes 1 Plastic Romex Connector	Y	70/150 lbs.	70/50 lbs.
01100	X	X	1 1/2"	15.5	6	Individual	3 Teeth - Strong Grip Includes 1 Plastic Romex Connector	Y	70/150 lbs.	70/50 lbs.
01400	X	X	2 1/8"	21.5	6	Individual	3 Teeth - Strong Grip Includes 1 Plastic Romex Connector	Y	70/150 lbs.	70/50 lbs.
<b>Saf-T-Bar®</b>										
01525	X	**	1 1/2"	15.5	6	Individual	Can be used with engineered trusses Includes 1 Plastic Romex Connector	Y	70/150 lbs.	70/90 lbs.
0152511	X	**	1 1/2"	15.5	6	Bulk	Can be used with engineered trusses Includes 1 Plastic Romex Connector	Y	70/150 lbs.	70/90 lbs.
<b>Saf-T-Box®</b>										
01020	X	**	1 1/2"	15.5	3	Individual	Includes 2 Sets of Romex Knockouts and Integral Romex Clamps	N	70/150 lbs.	70/150 lbs.
0102011	X	**	1 1/2"	15.5	3	Bulk	Includes 2 Sets of Romex Knockouts and Integral Romex Clamps	N	70/150 lbs.	70/150 lbs.
01050	X	**	1 1/2"	15.5	3	Individual	Includes 2 Sets of Romex Knockouts and Integral Romex Clamps	Y	70/150 lbs.	70/150 lbs.
0105011	X	**	1 1/2"	15.5	3	Bulk	Includes 2 Sets of Romex Knockouts and Integral Romex Clamps	Y	70/150 lbs.	70/150 lbs.
0104011	X	**	2 1/8"	21.5	3	Bulk	Includes 2 Sets of Romex Knockouts and Integral Romex Clamps	Y	70/150 lbs.	70/150 lbs.
0105211	X	**	1 1/2"	15.5	6	Bulk	Includes 1 Plastic Romex Connector	Y	70/150 lbs.	70/150 lbs.

### Mounting Hardware and Instructions included on all items.

\* Dual Mount = Box is threaded for 8-32 (ideal for box covers and light weight fixtures) and 10-24 screws (ideal for heavier fixtures and fans).

\*\* Requires Accessible Attic

Patented Technology US Patent Nos 4,909,405, 306,254, 5,860,548, 5,720,461, 5,435,514, 5,762,223, 6,465,731,B1

Meets or exceeds UL standards regarding exposed threads within box. Meets or exceeds NEC® safety codes.

Romex® is a registered trademark of Southwire Company.



Call 1-800-999-2226 or visit [www.westinghouselighting.com](http://www.westinghouselighting.com)

Westinghouse Lighting Corporation, Philadelphia, PA 19154-1029, U.S.A. Westinghouse Lighting Corporation, a Westinghouse Electric Corporation licensee

Ⓜ "Westinghouse" and "You can be sure...if it's Westinghouse" are all registered trademarks of Westinghouse Electric Corporation.

