

NTE-855

Jason Round LED Track Head

Source: 18W to 38W LED
1400lm to 2800lm

Type

Project

Catalog No.

Notes

PRODUCT DESCRIPTION

Small scale, LED Cylinder Track Fixture delivering up to 2800 lumens. Constructed of extruded and machined aluminum, the heat-sink and integrated driver housing provide a sleek and modern look, designed to quietly compliment any space. Dimming is standard and allows smooth illumination down to 10% precision adjustment. 315° aiming horizontal rotation, 90° vertical rotation. Integral on/off switch and track polarity indicator are standard.

FEATURES

- 1400lm, 2200lm or 2800lm LED packages
- 3000K, 3500K or 4000K @ 80 or 90 CRI
- Available in spot, narrow flood or flood beam spread
- Integral dimmable driver
- Die-cast aluminum construction with deep set COB optics
- Lens holder accommodates one accessory
- Clear glass lens included

CONSTRUCTION

Housing: Die-cast aluminum construction dissipates heat for longer life.

Optics: Molded TIR Optic engineered to provide a smooth uniform beam, maximizing output and minimizing glare. Available in spot, medium or flood beam spreads.

Adjustability: 315° horizontal and 90° vertical adjustment

ELECTRICAL

Input Voltage: 120V

Lumens / Wattage: 18 = 1400lm / 18W; 26 = 2200lm / 26W; 33 = 2800lm / 38W

Binning: 2-Step MacAdam (2 SDCM)

Color Temperature: 3000K, 3500K or 4000K

Color Rendering Index: 80 (While Supplies Last) or 90 CRI

Beam Spread: 24° Spot, 40° narrow flood or 60° flood

Dimming: Triac or ELV

[Click Here](#) or check complete dimmer list at www.NoraLighting.com in the "Compatibility" page under "Resources" tab

Accessories: Luminaire will accommodate (1) glass or louver and (1) barn door or snoot, no accessory holder is required.

LABELS AND LISTINGS

- cULus Listed for dry locations
- [5-Year Limited Warranty](#)



PRODUCT IMAGES & DIMENSIONS

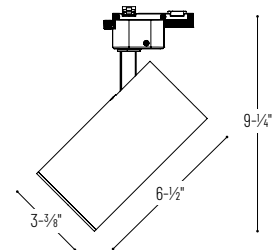

Jason Round LED Track Head

	Lumens / Wattage	Beam Spread	Color Temperature / CRI	Finish
80 CRI (While Supplies Last)	NTE-85518 = 1400lm / 18W	S = 24° Spot	30 = 3000K / 80 CRI	S = Silver
		M = 40° Narrow Flood	35 = 3500K / 80 CRI	
		F = 60° Flood		
	NTE-85518 = 1400lm / 18W	S = 24° Spot	40 = 4000K / 80 CRI	B = Black
		M = 40° Narrow Flood		S = Silver
		F = 60° Flood		W = White
	NTE-85526 = 2200lm / 26W	S = 24° Spot	30 = 3000K / 80 CRI	S = Silver
		M = 40° Narrow Flood		
		F = 60° Flood		
	NTE-85526 = 2200lm / 26W	S = 24° Spot	35 = 3500K / 80 CRI	W = White
		M = 40° Narrow Flood		
		F = 60° Flood		
NTE-85533 = 2800lm / 38W	S = 24° Spot	30 = 3000K / 80 CRI	S = Silver	
	M = 40° Narrow Flood	35 = 3500K / 80 CRI		
	F = 60° Flood	40 = 3000K / 80 CRI		
90 CRI	NTE-85518 = 1400lm / 18W	S = 24° Spot	930 = 3000K / 90 CRI	B = Black
	NTE-85526 = 2200lm / 26W	M = 40° Narrow Flood	935 = 3500K / 90 CRI	S = Silver (special order only)
	NTE-85533 = 2800lm / 38W	F = 60° Flood	940 = 4000K / 90 CRI	W = White

Optional Accessories

Description
NTE-855BDB = Barndoor, Black
NTE-855BDW = Barndoor, White
NTE-855SN = Snoot, Black
NTE-855SNWW = Directional Shield, Black
NTE-855HC = Honeycomb Louver
NTE-855CG = Clear Glass
NTE-855FG = Frosted Glass
NT-380B = Round Monopoint Canopy, Black
NT-380W = Round Monopoint Canopy, White

Example: NTE-85526M930W = Jason Round LED Track Head, 2200lm / 26W, 40° Narrow Flood, 3000K / 90 CRI, White Finish

NTE-855

Jason Round LED Track Head Accessories

Type _____
Project _____
Catalog No. _____
Notes _____



Honeycomb Louver

NTE-855HC

Adds a honeycomb louver accessory to Jason track head.



Frosted Glass

NTE-855FG

Replaces the clear glass included with Jason track head.



Barndoor

NTE-855BDB
NTE-855BDW

Adds an adjustable barn door accessory to Jason track head.

Black
White



Black Snoot

NTE-855SN

Adds a black snoot which reduces glare and spill light.



Black Directional Shield

NTE-855SNWW

Directional shield provides 45° cutoff.



Round Monopoint Canopy

NT-380B

Black

NT-380W

White

Allow track head to be installed as monopoint luminaire.

PHOTOMETRICS

Jason Round LED Track Head

Type

Project

Catalog No.

Notes

Test Information

Test Number: NTT11009
 Part Number: NTE-85533S30
 Beam Spread: Spot
 Lumens: 2941lm
 Wattage: 35.6W
 Efficacy: 83lpw
 CCT / CRI: 3000K / 80 CRI
 Spacing Criteria (0°-180°): 0.44
 Spacing Criteria (90°-270°): 0.42

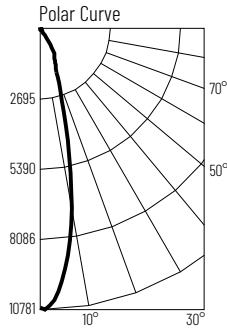

Illuminance at a Distance

Distance from Luminaire	FC at Nadir	Beam Diameter
4'	669fc	1'-10"
6'	297fc	2'-8"
8'	167fc	3'-6"
10'	107fc	4'-5"
12'	74.4fc	5'-4"

Zonal Lumen Summary

Zone	Lumens	% Luminaire
0-30	2533	86.1
0-40	2830	96.2
0-60	2895	98.4
0-90	2901	98.7
90-180	40	1.3
0-180	2941	100

Candela Table

Vertical Angles	Candela
0	10709
5	9673
15	3833
25	1340
35	445
45	59

Test Information

Test Number: NTT11011
 Part Number: NTE-85533M30
 Beam Spread: Narrow Flood
 Lumens: 2819lm
 Wattage: 35.5W
 Efficacy: 80lpw
 CCT / CRI: 3000K / 80 CRI
 Spacing Criteria (0°-180°): 0.66
 Spacing Criteria (90°-270°): 0.64

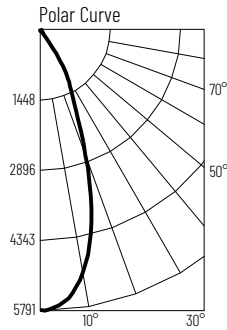

Illuminance at a Distance

Distance from Luminaire	FC at Nadir	Beam Diameter
4'	361fc	2'-10"
6'	160fc	4'-4"
8'	90.2fc	5'-8"
10'	57.7fc	7'-1"
12'	40.1fc	8'-6"

Zonal Lumen Summary

Zone	Lumens	% Luminaire
0-30	2408	85.4
0-40	2714	96.3
0-60	2775	98.4
0-90	2783	98.7
90-180	36	1.3
0-180	2819	100

Candela Table

Vertical Angles	Candela
0	5774
5	5643
15	4101
25	1646
35	456
45	54

Test Information

Test Number: NTT11008
 Part Number: NTE-85533F30
 Beam Spread: Flood
 Lumens: 2927lm
 Wattage: 36.5W
 Efficacy: 80lpw
 CCT / CRI: 3000K / 80 CRI
 Spacing Criteria (0°-180°): 0.78
 Spacing Criteria (90°-270°): 0.78

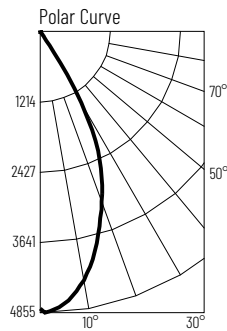

Illuminance at a Distance

Distance from Luminaire	FC at Nadir	Beam Diameter
4'	299fc	3'-10"
6'	133fc	5'-7"
8'	74.8fc	7'-6"
10'	47.9fc	9'-5"
12'	33.2fc	11'-4"

Zonal Lumen Summary

Zone	Lumens	% Luminaire
0-30	2518	86
0-40	2875	98.2
0-60	2908	99.3
0-90	2912	99.5
90-180	15	0.5
0-180	2927	100

Candela Table

Vertical Angles	Candela
0	4785
5	4721
15	3782
25	2442
35	291
45	23