

HDTVET0101VL7VL8 User Manual

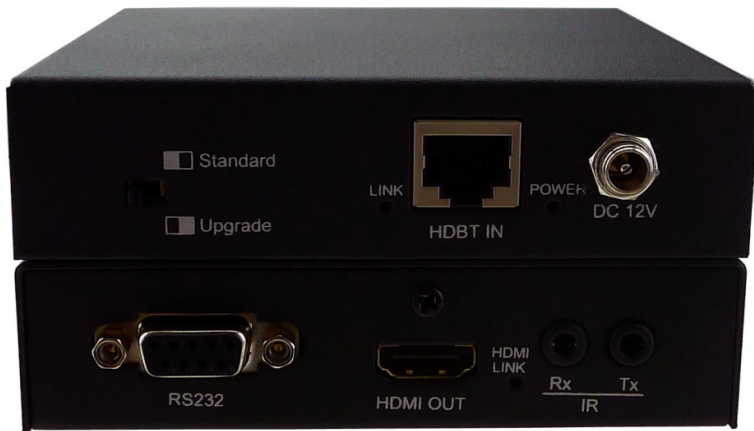

Thank you for purchasing this product. For optimum performance and safety, please read these instructions carefully before connecting, operating or adjusting this product. Please keep this manual for future reference.

SURGE PROTECTION DEVICE RECOMMENDED

This product contains sensitive electrical components that may be damaged by electrical spikes, surges, electric shock, lightning strikes, etc. Use of surge protection systems is highly recommended in order to protect and extend the life of your equipment.

SAFTY AND NOTICE

1. The transmission distances of HDMI over UTP cables are measured using TE CONNECTIVITY 1427071-6
2. EIA/TIA-568-B termination (T568B) for CAT cables is recommended for better performance.
3. DO NOT use 568A/568B standard mixed CAT cable (cross-over cable) because there are 2 pairs swapped, this will make POE OVER-CURRENT and damage POE components. Please use straight-through CAT cable (both RJ45 headers are 568A or 568B standard).
4. It is recommended that power up the device after connections of source, sink and CAT cable.
5. To reduce the interference among the unshielded twisted pairs of wires in CAT cable, do not run HDBaseT / Zone Cat5e/6/6a cabling with or in close parallel proximity to mains power cables. Shielded CAT cables can be used to improve EMI problems, which is worsen in long transmission.
6. Because the quality of the CAT cables has the major effect on how long the transmission limit can achieve and how good is the received picture quality, the actual transmission range is subject to one's choice of CAT cables.
7. Do not substitute or use any other Power Supply other than the enclosed unit, or a Tonlyware approved Replacement Part. Doing so will void the warranty and potentially expose the user to dangerous voltages resulting in an electrical shock.
8. Do not disassemble the device for any reason. Doing so will void the manufacturer's warranty. Also, our unique case is an integral part of the design of this unit and is responsible for cooling and circuitry shielding. Any modifications to this case will potentially cause malfunction and product failure.
9. Do not expose the device to water, moisture, or liquids. Possible electric shock may result as well as failure of the unit to operate.

Table of Contents

1. Introduction.....	4
2. Features.....	4
3. Panel Description.....	5
4. Connection Diagram.....	7
5. Specifications.....	8
6. Package Contents.....	8

Introduction

HDTV Supply's HDTVET0101VL7 (Transmitter)/HDTVET0101VL8 (Receiver) is a 70m (230ft) HDBaseT Extender. It transmits 1080P@60HZ at 48bit deep color via single Cat5e up to 70 meters (230ft) and 4K@30Hz to 40 meters (130ft). Bi-directional IR and RS232 can also be transmitted over the same Cat5e cable. With support of POH (power over HDBaseT), only one power supply is needed at either transmitter or receiver.

Features

- HDMI v1.4 and HDCP compliant, support 1080p@60Hz, 3D and 4Kx2K
- Support 1080P@60Hz or VESA: 1920x1200@60Hz up to 70m (230ft).
- Transmission distance for 4Kx2K@30Hz up to 40m (130ft).
- Dolby TrueHD and DTS-HD master audio pass through HDMI output
- Bi-Directional IR and RS232 pass through.
- Power over HDBaseT supported, only one power supply needed at either transmitter or receiver side.
- With ESD Protection.

Panel Description

HDTVET0101VL7

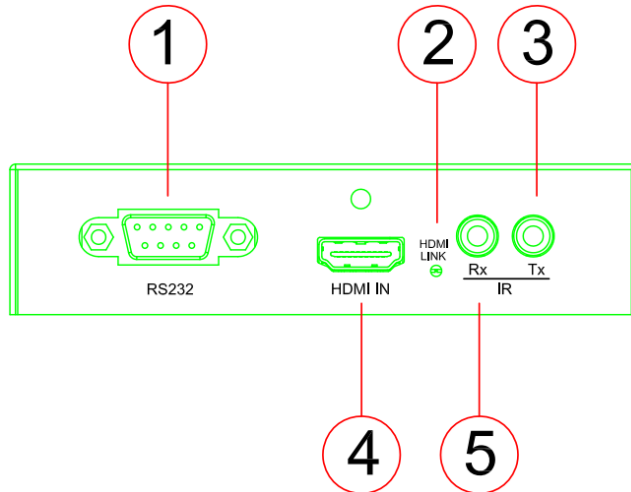

1. RS232 connector
2. HDMI link indicator
3. IR TX jack
4. HDMI input
5. IR RX jack

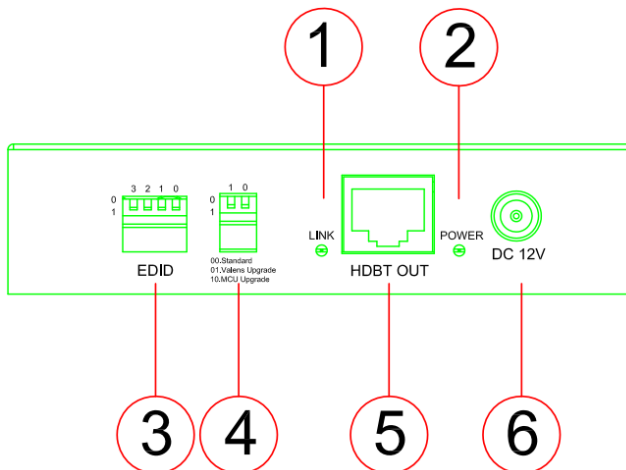

1. Signal Link indicator
2. Power status indicator
3. EDID DIP switch (UP=0, DOWN=1)
 [DIP]=0000: HDMI 1080p@60Hz, Audio 2CH PCM
 [DIP]=1111: Copy EDID from HDMI output, i.e., EDID pass through
 [DIP]=0001: HDMI 1080p@60Hz, Audio 5.1CH PCM/DTS/DOLBY

- [DIP]=0010: HDMI 1080p@60Hz, Audio 7.1CH PCM/DTS/DOLBY/HD
- [DIP]=0011: HDMI 1080i@60Hz, Audio 2CH PCM
- [DIP]=0100: HDMI 1080i@60Hz, Audio 5.1CH PCM/DTS/DOLBY
- [DIP]=0101: HDMI 1080i@60Hz, Audio 7.1CH PCM/DTS/DOLBY/HD
- [DIP]=0110: HDMI 1080p@60Hz/3D, Audio 2CH PCM
- [DIP]=0111: HDMI 1080p@60Hz/3D, Audio 5.1CH PCM/DTS/DOLBY
- [DIP]=1000: HDMI 1080p@60Hz/3D, Audio 7.1CH PCM/DTS/DOLBY/HD
- [DIP]=1001: HDMI 4K2K, Audio 2CH PCM
- [DIP]=1010: HDMI 4K2K, Audio 5.1CH PCM/DTS/DOLBY
- [DIP]=1011: HDMI 4K2K, Audio 7.1CH PCM/DTS/DOLBY/HD
- [DIP]=1100: DVI 1280x1024@60Hz, Audio None
- [DIP]=1101: DVI 1920x1080@60Hz, Audio None
- [DIP]=1110: DVI 1920x1200@60Hz, Audio None

4. Upgrades DIP switch
5. HDBT output
6. DC 12V screw type connector

HDTVET0101VL8

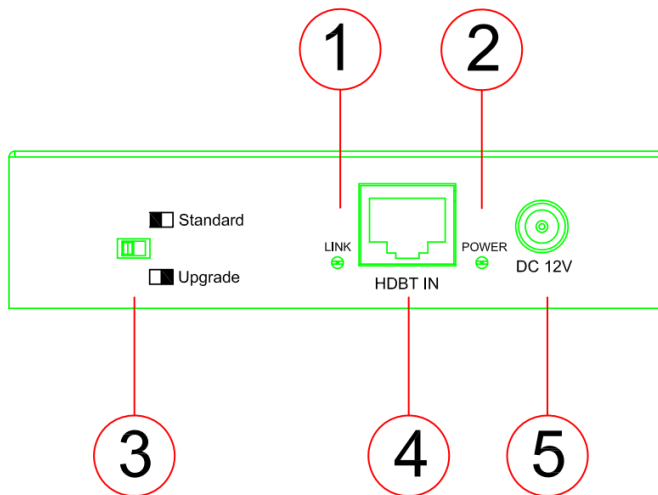

1. Signal Link indicator
2. Power status indicator
3. Standard/Upgrade mode switch - On Standard side, for signal pass-thru. On Upgrade side, for Valens chipset firmware upgrade.
4. HDBT input
5. DC 12V screw type connector

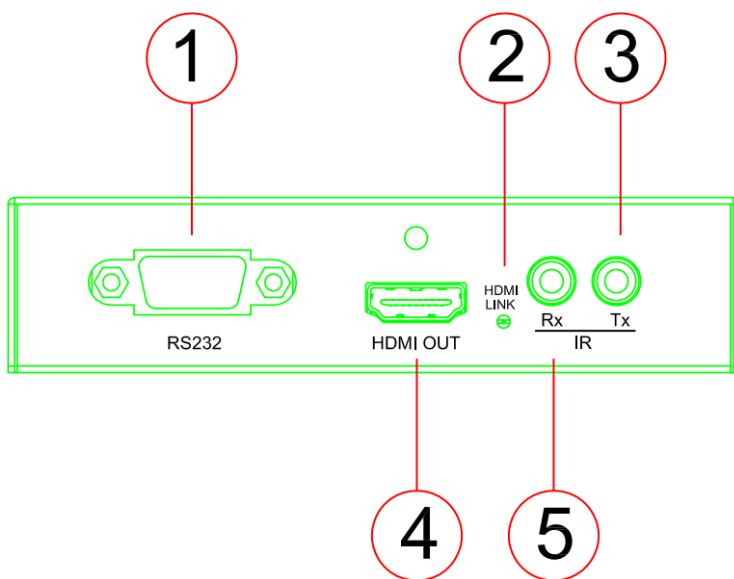

1. RS232 connector
2. HDMI link indicator
3. IR TX jack
4. HDMI output
5. IR RX jack

Connection Diagram

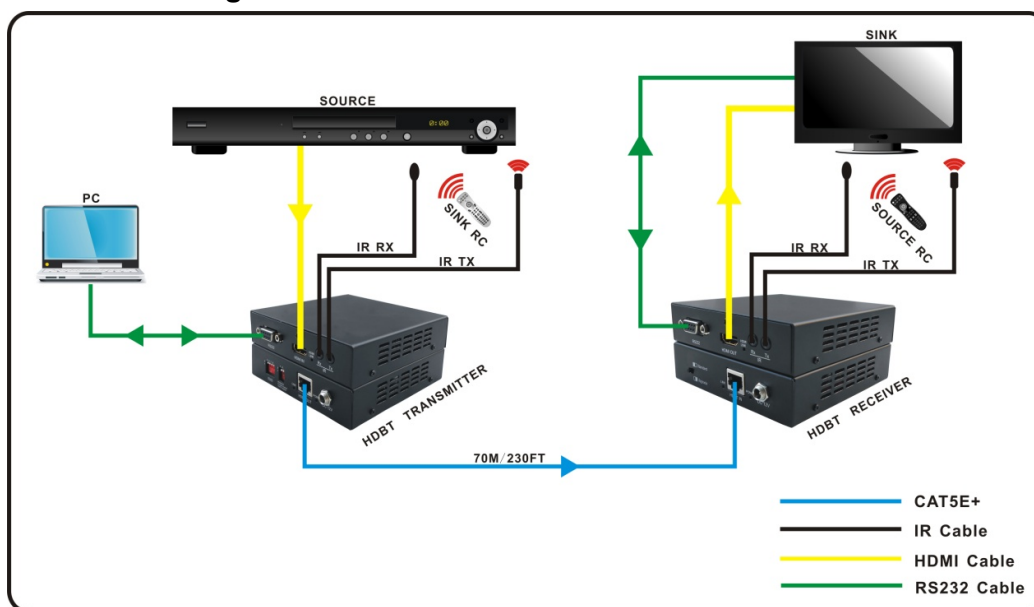

Specifications

Bandwidth	2.97Gbps per Color	
Video input	HDTVET0101VL7 1XHDMI Type A, 19-pin, female	HDTVET0101VL8 1xRJ45
Video output	HDTVET0101VL7 1xRJ45	HDTVET0101VL8 1XHDMI Type A, 19-pin, female
IR input	2x3.5mm stereo jack	
IR output	2x3.5mm stereo jack	
RS232 control	2x DB9	
Power Supply	12V/2A DC, screw type connector	
Power Consumption	9.5W	
Audio	Passes up to Dolby TrueHD or DTS-HD Master Audio	
Resolution	Video: up to 4Kx2K VESA: up to 1920x1200	
Distance	230ft @ 1080p over CAT5e/6 130ft @ 4Kx2K over CAT5e/6	
Dimensions	107x107x27mm	
Weight	200g	
Temperature	Operating 32°F to 104°F (0°C to 40°C)	Storage -4°F to 140°F (20°C to 60°C)
Rack-Mountable	Rack ears included	

NOTE: Specifications are subject to change without notice. Weight and dimensions are approximate.

Package Contents

- 1x HDTVET0101VL7
- 1x HDTVET0101VL8
- 1x 12V/2A DC power supply
- 1x IR Transmitter, 1x IR Receiver.
- 4x mounting brackets.