

High Security – National Lock

- Locks on this page meet or exceed ANSI/BHMA Grade 2 (Grade 1 available upon request)
- Approved by the Woodworkers Institute (formerly WIC)
- Custom Master keying and General Master key systems available upon request
- 2000 key changes are possible, special order 5 pin tumblers
 - Please include a key plan
 - Plan on 2–3 weeks to produce

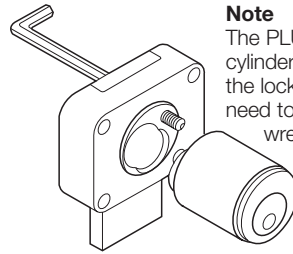
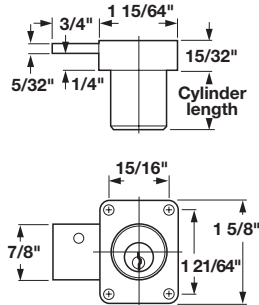

Note

The PLUS feature allows you to remove the cylinder from our pin tumbler box locks while the lock remains in place. No mounting screws need to be removed. Simply use a 5/64" hex wrench from the back to remove the cylinder for re-keying.

C8173 Door Locks

- For right or left hand applications
- 4 pin tumblers include 850 key changes
- Cylinder length 7/8", Bolt travel 3/4"
- Surface mounted, requires a Ø57/64" hole
- Key turns 360°

Keyed Different

Material: Brass-plated

Finish	National No.	Item No.
brushed chrome	C8173-KD-26D	232.14.400
satin brass	C8173-KD-4	232.14.500

Supplied With

- 2 Keys
- Strike plate
- Screws

Master Keyed, Keyed Different

- Random key numbers only – no specific key numbers can be specified
- Please order master key separately (see below)

Material: Lock and keys: Brass-plated; Finish: brushed chrome

National No.	Item No.
C8173-MKKD-26D	232.14.497

Supplied With

- 2 Keys
- Strike plate
- Screws



Master Key

- For MKKD locks above

Material: Brass

National No.	Item No.
D4299	210.02.209

Keyed Alike

Finish	Keying #'s	National No.	Item No.
brushed chrome	101	C8173-101-26D	232.14.401
brushed chrome	103	C8173-103-26D	232.14.402
brushed chrome	107	C8173-107-26D	232.14.403
brushed chrome	915	C8173-915-26D	232.14.404
satin brass	107	C8173-101-4	232.14.503
satin brass	915	C8173-915-4	232.14.504

Supplied With

- 2 Keys
- Strike plate
- Screws

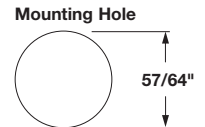
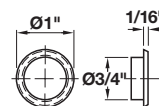

Cylinder Rosettes

Material: Brass

Finish	National No.	Item No.
brushed chrome	C2017-26D	232.14.000
satin brass	C2017-4	232.14.001

High Security – National Lock

- Locks on this page meet or exceed ANSI/BHMA Grade 2 (Grade 1 available upon request)
- Approved by the Woodworkers Institute (formerly WIC)
- Custom Master keying and General Master key systems available upon request
- 2000 key changes are possible, special order 5 pin tumblers
 - Please include a key plan
 - Plan on 2–3 weeks to produce

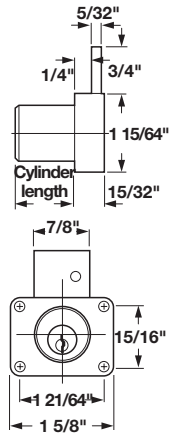

Master Key

- For MKKD locks above

Material: Brass

National No.	Item No.
D4299	210.02.209

Keyed Alike

- Cylinder Length 7/8"; Bolt travel 3/4"

Finish	Keying #'s	National No.	Item No.
brushed chrome	101	C8178-101-26D	232.14.301
brushed chrome	103	C8178-103-26D	232.14.302
brushed chrome	107	C8178-107-26D	232.14.303
brushed chrome	915	C8178-915-26D	232.14.304
satin brass	107	C8178-107-4	232.14.603
satin brass	915	C8178-915-4	232.14.604

- Cylinder Length 1 3/8"; Bolt travel 3/4"

Finish	Keying #'s	National No.	Item No.
brushed chrome	101	C8179-101-26D	232.14.351
brushed chrome	103	C8179-103-26D	232.14.352
brushed chrome	107	C8179-107-26D	232.14.353
brushed chrome	915	C8179-915-26D	232.14.354
satin brass	107	C8179-107-4	232.14.653

Supplied With

- 2 Keys
- Strike plate
- Screws

Keyed alike replacement keys page 10.38

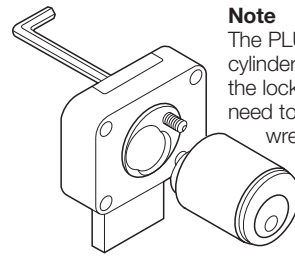

Note

The PLUS feature allows you to remove the cylinder from our pin tumbler box locks while the lock remains in place. No mounting screws need to be removed. Simply use a 5/64" hex wrench from the back to remove the cylinder for re-keying.

C8178 and C8179 - Drawer Locks

- 4 pin tumblers include 850 key changes
- Surface mounted, requires a Ø57/64" hole
- Bolt travel 3/4"
- Key turn 360°

Keyed Different

Material: Brass-plated

Finish	Cylinder Length	National No.	Item No.
brushed chrome	7/8"	C8178-KD-26D	232.14.300
brushed chrome	1 3/8"	C8179-KD-26D	232.14.350
satin brass	7/8"	C8178-KD-4	232.14.600
satin brass	1 3/8"	C8179-KD-4	232.14.650

Supplied With

- 2 Keys
- Strike plate
- Screws

Master Keyed, Keyed Different

- Random key numbers only – no specific key numbers can be specified
- Please order master key and cylinder rosettes separately (see below)

Material: Brass-plated; Finish: brushed chrome

Cylinder Length	National No.	Item No.
7/8"	C8178-MKKD-26D	232.14.347
1 3/8"	C8179-MKKD-26D	232.14.397

Supplied With

- 2 Keys
- Strike plate
- Screws

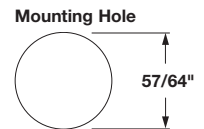
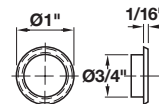

Cylinder Rosettes

Material: Brass

Finish	National No.	Item No.
brushed chrome	C2017-26D	232.14.000
satin brass	C2017-4	232.14.001

Dimensional data not binding. We reserve the right to alter specifications without notice.