

Keyboard Trays

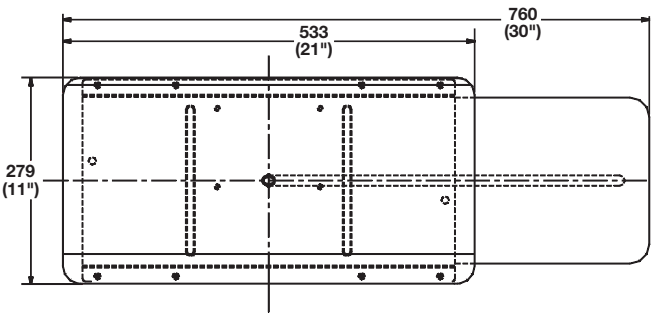

Keyboard Tray - Economy

- Low profile and durable
- Integrated mouse tray slides for left or right hand use

Material: Plastic, injection molded

| Color | Item No. |
|-------|------------|
| black | 639.96.397 |

Note
Tray does not include keyboard arm, please order separately, see below options.



Mix and Match Arms & Trays
to suit your needs

| Arms | Page | Trays | Page |
|----------------|------|------------------|------|
| Encore (good) | 5.5 | Economy (good) | 5.9 |
| Echo (better) | 5.6 | Harmony (better) | 5.10 |
| Ovation (best) | 5.7 | HDPE (best) | 5.10 |

Dimensional data not binding. We reserve the right to alter specifications without notice.

Keyboard Trays

5

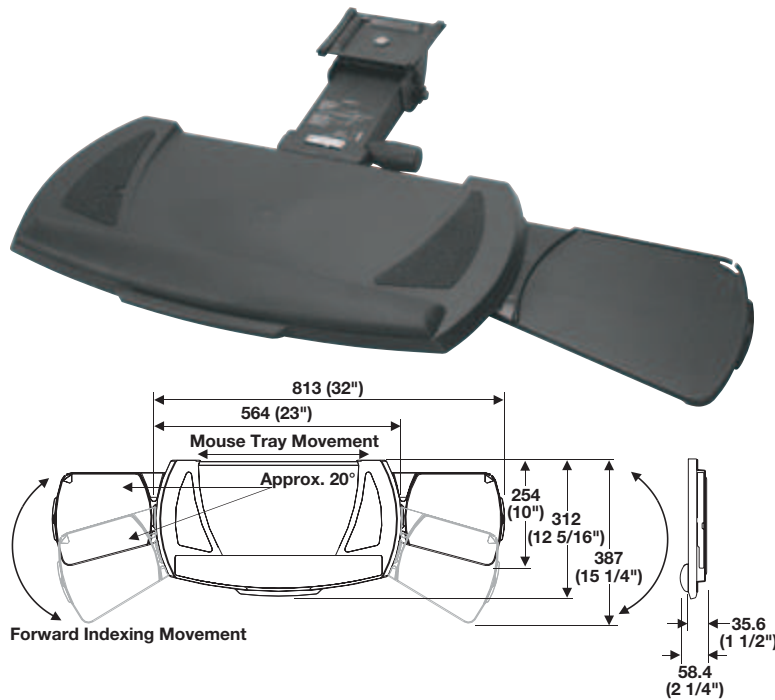

Keyboard Tray - Harmony

- Anti-skid pads prevent keyboard slippage
 - Removable, snap-in 19" gel-like foam wrist rest offers gentle support
 - Mousing surface smoothly and easily adjusts from side to side for left or right-hand use, with three forward index positions, built-in cable manager and fence to prevent slippage
- Track length: 552 mm (21 3/4")

Material: Plastic

| Color | Item No. |
|-------|------------|
| black | 632.68.395 |

Note

Tray does not include keyboard arm, please order separately, see below options.

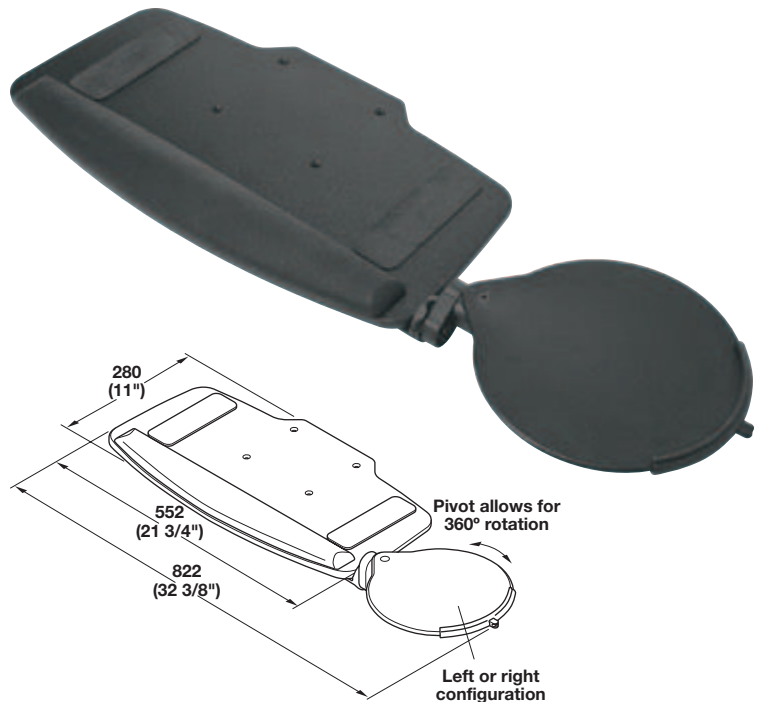

Keyboard Tray - HDPE

- HDPE (High Density Polyethylene) tray is fully recyclable
- Mouse tray with guard to prevent slippage of the mouse
- Mouse tray is height adjustable & swivels 360°

Material: Arm Mechanism: Steel, epoxy-coated
Keyboard Tray: HDPE Plastic

| Color | Item No. |
|-------|------------|
| black | 632.68.336 |

Supplied With

Tray
Mouse pad

Note

Tray does not include keyboard arm, please order separately, see below options.



Mix and Match Arms & Trays to suit your needs

| Arms | Page | Trays | Page |
|----------------|------|------------------|------|
| Encore (good) | 5.5 | Economy (good) | 5.9 |
| Echo (better) | 5.6 | Harmony (better) | 5.10 |
| Ovation (best) | 5.7 | HDPE (best) | 5.10 |

Dimensions in mm
Inches are approximate