

OFFICE ORGANIZATION





Computer Accessories

Keyboard Drawers	5.3-5.4	Ellipta® Monitor Arm	5.13-5.15
Keyboard Arms	5.5-5.8	Monitor Suspension Systems	5.16-5.17
Keyboard Trays	5.9-5.10	CPU Holders	5.18
Keyboard Combo Packs	5.11-5.12		



Pencil Drawers

Pencil Drawers	5.19
----------------	------



Hanging File System

File Frame Kit	5.20	Brackets and Rails	5.21
----------------	------	--------------------	------



Power and Charging

Power Bars	5.22-5.23	Power/Data Centers	5.26
Guestcharge Power/Data Center	5.23	Hide-A-Dock	5.27
USB Charging Center	5.24	Pop-Up Power Stations	5.28
Charging Grommets	5.24	Powerdocks	5.29
Docking Station 250	5.25	Docking Drawer	5.30-5.31



Cable Management/ Turntables

Grommets	5.32-5.35	Wire Managers	5.37
Waste Management Liner	5.35	Turntables	5.38-5.40
Cable Trunking/Grip	5.36		

Keyboard Drawers



Keyboard Tray with Mouse Tray

- For occasional users or home office
- Mouse tray, supplied with a polyurethane pad, attaches on left or right hand side
- Ball bearing, full extension drawer slides with plastic stops to prevent tray moving once extended
- Mouse holder with spring stop to store most mouse types
- Spring stops in tray keep most types of keyboards secure

Material: Plastic

Color	Item No.
black	429.80.360

Supplied With
Mounting template
Screws

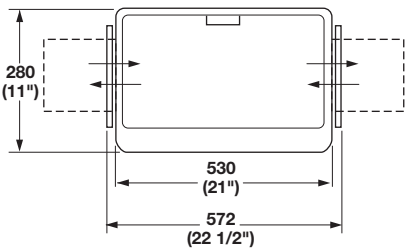
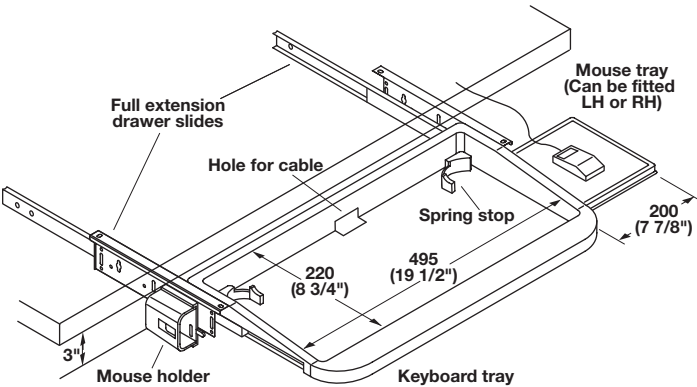

Keyboard Tray

- Adjustable keyboard clamp
 - Ball bearing slides with hold-in and hold-out detents
 - Sloped edge functions as a comfortable wrist rest
- Installed depth: 420 mm (16 1/2")
Extended depth: 679 mm (26 3/4")
Min. width required for installation: 600 mm (24")
Weight capacity: 20 kg (44 lbs.)

Material: Tray and Brackets: Plastic; Color: black
Ball Bearing Slides: Steel; Finish: zinc-plated

Model	Item No.
Without mouse tray	632.65.300
With mouse tray	632.65.305

Supplied With
Mounting hardware

Note
Simple assembly is required.

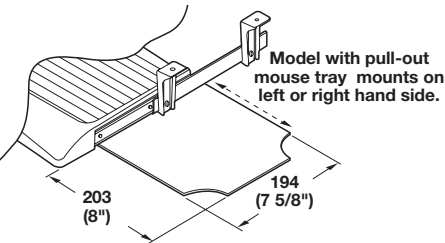
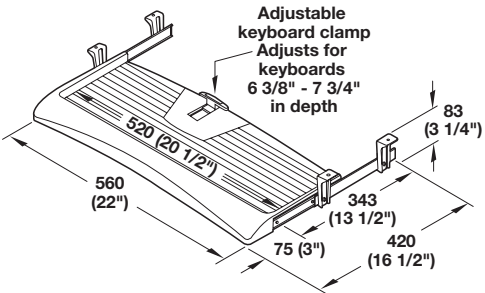

Dimensional data not binding. We reserve the right to alter specifications without notice.

Accuride Keyboard Drawers

- For occasional users, home office, education, learning and training centers or heavy-use typing/data entry
- Sleek curvilinear look
- Slides are fully concealed, no rough or exposed edges
- Removable palm rest allows unit to accommodate virtually any size keyboard
- Extra wide tray design provides ample mousing surface
- Built-in cable management
- Removable mouse pad for right or left handed mousing
- Heavy duty adjustable brackets with 7 height adjustments
- Brackets can mount facing in or out



5

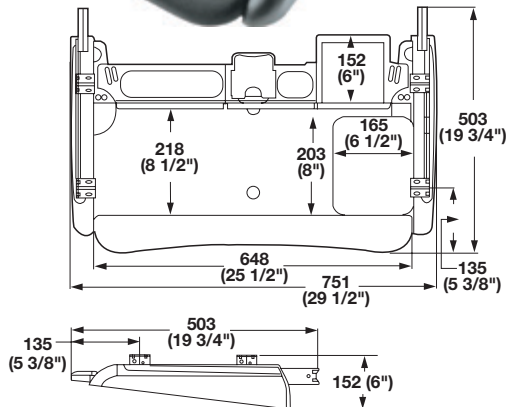
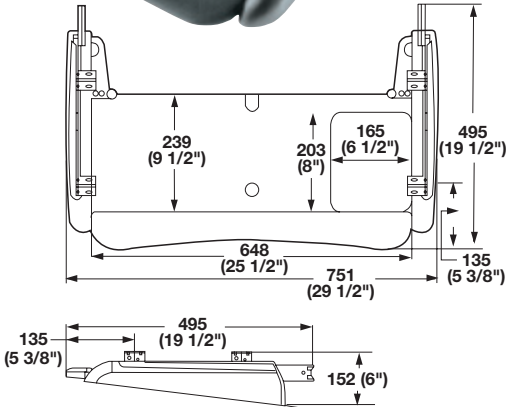

Dimensions in mm
Inches are approximate

Standard Keyboard System - Model 200

- 3/4 extension slides
- Tray tilt, fixed at -7°
- Detent in the open and closed position
- Weight capacity: 75 lbs.

Material: Steel, Foam, ABS Molded Plastic

Color	Item No.
black	632.52.300

Note
Keyboard and mouse not included.

Deluxe Keyboard System - Model 300

- Full extension slides
- Tray tilt, adjusts at - 7°, - 3.5° and flat (0°)
- Intermediate detent in open and closed position
- Rear storage compartments
- Weight capacity: 100 lbs.

Material: Steel, Foam, ABS Molded Plastic

Color	Item No.
black	632.52.310

Note
Keyboard and mouse not included.

Dimensional data not binding. We reserve the right to alter specifications without notice.

Keyboard Arms

- The Encore Arm is an entry level arm that provides most of the features at an economical price
- For occasional users, home office, education, learning and training centers
- Meets or exceeds ANSI/BIFMA requirements
- Made in North America, TAA Compliant



Keyboard Arm - Encore

- Low profile design provides maximum leg room
- Star wheel adjustment knob provides simultaneous height and tilt adjustment
- 360° swivel allows user to move keyboard freely from side to side
- Stores on 432 mm (17") plastic glide track

Material: Steel, epoxy-coated; Components: Plastic

Color	Item No.
black	632.68.380

Note

Arm does not include keyboard tray, please order separately, see below options.

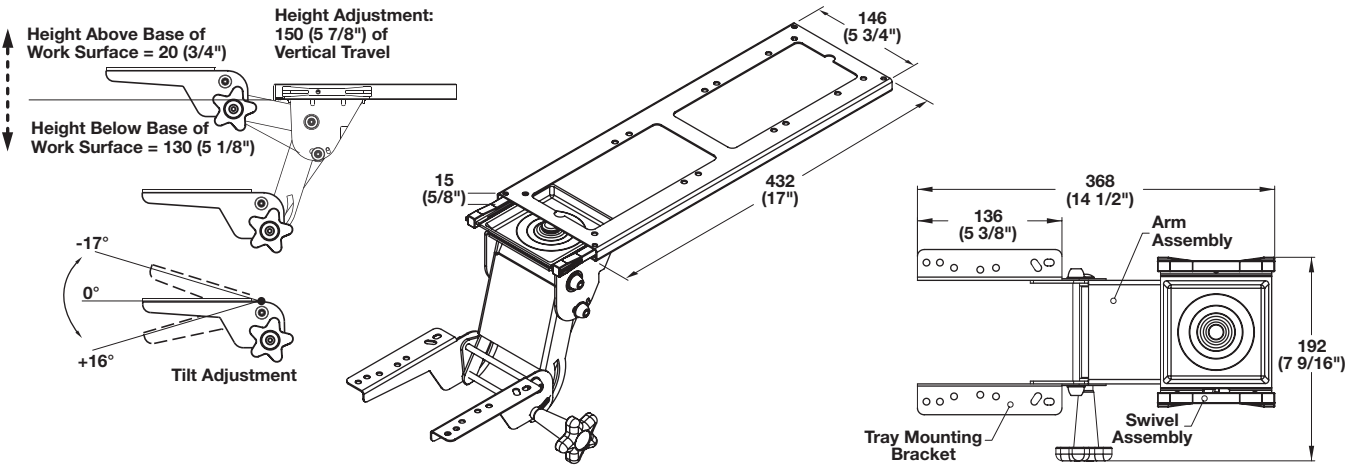

Mix and Match Arms & Trays to suit your needs

Arms	Page	Trays	Page
Encore (good)	5.5	Economy (good)	5.9
Echo (better)	5.6	Harmony (better)	5.10
Ovation (best)	5.7	HDPE (best)	5.10

Dimensional data not binding. We reserve the right to alter specifications without notice.

Keyboard Arms

- The Echo Arm is a no-frills keyboard support arm that offers all the adjustability needed for comfort and efficiency
- For occasional users, home office, education, learning and training centers
- Meets or exceeds ANSI/BIFMA requirements
- Made in North America, TAA Compliant



Keyboard Arm - Echo

- Soft touch knob adjusts both height and tilt simultaneously
 - Spring assisted to help counterbalance keyboard tray weight
 - 360° swivel allows user to move keyboard freely from side to side
 - Low profile ball bearing track
- Track length: 432 mm (17")

Material: Steel, epoxy-coated; Components: Plastic

Color	Item No.
black	632.68.301

Note

Arm does not include keyboard tray, please order separately, see below options.

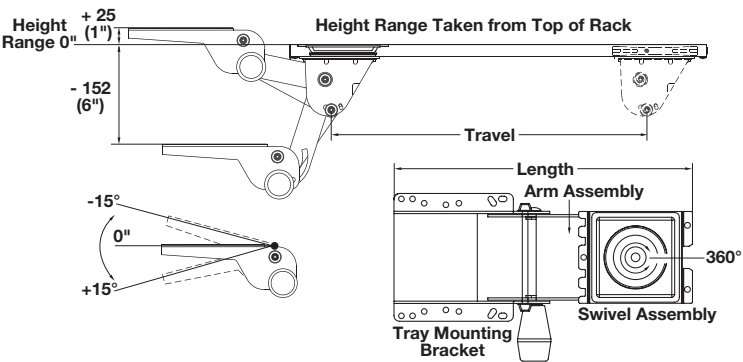
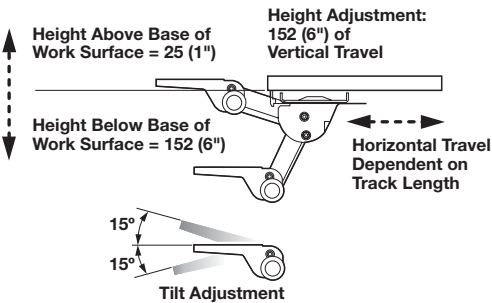

Mix and Match Arms & Trays to suit your needs

Arms	Page	Trays	Page
Encore (good)	5.5	Economy (good)	5.9
Echo (better)	5.6	Harmony (better)	5.10
Ovation (best)	5.7	HDPE (best)	5.10

Keyboard Arms

- The Ovation Arm is designed to offer a greater range of motion with maximum user comfort and safety
- Gauges for both height and tilt adjustment make it easy for each user to custom fit the keyboard position to their personal preference
- Lift-N-Lock™ spring – assisted height adjustment (no levers or knobs)
- Soft-touch dial knob for easy negative or positive tilt adjustment, +10°/-15°, provides greater ADA compliance
- Tray tilt angle indicator
- Under work surface storage and 360° swivel
- Heavy-use typing/data entry multi users
- Commercial/industrial installations
- Corner workstations, clears 45° corner angles
- Meets or exceeds ANSI/BIFMA requirements
- Made in North America, TAA Compliant

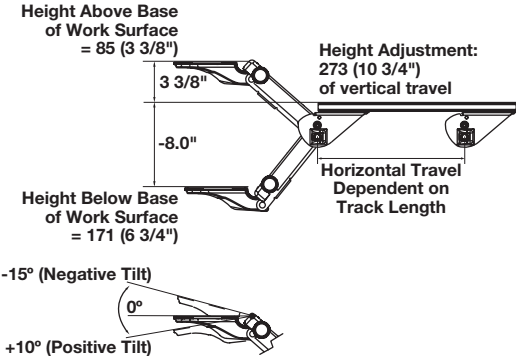
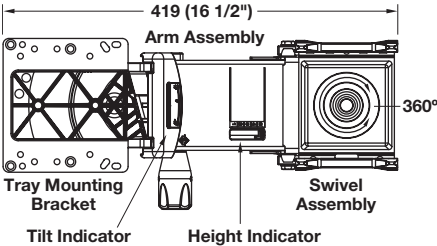

Keyboard Arm - Ovation

Track length: 552 mm (21 3/4")

Material: Steel

Color	Item No.
black epoxy	632.68.385

Note
Arm does not include keyboard tray, please order separately, see below options.



Mix and Match Arms & Trays to suit your needs

Arms	Page	Trays	Page
Encore (good)	5.5	Economy (good)	5.9
Echo (better)	5.6	Harmony (better)	5.10
Ovation (best)	5.7	HDPE (best)	5.10

Dimensional data not binding. We reserve the right to alter specifications without notice.

Keyboard Arms

- The Duet Arm is a highly stable sit-to-stand unit, which provides an increased work surface area
- This revolutionary product with its sleek design permits the addition of a fully adjustable secondary work surface to most fixed or height adjustable tables
- Offers easy height and tilt changes
- For heavy-use typing/data entry, multi-users or commercial/industrial installations
- Meets or exceeds ANSI/BIFMA requirements
- Other widths available upon request
- New and improved spring brake mechanism accommodates heavier loads

Weight rating: Counter-balance: 30 lbs.

Total weight capacity of locking function: 150 lbs.



5



Duet 686 mm (27") Sit-to-Stand

- With dual arms to support large platforms
- Paddle actuator for single hand height adjustment
- Knob for independent $\pm 15^\circ$ tilt adjustment

Material: Steel, epoxy-coated

Color	Item No.
black	632.68.340

Note

Platform to be provided by end user:

Min. depth = 305 mm (12"); Max. depth = 457 mm (18")

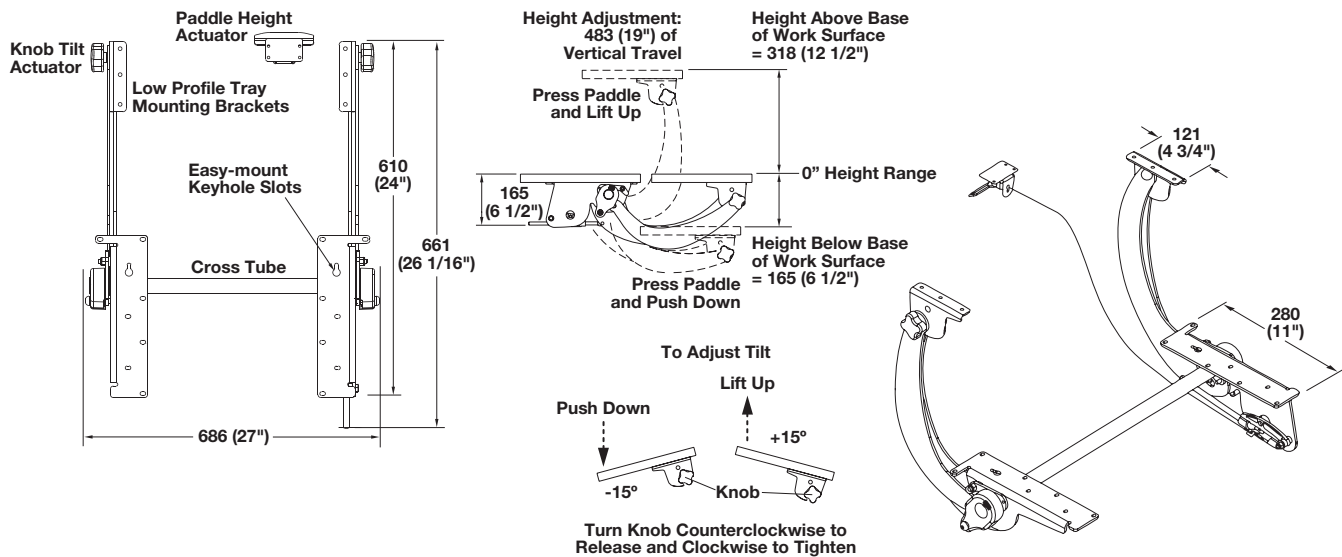

Keyboard Trays

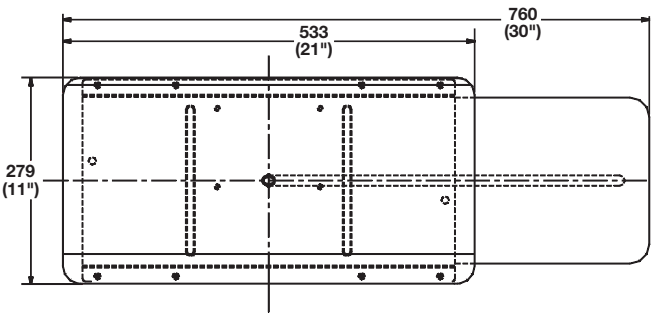

Keyboard Tray - Economy

- Low profile and durable
- Integrated mouse tray slides for left or right hand use

Material: Plastic, injection molded

Color	Item No.
black	639.96.397

Note
Tray does not include keyboard arm, please order separately, see below options.



Mix and Match Arms & Trays
to suit your needs

Arms	Page	Trays	Page
Encore (good)	5.5	Economy (good)	5.9
Echo (better)	5.6	Harmony (better)	5.10
Ovation (best)	5.7	HDPE (best)	5.10

Dimensional data not binding. We reserve the right to alter specifications without notice.

Keyboard Trays

5

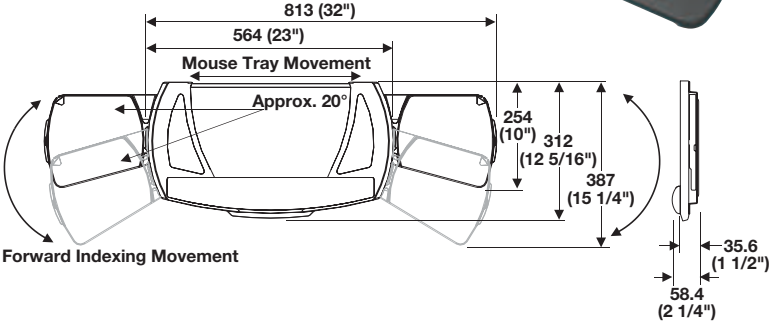
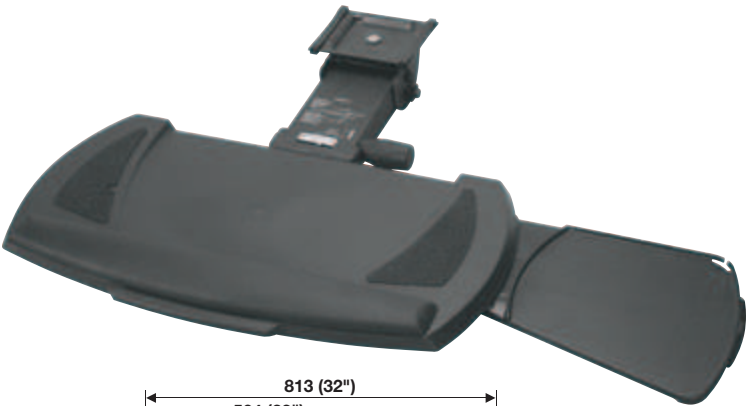

Keyboard Tray - Harmony

- Anti-skid pads prevent keyboard slippage
 - Removable, snap-in 19" gel-like foam wrist rest offers gentle support
 - Mousing surface smoothly and easily adjusts from side to side for left or right-hand use, with three forward index positions, built-in cable manager and fence to prevent slippage
- Track length: 552 mm (21 3/4")

Material: Plastic

Color	Item No.
black	632.68.395

Note

Tray does not include keyboard arm, please order separately, see below options.

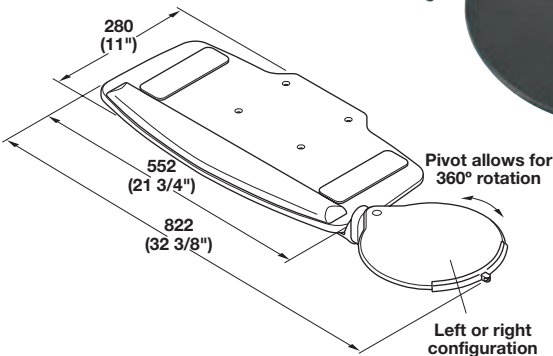
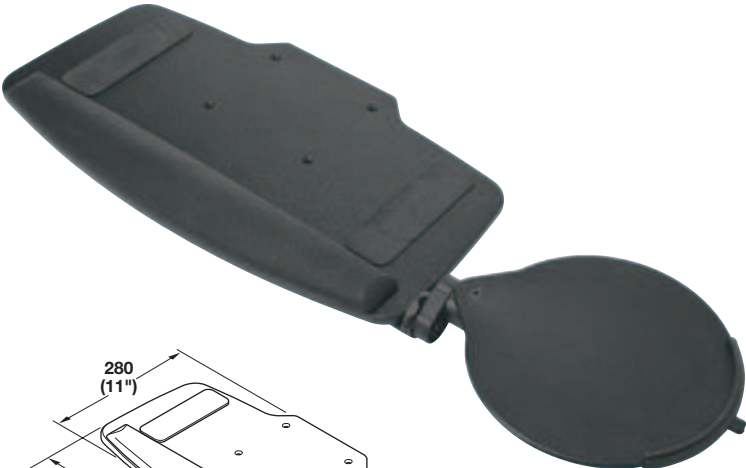

Keyboard Tray - HDPE

- HDPE (High Density Polyethylene) tray is fully recyclable
- Mouse tray with guard to prevent slippage of the mouse
- Mouse tray is height adjustable & swivels 360°

Material: Arm Mechanism: Steel, epoxy-coated
Keyboard Tray: HDPE Plastic

Color	Item No.
black	632.68.336

Supplied With

Tray
Mouse pad

Note

Tray does not include keyboard arm, please order separately, see below options.



Mix and Match Arms & Trays
to suit your needs

Arms	Page	Trays	Page
Encore (good)	5.5	Economy (good)	5.9
Echo (better)	5.6	Harmony (better)	5.10
Ovation (best)	5.7	HDPE (best)	5.10

Dimensions in mm
Inches are approximate

Keyboard Combo Packs

- Entry level arm and tray combos that provide economical price points

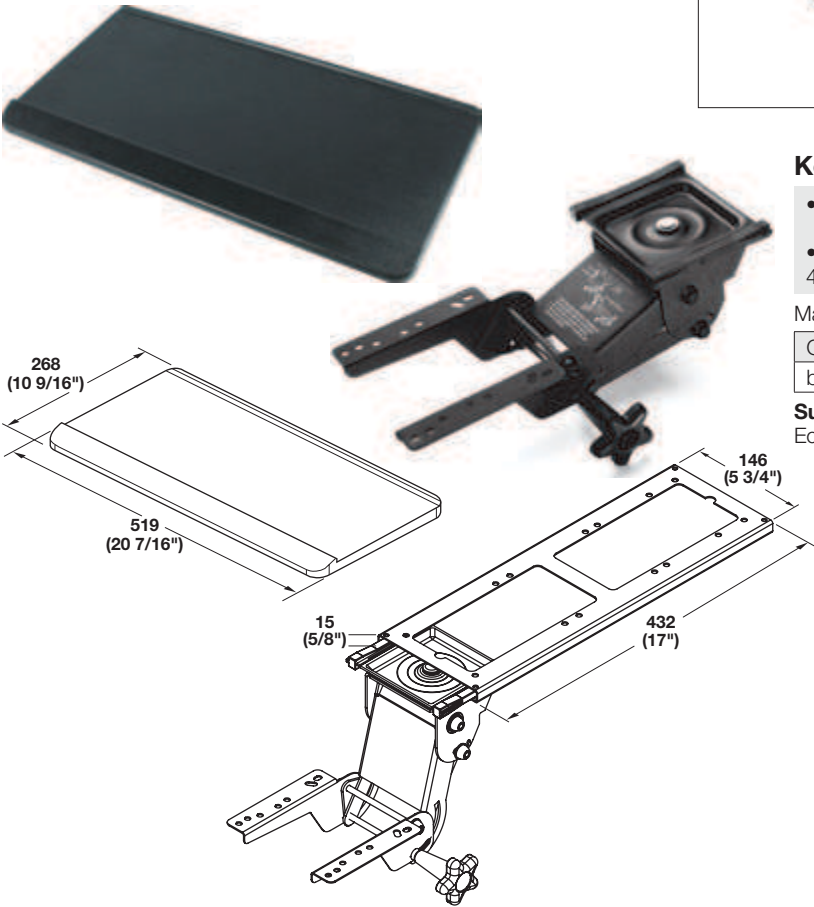

Keyboard Tray Combo Pack

- Low profile arm with knob adjustment for both height and tilt
- 360° swivel
- 432 mm (17") track with 151 mm (6") height adjustment

Material: Arm: Steel; Tray: ABS Plastic

Color	Item No.
black	632.68.316

Supplied With
Economy tray without mouse pad.

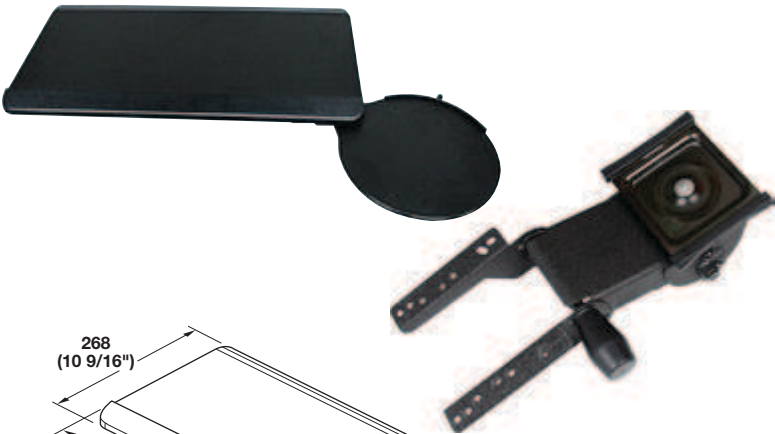

Keyboard Tray Combo Pack

- Low profile arm with Lift N Lock leverless adjustment
- 360° swivel
- 432 mm (17") track with 151 mm (6") height adjustment

Material: Arm: Steel; Tray: ABS Plastic

Color	Item No.
black	632.68.317

Supplied With
Tray with swivel mouse platform for left or right handed attachment.

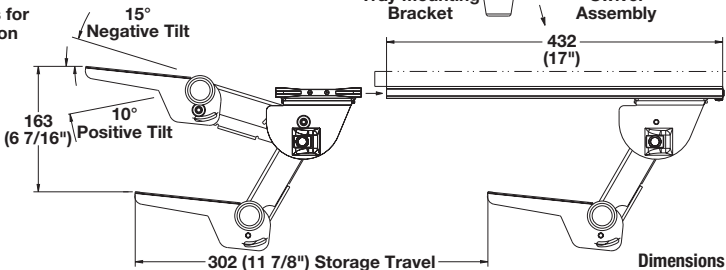
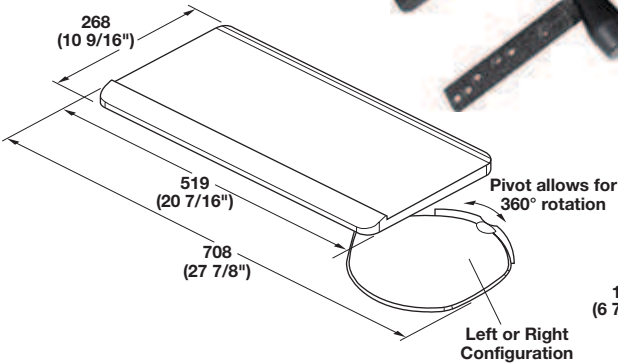

Dimensions in mm
Inches are approximate

Dimensional data not binding. We reserve the right to alter specifications without notice.

Keyboard Combo Packs

5

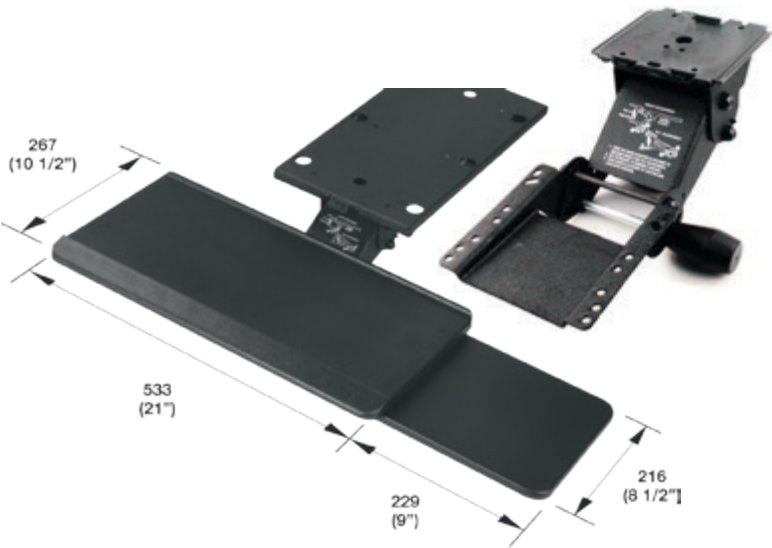

Keyboard Tray Combo Pack

- Soft touch knob adjusts both height and tilt simultaneously
 - Spring assisted to help counterbalance keyboard tray weight
 - 360° swivel allows user to move keyboard freely from side to side
 - Low profile ball bearing track
- Track length: 432 mm (17")

Material: Arm: Steel, epoxy-coated
Tray: Plastic, injection molded; Color: black

Track Length	Item No.
425 (16 3/4")	632.68.311
552 (21 3/4")	632.68.312

Supplied With
Economy tray with mouse tray slides for left or right hand use.

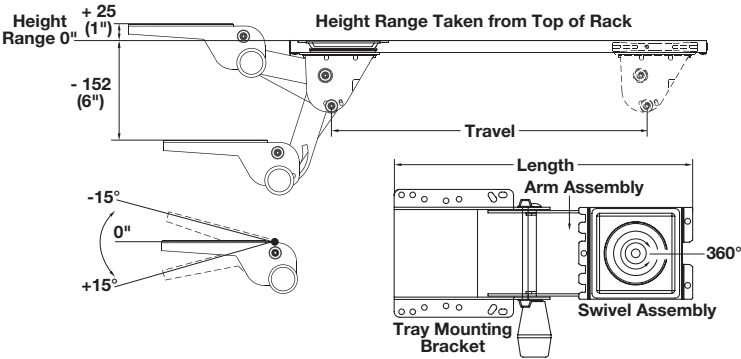

Volante Desktop Sit to Stand Workstation

- Ships fully assembled for easy install
- The compact footprint easily fits onto a 24" deep desk
- Primary work surface is large enough to accommodate two x 24" monitors
- Large keyboard surface easily holds a keyboard and mouse
- At full elevation primary work surface is positioned 20" above desk
- Supports 35 lbs. of technology
- The keyboard surface can be adjusted through 20° (-10+10)
- Weighs less than 40 lbs. is light enough for one person installation
- Side mounted paddles controlling gas assist height adjustment
- Keyboard surface adjusts with the primary surface



Material: Frame: Steel; Work Surfaces: Phenolic

Color	Item No.
black	633.44.000

5

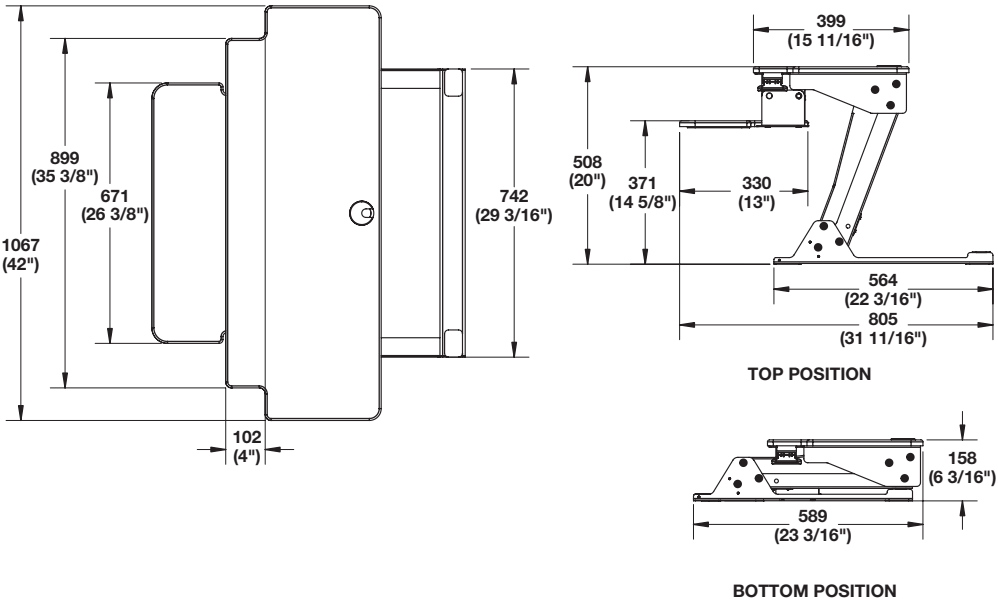

Dimensional data not binding. We reserve the right to alter specifications without notice.

This page is left blank intentionally.

**Ellipta® Monitor Arm
for Flat Screen**



More flexibility

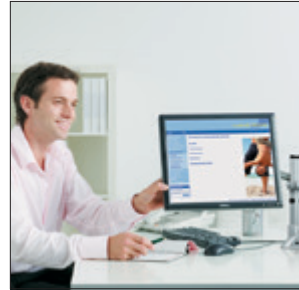

Better communication

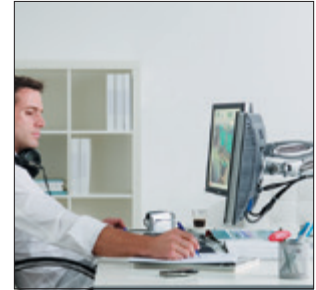

More creative freedom

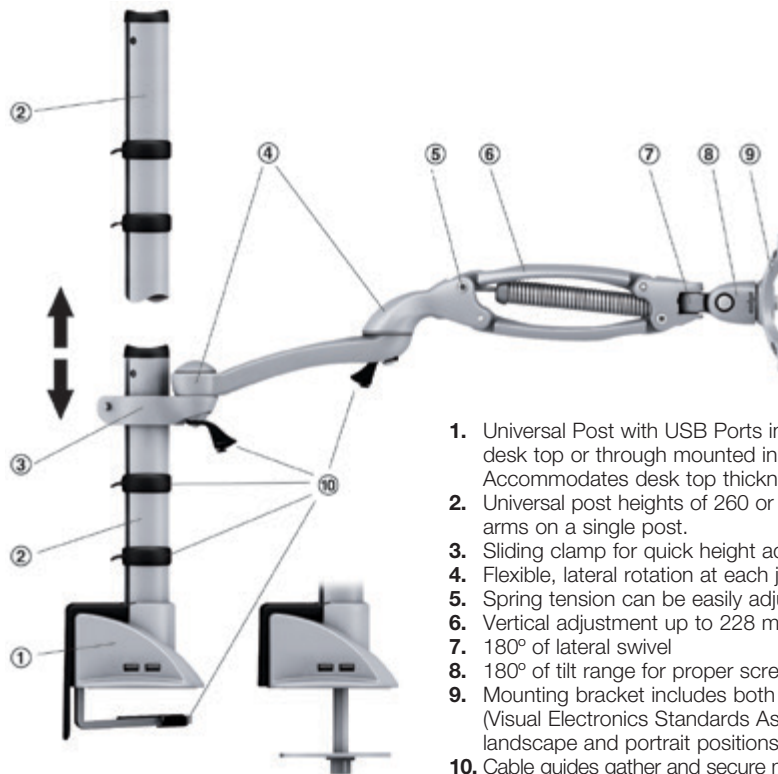

1. Universal Post with USB Ports includes 4 (2.0) USB ports, and can be clamp mounted to desk top or through mounted in a standard grommet hole up to Ø80 mm (3 1/8"). Accommodates desk top thicknesses of 8 to 75 mm (5/16" to 3").
2. Universal post heights of 260 or 570 mm (10 1/4" or 22 1/2") allow for mounting of multiple arms on a single post.
3. Sliding clamp for quick height adjustment without tools.
4. Flexible, lateral rotation at each joint for an unlimited range of settings.
5. Spring tension can be easily adjusted to counterbalance the weight of the monitor.
6. Vertical adjustment up to 228 mm (9") for optimal screen height.
7. 180° of lateral swivel
8. 180° of tilt range for proper screen angle
9. Mounting bracket includes both 75 and 100 mm (3" and 4") patterns to comply with VESA (Visual Electronics Standards Association) mounting standards. Rotate flat screen between landscape and portrait positions.
10. Cable guides gather and secure monitor wires, keeping the work surface clear of unsightly cables.

Range of Adjustment:

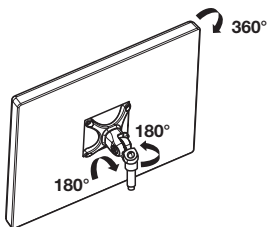

With Short Arm

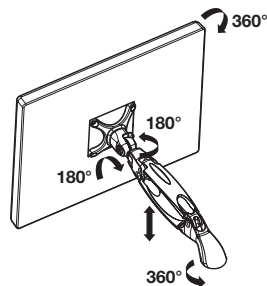

With Medium Arm

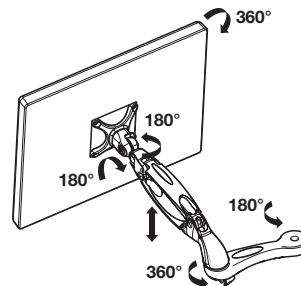

With Long Arm

Dimensional data not binding. We reserve the right to alter specifications without notice.

Ellipta®

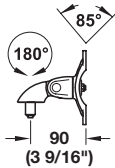

Short Arm - Basic

- Swivel and Tilt only
- No spring
- Extends 90 mm (3 9/16")

Material: Aluminum, die-cast; Pins: Stainless Steel

Color	Item No.
silver RAL 9006	818.11.976

Supplied With

4 M4 screws for screen attachment

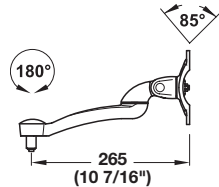

Medium Arm - Basic

- Economical option to Classic arm
- Extends 265 mm (10 7/16") at full extension

Material: Aluminum, die-cast; Pins: Stainless Steel

Color	Item No.
silver RAL 9006	818.11.959

Supplied With

4 M4 screws for screen attachment

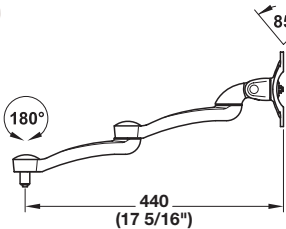
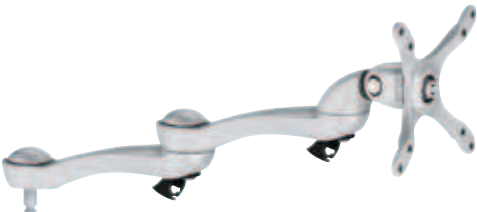

Long Arm - Basic

- Economical option to Classic arm
- Extends 440 mm (17 5/16") at full extension

Material: Aluminum, die-cast; Pins: Stainless Steel

Color	Item No.
silver RAL 9006	818.11.939

Supplied With

4 M4 screws for screen attachment

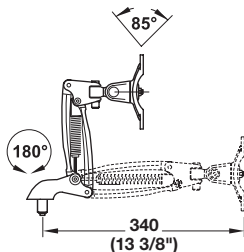

Medium Arm - Classic

- Full movement
- Extends 340 mm (13 3/8") at full extension

Material: Aluminum, die-cast; Pins: Stainless Steel

Color		Item No.
silver RAL 9006	3 - 5 kg (6.6 - 11 lbs.) (most 15" and 17" flat screens)	818.11.942
	5 - 7.5 kg (11 - 16.5 lbs.) (most flat screens up to 24")	818.11.952

Supplied With

4 M4 screws for screen attachment

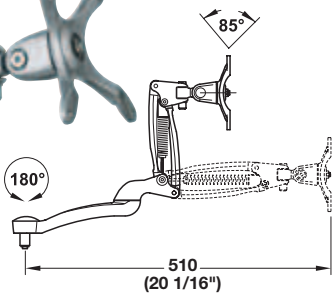
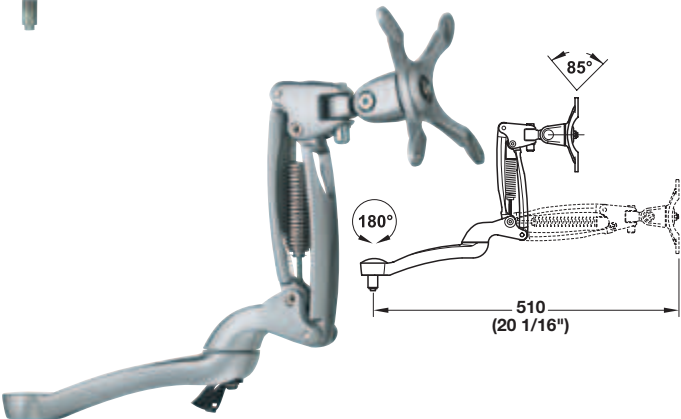

Long Arm - Classic

- Full movement
- Extends 510 mm (20 1/16") at full extension

Material: Aluminum, die-cast; Pins: Stainless Steel

Color		Item No.
silver RAL 9006	3 - 5 kg (6.6 - 11 lbs.) (most 15" and 17" flat screens)	818.11.903
	5 - 7.5 kg (11 - 16.5 lbs.) (most flat screens up to 24")	818.11.932

Supplied With

4 M4 screws for screen attachment

Note

Mounting posts and options to be ordered separately (refer to next page).

Ellipta® Accessories



Universal Mounting Post

- USB hub includes 4 (2.0) USB ports for quick and easy connection of peripherals
- Clamp mount to desk top, or through mount in a standard grommet hole up to Ø80 mm (3 1/8")
- Accommodates desk top thicknesses of 8 - 75 mm (5/16" - 3")
- 570 mm (22 1/2") post allows for stacking up to 4 monitors on a single post

Material: Aluminum, die-cast; Color: silver RAL 9006

Height	Item No.
260 (10 1/4")	818.11.881
570 (22 1/2")	818.11.883

Supplied With

Sliding clamp for arm attachment



Channels on the back for cable management

Mounting Posts

- Fits in mounting bases on the left (order separately)

Material: Aluminum, die-cast; Color: silver RAL 9006

Length	Item No.
250 (9 7/8")	818.10.901
530 (20 7/8")	818.10.902



Wall Mount Bracket

- Designed to attach the *ellipta* arm directly to the wall

Material: Aluminum, die-cast

Color	Item No.
silver RAL 9006	818.11.980

Note

Arm sold separately, refer to page 5.14.



Through-Mount Base

- Accepts mounting posts on the right (order separately)
- Secured through a standard Ø60 mm (2 3/8") grommet hole
- Maximum desktop thickness 50 mm (2")
- Recommended for heavier screens or multiple screen mount applications

Material: Aluminum, die-cast

Color	Item No.
silver RAL 9006	818.10.921



Clamp-Mount Base

- Accepts mounting posts on the right (order separately)
- Maximum desktop thickness, 50 mm (2")
- Not recommended for multiple screen mount applications

Material: Aluminum, die-cast

Color	Item No.
silver RAL 9006	818.10.920



Sliding Arm Clamps

- Used to attach monitor arms to post
- Adjust multiple arms independently on a single post
- Lever clamp action allows for quick height adjustment
- Sleeve protects the mounting post

Material: Aluminum, die-cast; Sleeve: Plastic
Color: silver RAL 9006

Version	Item No.
single	818.11.969
double	818.11.965

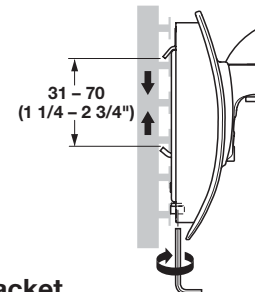

Universal Slat Wall Bracket

- Clamps into most existing slat walls
- 3-way adjustment, includes bubble level for exact leveling

Material: Aluminum, die-cast

Color	Item No.
silver RAL 9006	818.11.981

Supplied With

Bracket
Cover plate

Dimensions in mm
Inches are approximate

Monitor Suspension System

- Low voltage motor lifts and lowers flat screen monitor in top surface providing a safe, secure, and ergonomic solution for any working environment.
- Fits most flat panel displays up to 21" diagonal or 20" widescreen
- Retractable access doors open and close automatically
- Allows for additional work space when not in use
- Hides confidential information when necessary
- Reduces risk of damage to PC equipment
- Removes monitor from line-of-sight in the submerged position
- Max. dimensions for flat screen monitor (W x D x H): 470 x 356 x 70 mm (18 1/2" x 14" x 2 3/4")
- Weight of flat screen monitor cannot exceed 21 lbs. (9.5 kg)



Trolley E-Class

- Minimum work surface depth: 610 mm (24")
- Keyboard width: 711 mm (28")

Material: Steel, epoxy powder-coated; Trim Grommet: Plastic

Color	Item No.
black	639.93.010

Supplied With

Keyboard tray with locking slides
Removable metal front cover
Trim grommet
VESA mounting plates: 75 and 100 mm (3" and 4")
Mounting hardware
Instructions

Note

Detailed cut-out dimensions and mounting instructions are included with each set.

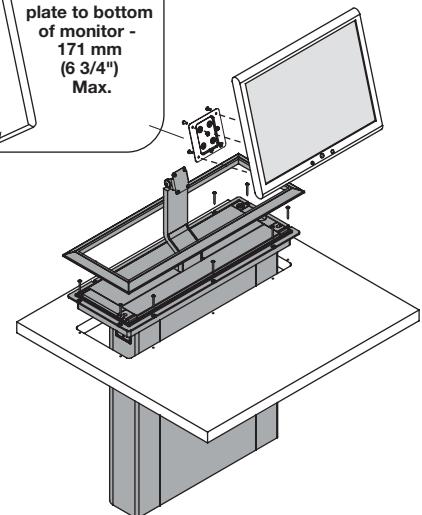
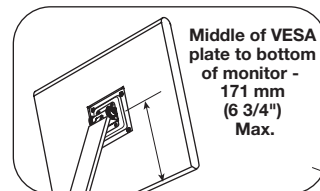
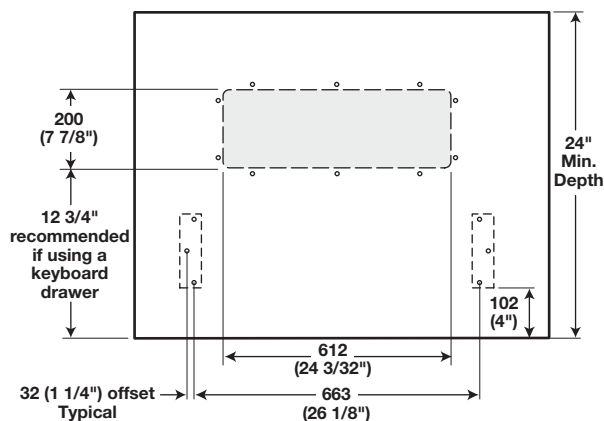
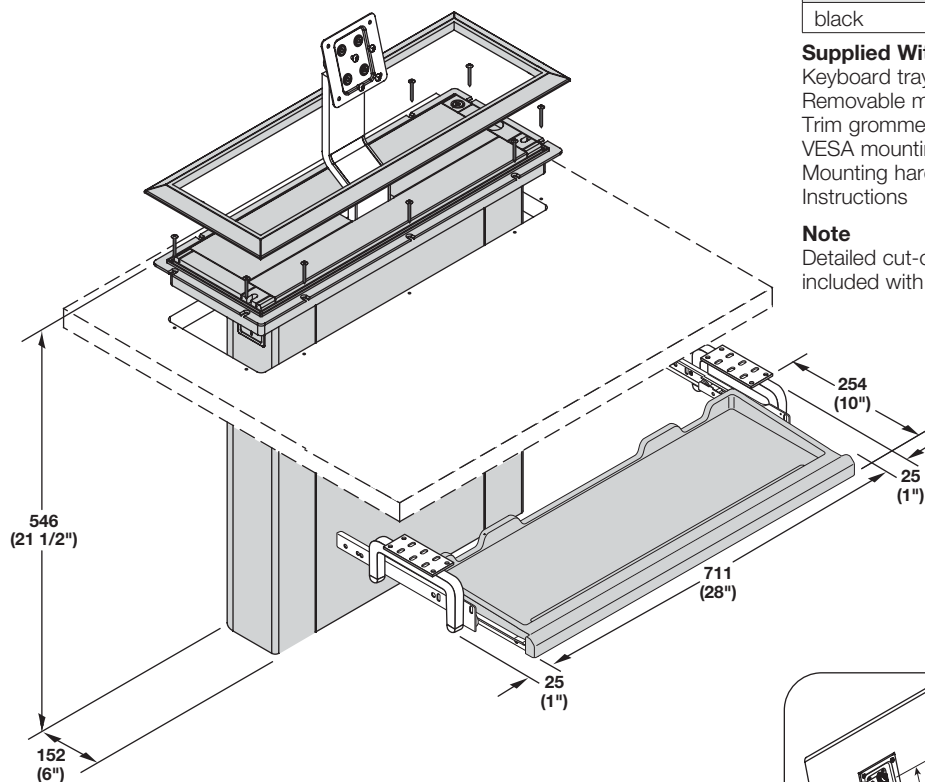

Dimensional data not binding. We reserve the right to alter specifications without notice.

Dimensions in mm
Inches are approximate

Monitor Suspension System

- Keyboard allows for a mouse to be used next to keyboard
- The same technology as the standard systems but designed to accept flat screen computer monitors
- Designed to fit monitors with max. dimension: 467 x 432 mm (18 3/8" x 17")

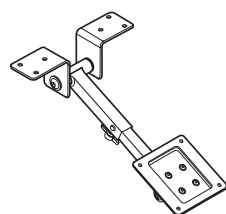
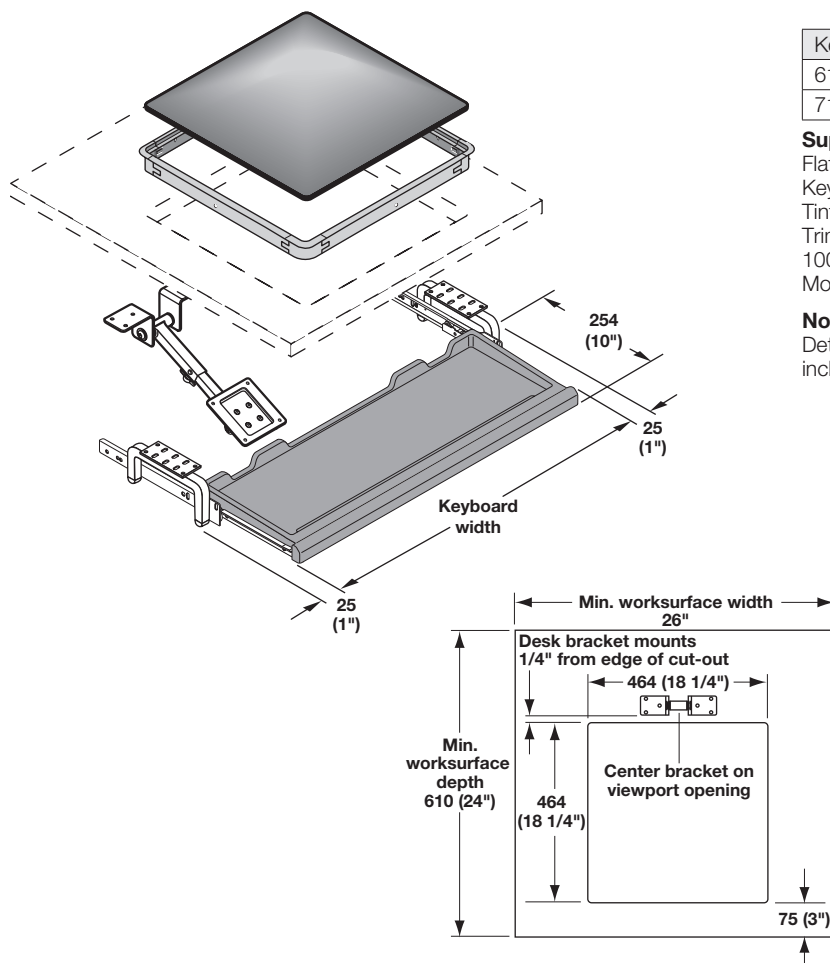

Flat Panel Display Arm

- Mounts underneath worksurface to support flat screen monitor on a tension-mounted arm
- Converts existing downview CRT monitor system to flat screen creating space below the worksurface
- Monitor attaches to flat panel arm with VESA compliant steel plate 100 mm (4")
- Weight capacity for monitor: 95 kg (21 lbs.)
- Arm length adjusts from 133 - 214 mm (5 1/4" - 8 7/16")

Material: Steel

Color	Item No.
black	639.91.378

System for Flat Screen Monitors

- Minimum work surface depth: 610 mm (24")
- Weight capacity for monitor: 9.5 kg (21 lbs.)
- Keyboard width: 711 mm (28")

Material: Steel, epoxy powder-coated
Glass, tinted and tempered
Trim Grommet: Plastic; Color: black

Keyboard tray width	Item No.
610 (24")	639.90.390
711 (28")	639.90.396

Supplied With

Flat panel arm
Keyboard tray with locking slides
Tinted and tempered glass (1/4" thick) viewing surface
Trim grommet
100 mm (4") VESA mounting plate
Mounting instructions

Note

Detailed cut-out dimensions and mounting instructions are included with each set.

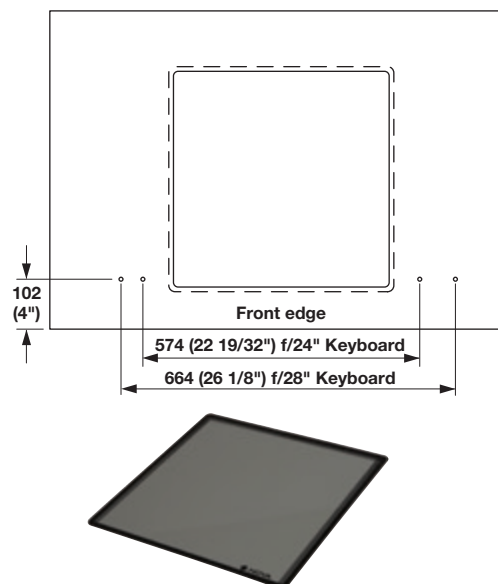

Replacement Glass Viewport

- Tinted and tempered (standard)
- W x D x H: 457 x 457 x 6 mm (18" x 18" x 1/4")

Item No.
639.91.300

Note

Standard kits come complete with a viewport which is tinted (T141 rating) and tempered.

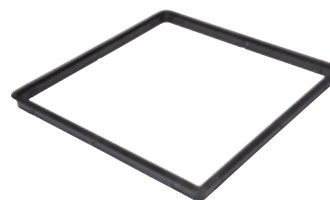

Replacement Trim Grommet

W x D x H: 457 x 457 x 6 mm (18" x 18" x 1/4")

Material: Plastic

Color	Item No.
black	639.91.350

Dimensions in mm
Inches are approximate

CPU Holders

5

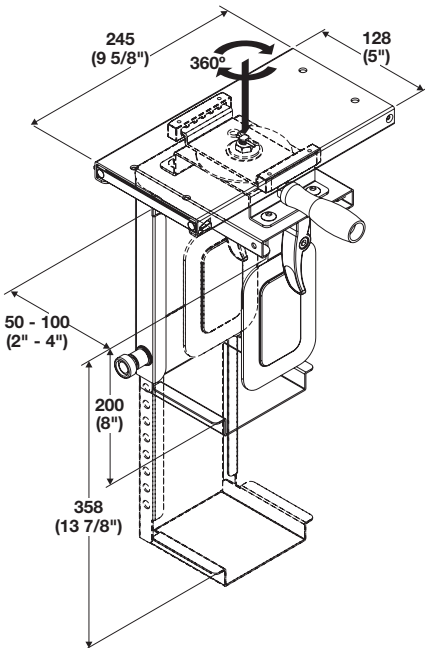
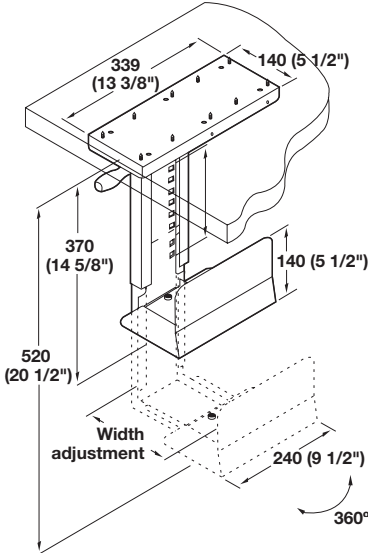
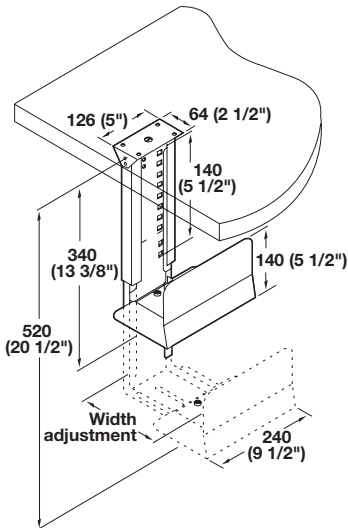

CPU Holder Fixed Mount

- Securely clamps and holds CPU
 - Holds CPU's up and away from shoes, dust, moisture, vacuum cleaners or mops
- Weight capacity: 25 kg (55 lbs.)
Height adjustment: 340 - 521 mm (13 3/8" - 20 1/2")

Material: Steel; Color: black epoxy

Width Adjustment	Item No.
140 - 235 (5 1/2" - 9 1/4")	639.72.300
70 - 133 (2 3/4" - 5 1/4")	639.72.320

CPU Holder with Swivel and Extension

- 360° swivel provides easy access to connections on the rear of CPU
 - Provides 216 mm (8 1/2'') of travel for easy access to connections on rear of CPU
- Weight capacity: 25 kg (55 lbs.)
Height adjustment: 371 - 521 mm (14 5/8" - 20 1/2")
Width adjustment: 140 - 235 mm (5 1/2" - 9 1/4")

Material: Steel

Color	Item No.
black epoxy	639.72.310

CPU Holder with Swivel and Extension

- Adjustment range for smaller CPUs
 - Quick-release pin for easy height adjustment
 - Innovative lever adjustment for quick and secure width adjustment, custom fit to various CPU sizes
 - 360° swivel provides easy access to connections on the rear of CPU
 - Track provides 155 mm (6'') of travel
- Weight capacity: 10 kg (22 lbs.)
Width adjustment: 50 - 100 mm (2" - 4")
Height adjustment: 200 - 358 mm (8" - 13 7/8")

Material: Steel

Color	Item No.
black	639.72.350

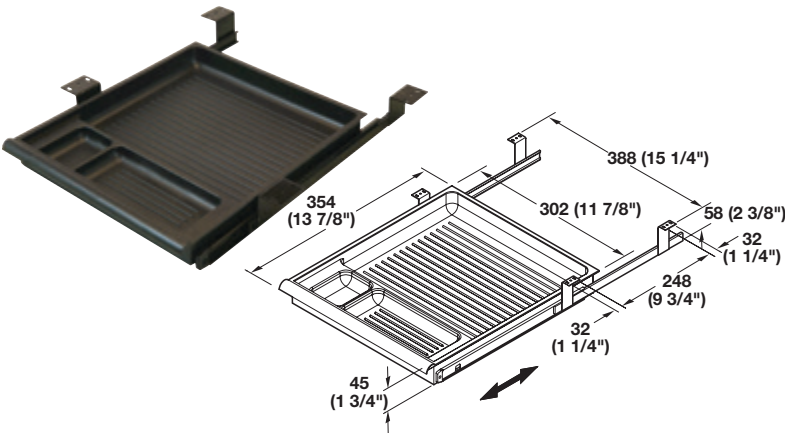

Pencil Drawer

- 3 compartments
 - Ball bearing slides, with both hold-in and hold-out detents
 - Completely assembled
 - Minimum width required for installation: 387 mm (15 1/4")
- Installed depth: 387 mm (15 1/4")
Extended depth: 660 mm (26")

Material: Tray: Plastic; Slides: Steel

Color	Item No.
black	429.59.340

Supplied With
Mounting hardware

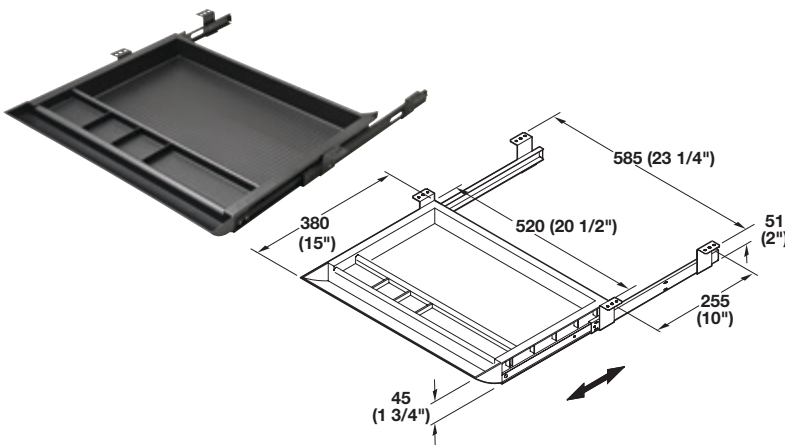

Pencil Drawer

- 5 compartments
 - With ball bearing slides
 - Simple assembly required
 - Minimum width required for installation: 591 mm (23 1/4")
- Installed depth: 463 mm (18 1/4")
Extended depth: 737 mm (29")

Material: Tray: Plastic; Slides: Steel

Color	Item No.
black	429.59.350

Supplied With
Mounting hardware

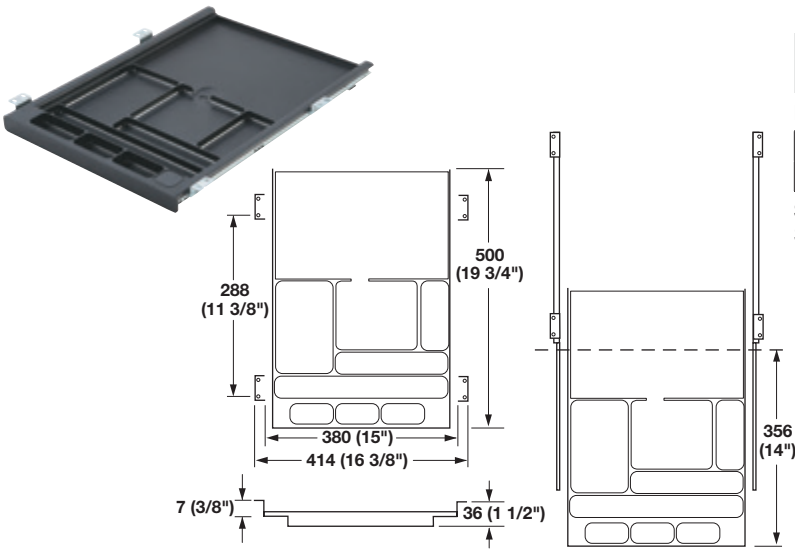
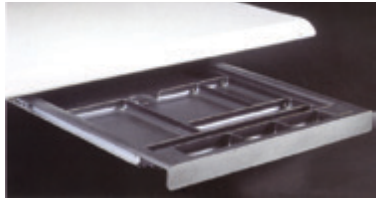

Pencil Drawer

- 9 compartments
- With ball bearing slides

Material: Tray: Plastic, textured; Slides: Steel

Color	Item No.
black	429.57.300

Supplied With
Screws

Dimensional data not binding. We reserve the right to alter specifications without notice.

Frame for Wood or Metal Drawers

- Inside drawer height of 222 mm (8 3/4") required
- Smooth surface allows files to glide with ease
- Rigid profile handles heavy loads
- Adjusts between filing configurations without tools
- Cross rails "snap" into fixed positions
- Cut-to-size side rails allow you to customize any drawer
- Two or more kits may be combined for use in wide lateral file drawers



5



File Frame Kit

Letter Width File Drawer Requirements:

- Inside width greater than 305 mm (12");
- Inside depth less than 584 mm (23")

Legal Width File Drawer Requirements:

- Inside width greater than 381 mm (15");
- Inside depth less than 584 mm (23")

Material: Profile: Steel

Ends: Plastic; Color: black

Size	Item No.
letter width	422.74.310
legal width	422.74.320

Supplied With

- 2 Fixed front rails
- 2 Cut-to-size side rails
- 2 Attachment brackets
- Divider

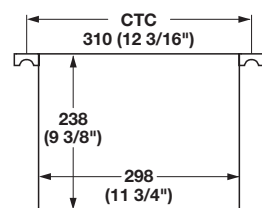

Typical LETTER file dimensions

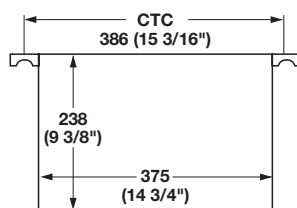

Typical LEGAL file dimensions

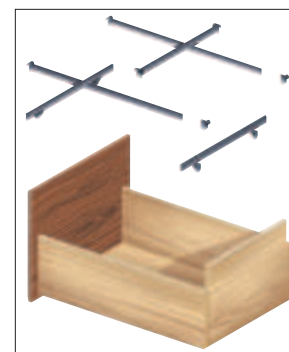
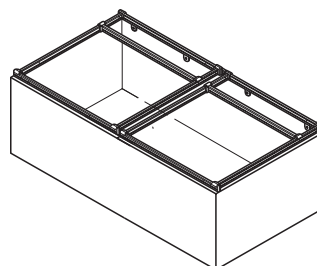

Depending on your drawer size, the following file configuration may be possible:

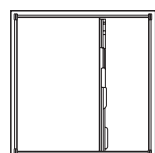

Side to Side Legal

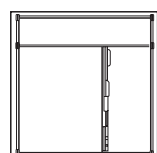

Side to Side Letter

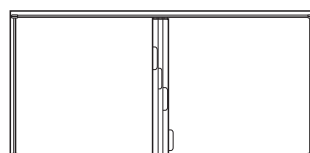

Side to Side Legal

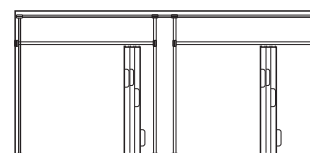

Side to Side Letter

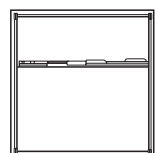

Front to Back Legal

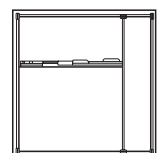

Front to Back Letter

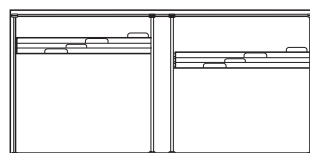

Front to Back Legal

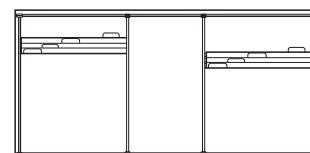

Front to Back Letter

- Simple, flexible solution for mounting into any file drawer
- No cutting or grooving required to install
- Flush mount or top mount to drawer side, front, or back
- Accepts 3 mm (1/8") file bar
- Produced from 16 gauge steel

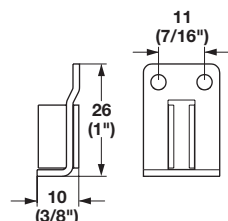

Bracket

- Flush mount
- Screw-mounted

Material: Steel

Finish	Item No.
zinc-plated	424.31.900
black oxide	424.31.300

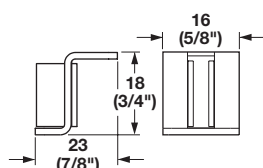

Bracket

- Top mount
- Screw-mounted

Material: Steel

Finish	Item No.
zinc-plated	424.31.910
black oxide	424.31.310

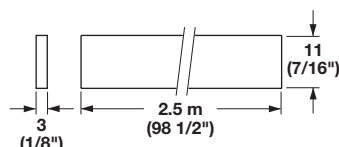

Cross Rail

- Fits in brackets above
- Easily cut to length for your application

Material: Aluminum, unfinished

Item No.
422.74.900

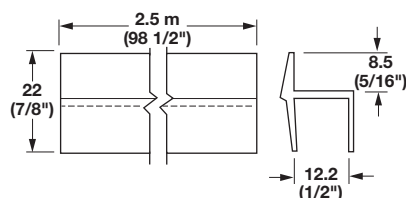

Rail

- Snaps onto 12 mm (1/2") drawer sides, requiring no glue or staples
 - Add clips and cross rails to accommodate different sized drawers and file sizes
- Length: 2.5 m (98 1/2")

Material: Plastic

Color	Item No.
black	422.72.381
white	422.73.790

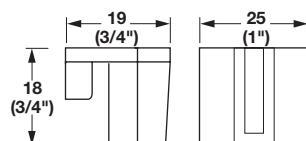

Rail Clip

- Hangs over file rail (above), allowing files to be hung at 90° angle to rails

Material: Plastic

Color	Item No.
black	422.73.300

Supplied With

10 pcs.

Aluminum Rail

- Without holes; drill holes where needed
- Length: 2.5 m (98 1/2")

Material: Aluminum, anodized

Color	Item No.
black	422.71.303
satin silver	422.71.902

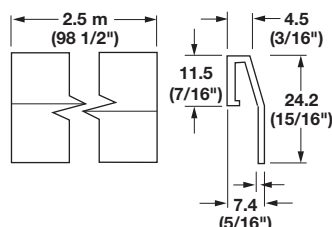

Pan head screws

pages 11.134-11.135

Dimensions in mm
Inches are approximate

- For home/small office, cabinets, etc.



5



Power Bar, 3 Outlets, 2 Data Modules

Material: Plastic, high impact

Color	Item No.
black	822.81.321

Supplied With

3 Grounded AC outlets
Rating 125V, 60Hz, 12A
10' Power cord
Cords exit from bottom
2 Data modules: 1 RJ 11 Cat. 3 with 14' cord
1 Ethernet jack with 14' cord

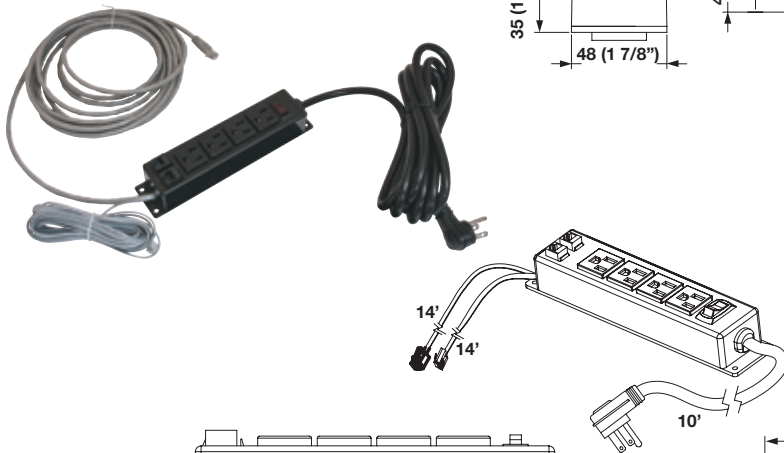
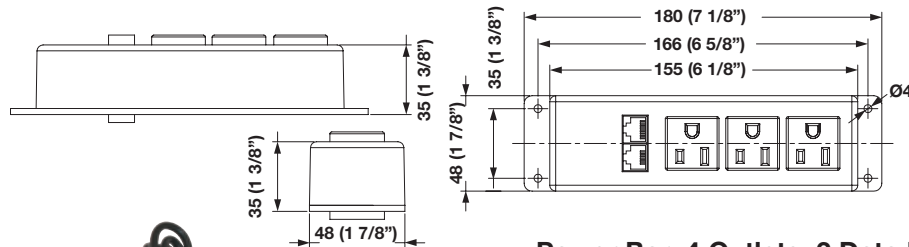

Power Bar, 4 Outlets, 2 Data Modules

Material: Plastic, high impact

Color	Item No.
black	822.81.331

Supplied With

4 Grounded AC outlets
Rating 125V, 60Hz, 12A
Overload protection with reset switch
10' Power cord
Cords exit from ends
2 Data modules: 1 RJ 11 Cat. 3 with 14' cord
1 Ethernet jack with 14' cord

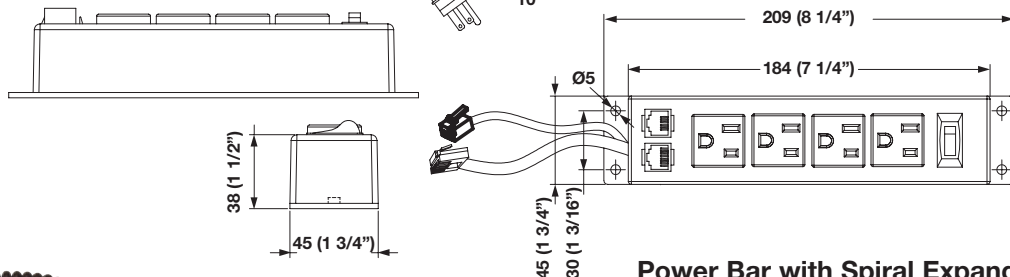

Power Bar with Spiral Expandable Cord

- Ideal for use with Adjustable Table Systems
- With 6 tamper resistant grounded AC outlets
- Overload protection with reset switch
- Rating: 125V, 60Hz, 15A
- Screw mounted
- Cord length:
Relaxed: 5'
Fully extended: 10'

Material: Plastic

Color	Item No.
black	822.09.340

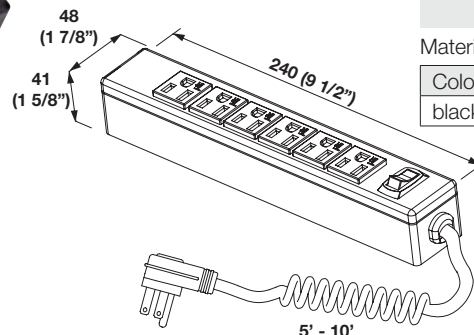

Dimensions in mm
Inches are approximate

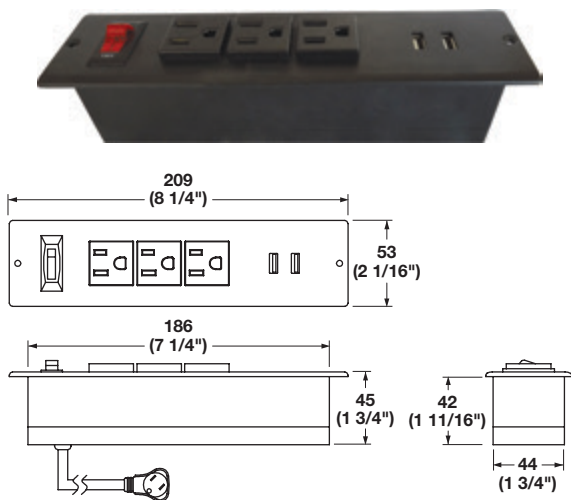

Power Bar - Triple Outlet

- With 2 5V DC 2.1A USB charger with 2 charging ports
- 3 AC outlets
- Rating: 125V 60Hz 12A
- Face plate mounting
- 10' 14 AWGx3C power cord
- Overload protection with reset switch
- Bore hole: 7.4" x 1.7" for installation

Material: Plastic

Color	Item No.
black	822.09.310

5

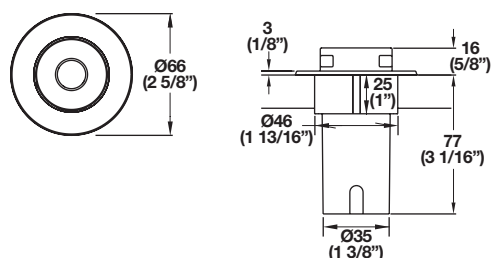

Requires a 47 mm hole in work surface for mounting

Pop-Up USB Charging Center

- Unique pop-up design for charging devices such as lap tops, tablets, phone, cameras, MP3 players, etc.
- With 2 USB charging ports 2.0A
- UL Listed
- Requires a Ø47 mm (1 7/8") hole for screw-mounting

Material: Plastic - Metal Surface Look

Color	Item No.
silver	822.64.033

Supplied With

2 m Lead with transformer
2 m Lead from unit
Trim Ring



Charging Grommets

- Easily replace a standard Ø60 mm (2 3/8") desktop cable grommet
- With cable opening and removable tab to feed cables through
- Two options to accommodate your charging needs
- UL Listed

Material: Plastic; Color: black

Model	Item No.
1-120V socket and 1-USB charging port 2.0A	822.99.350
2-USB charging ports 2.0A	822.99.351

Supplied With

Wall transformer
822.99.350 supplied with 10A X 1.5 m power cable and 1 m USB cable
822.99.351 supplied with 1 m USB cable

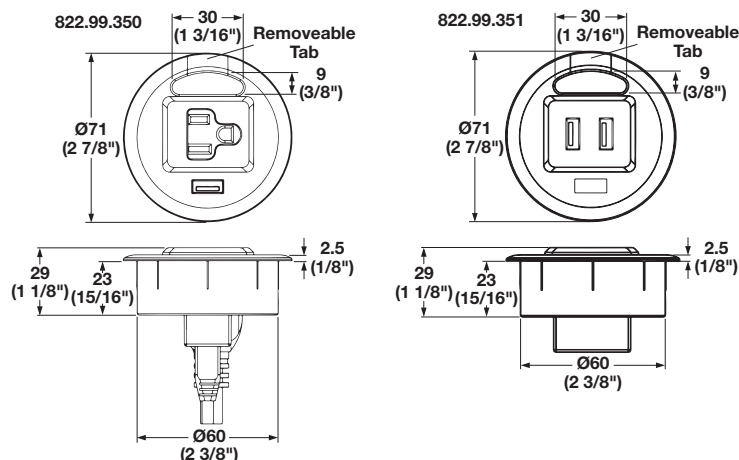

Dimensions in mm
Inches are approximate

Dimensional data not binding. We reserve the right to alter specifications without notice.



Top view of closed docking stations

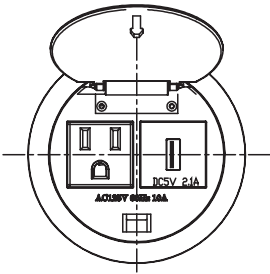

Docking Station 250

- Touch release spring-loaded lid
- 1 AC outlet, 125V 10A rating
- 1 USB charging port 2.1A
- Ø76 mm (3") hole required for installation

Material: Plastic

Color	Item No.
black	822.99.330

Supplied With
10' Power cord

5

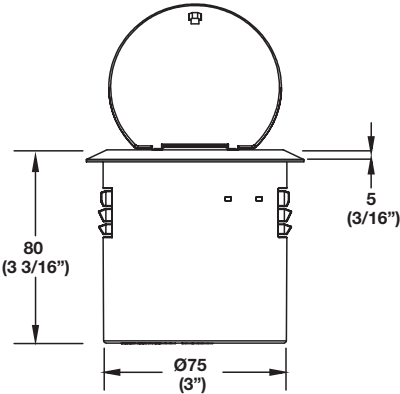

Dimensional data not binding. We reserve the right to alter specifications without notice.



5



Table Cutout (fits surface thicknesses up to a max. of 1 1/8")

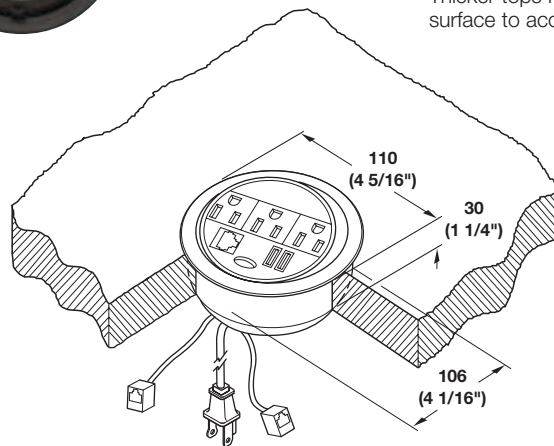
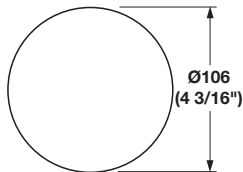

Power/Data Station

- Table top flip unit, 12A, 125V, with 3 grounded outlets, 2 USB 2.1A powered outlets and a universal data module for either RJ-11 Cat. 3 or RJ-45 Cat. 5 connections
- Easily swivels to a closed position when not in use
- UL listed

Material: Plastic

Color	Item No.
black	822.88.300

Supplied With

10' Power cord

Note

Thicker tops require grooving on the bottom of the work surface to accommodate wiring.



Table Cutout (fits surface thickness up to 1 1/8")

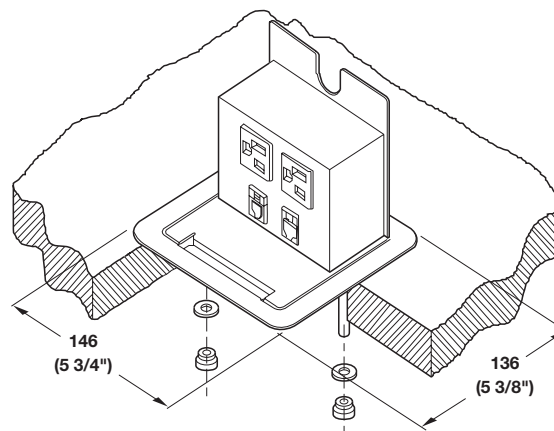
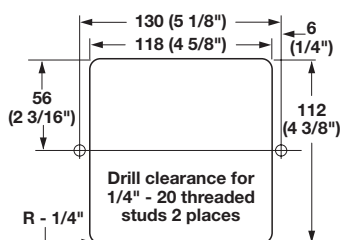

Power/Data Center - Interact JR

- UL and CSA listed: UL 1363 - relocatable power tap, E 164157

Material: Steel, epoxy-coated

Color	Item No.
black textured	822.74.300

Supplied With

Table top flip up unit, 15A, 125V, with 2 grounded outlets
RJ-11 Cat. 3 module
RJ-45 Cat. 6 module
6' Power cord

Dimensions in mm
Inches are approximate

- For home/small office, hotel furniture or cabinets
- Suitable for commercial applications
- A convenient power and/or communications terminal
- Flexible configurations to meet your needs
- Easily closes and hidden when not in use
- Simply press on the lid and the Dock-700 smoothly opens
- Great for charging iPhones, smart phones, iPads, tablets, digital cameras and other USB chargeable devices
- With 10 ft. power cord
- Requires approx. 102 mm (4") of space under worksurface

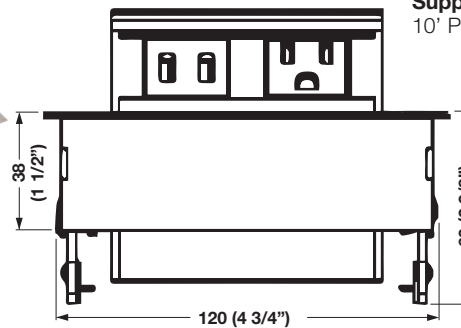
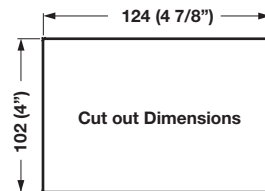
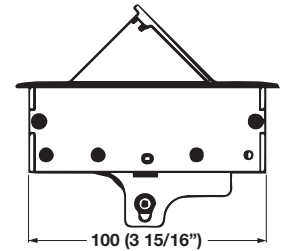

Hide-A-Dock With 1 Outlet, 2 USB Ports

- 1 grounded AC outlet, 125V 12A rating
- 5V DC 4.2 A USB charger with 2 ports

Material: Housing: Aluminum

Color	Item No.
black	822.09.330
silver	822.09.930

Supplied With
10' Power cord

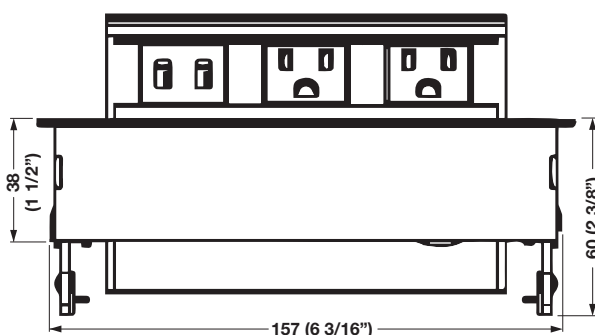
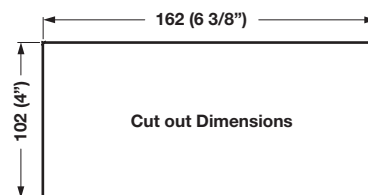
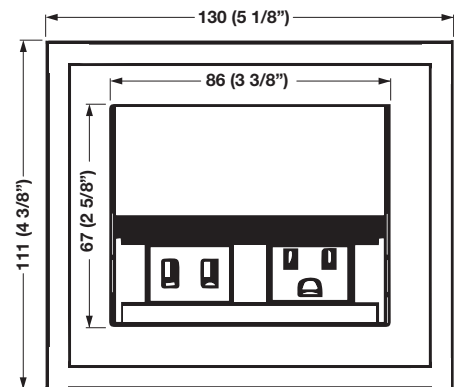

Hide-A-Dock With 2 Outlets, 2 USB Ports

- 2 grounded AC outlets, 125V 12A rating
- 5V DC 4.2A USB charger with 2 ports

Material: Housing: Aluminum

Color	Item No.
black	822.09.331
silver	822.09.931

Supplied With
10' Power cord

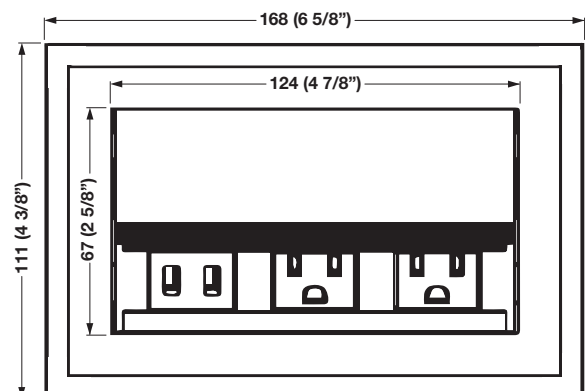

Dimensions in mm
Inches are approximate

Dimensional data not binding. We reserve the right to alter specifications without notice.

Dock 1100 - Flush Mount

5

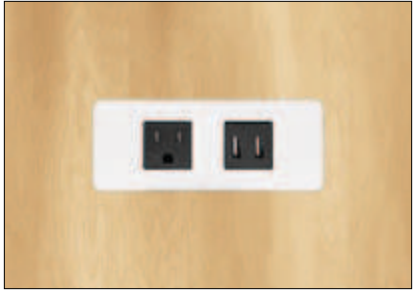

Flush Mount Power and Data Module

- 1 tamper resistant grounded AC outlet, 125 V 15 A Max
- 2 USB ports 5 V DC 4.2 A
- Cord length 10'
- Through-bolt mounted

Material: Housing, Aluminum

Finish	Item No.
black	822.09.350

Note
Order Face Plates separately, see below.

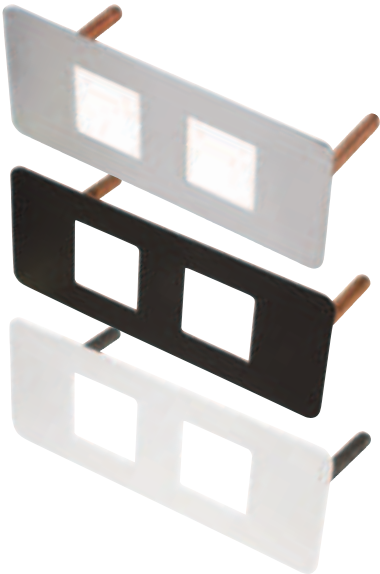
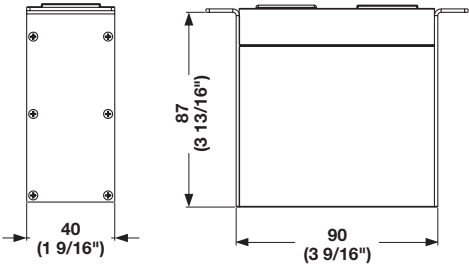
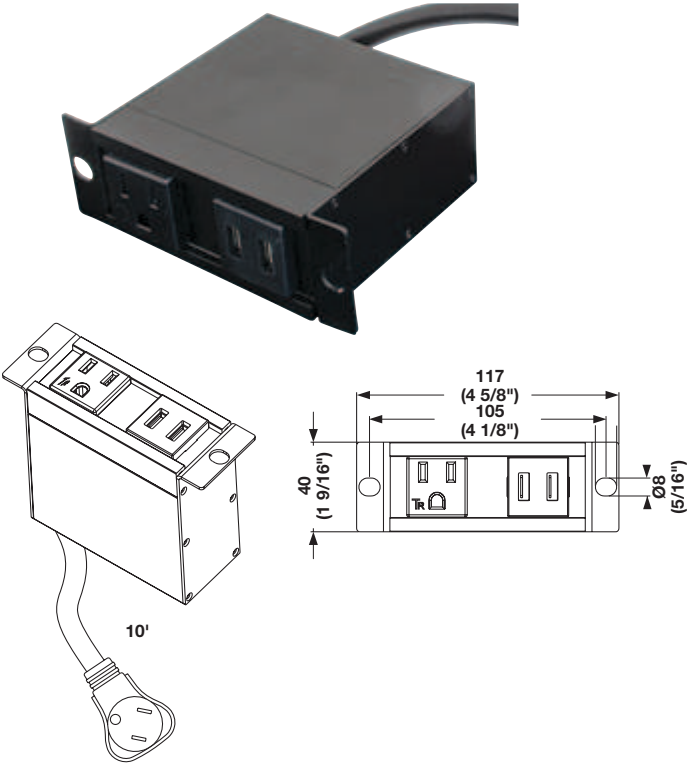

Flush Mount Face Plates

Material: Steel, epoxy-coated

Finish	Item No.
black	822.09.360
white	822.09.760
silver	822.09.960

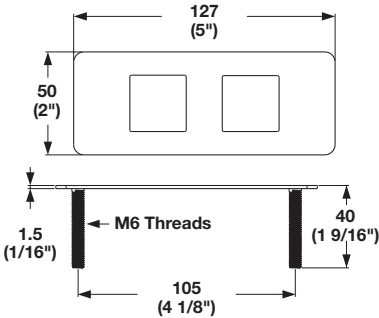

Dimensions in mm
Inches are approximate

Angled Surface Mount Power and Data Stations

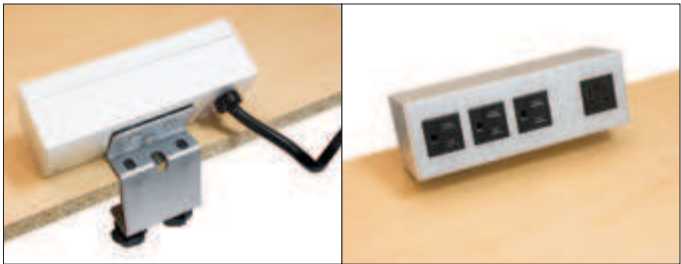

5

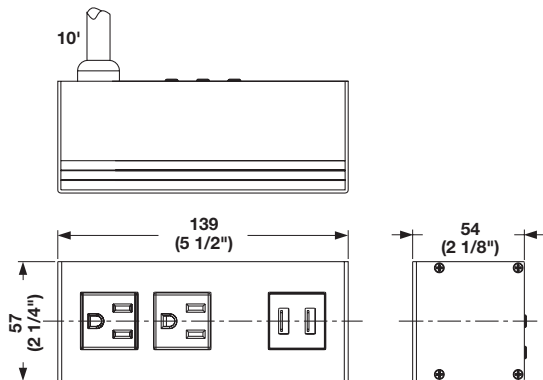

Dock 2110

- 2 tamper resistant grounded AC outlets, 125 V 15 A Max
- 2 USB ports 5 V DC 4.2 A
- Cord length 10'

Material: Housing, Aluminum, epoxy-coated

Finish	Item No.
black	822.09.370
white	822.09.770
silver	822.09.970

Note

Order Surface Mount Brackets separately below.

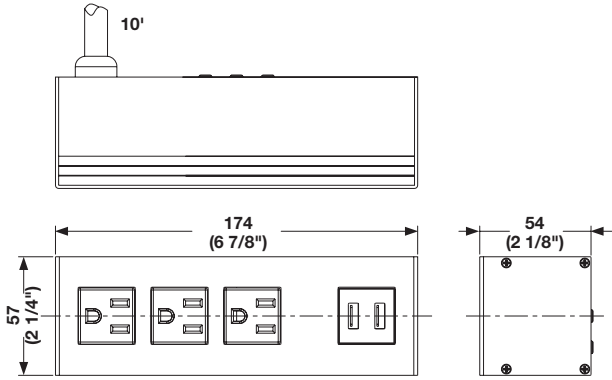

Dock 3110

- 3 tamper resistant grounded AC outlets, 125 V 15 A Max
- 2 USB ports 5 V DC 4.2 A
- Cord length 10'

Material: Housing, Aluminum, epoxy-coated

Finish	Item No.
black	822.09.371
white	822.09.771
silver	822.09.971

Note

Order Surface Mount Brackets separately below.

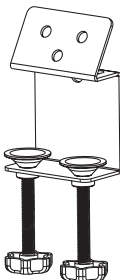
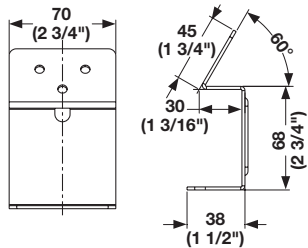

Angled Surface Mount Brackets

- Clamp mounts to desk
- Maximum clamping thickness: 50 mm (2'')
- Includes bolts to attach power and data station above

Material: Aluminum

Finish	Item No.
black	822.09.372
white	822.09.772
silver	822.09.972

Dimensional data not binding. We reserve the right to alter specifications without notice.

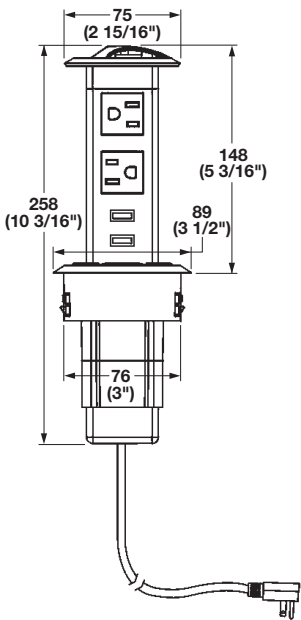

Pop-Up Power Station

- 2 - AC receptacles, 120V / 60Hz
- 2 - USB 2.1A charging ports
- Ø76 mm (3") hole for installation
- Requires 305 mm (12") space under work surface

Material: Plastic

Color	Item No.
black	822.99.340

Supplied With
6' Power cord

Note
USB ports charge through the unit's power cord.

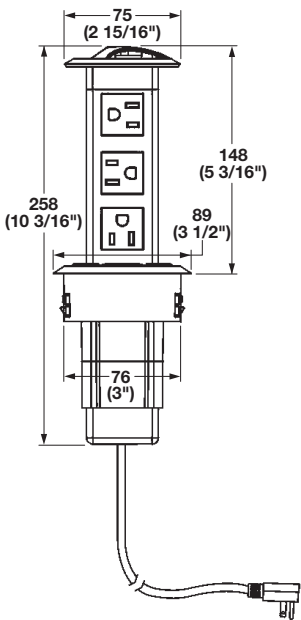

Pop-Up Power Station

- 3 outlets
- AC 125V 12A Max.
- Ø76 mm (3") hole for installation
- Requires 305 mm (12") space under work surface

Material: Plastic

Color	Item No.
black	822.99.320

Supplied With
6' Power cord



5

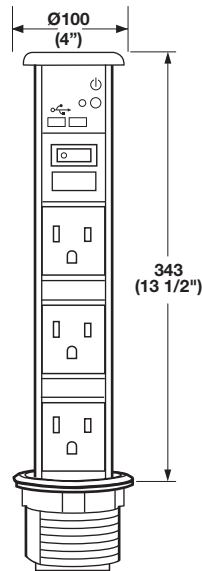

SensioPod Vertical Powerdock

- Ideal for kitchens, offices, hotel rooms, dorm rooms, etc.
- Includes an On/Off switch
- Two USB charging ports 2.0A
- Three power sockets, 120V - 10A
- IP54 Rated- splash proof in retracted position
- 337 mm (13 1/4'') space required above surface
- 362 mm (14 1/2'') required below
- Requires a Ø90 - Ø92 mm (Ø3 9/16" - Ø3 5/8'') hole for installation
- Power cord length: 2438 mm (8')

Material: Plastic

Color	Item No.
black & aluminum with chrome top	822.82.930
black & aluminum with black top	822.82.330

Supplied With

8' Power cord

Note

To use SensioPod in a kitchen or bathroom countertop application, plug power cord into a GFCI (ground fault circuit interrupter) outlet.

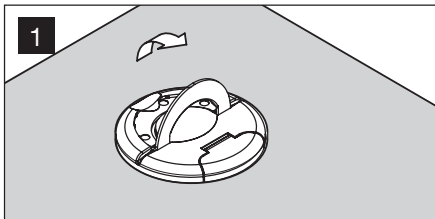

To use the Pop-up socket, gently lift up the handle on the top cover until all socket outlets are exposed and the green stop/release button clicks and locks in place.

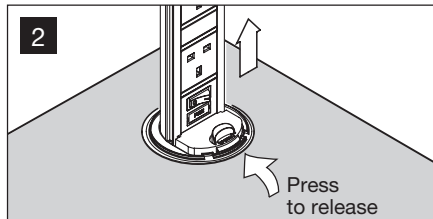

Press the master switch on. A green light confirms that the power is available. You can use all power sockets. The unit can be retracted in position by pressing the green stop/release button and pushing the unit down until it's flush with the surface, leaving the engaged cables on the window of the top cover.

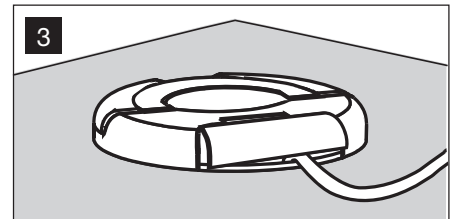

Insert SensioPod into the hole to discreetly hide away when not in use.

Dimensional data not binding. We reserve the right to alter specifications without notice.

Docking Drawer from HÄFELE

How to choose a Docking Drawer Outlet

Are you creating an in-drawer charging station to declutter a drawer in your kitchen? Or an in-drawer outlet to power your hair dryer, curling iron, or other small appliances?

Häfele offers two types of Docking Drawer Outlets: **Charging** (Max Current = 3 amps) and **Powering** (Max Current = 20 amps).

Charging Outlets

Designed to charge today's technology; commonly specified into kitchens, desks, mudrooms, closets, and nightstands to create a clutter-free charging space. Charging outlets feature a UL-Listed circuit breaker to prevent high-power devices from being used – Charging outlets will not power a hair dryer, mixer or other high-power devices.

Powering Outlets

These outlets are typically specified into a bathroom vanity, or a vertical kitchen tower. They can power hair dryers, curling irons, mixers and more. All powering outlets feature a UL-Listed thermostat that cuts power to the outlet in the event that the surrounding temperature exceeds 120°F, helping to minimize risk with devices that are accidentally left on or still plugged in when the drawer is closed.

Measure your Cabinet

Docking Drawer outlets come in a variety of sizes offering different ranges of extensions. See below to find the size that works for you.



5

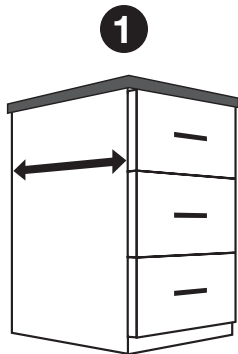

Start your project by measuring the cabinet depth.

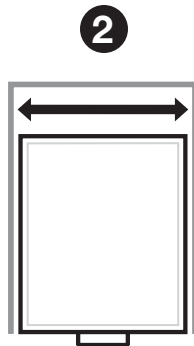

Measure the outer dimension of the drawer box width.

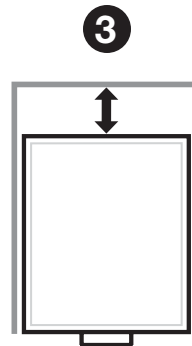

Then measure the space available behind the drawer box.

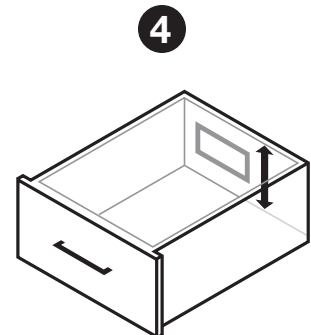

Then measure the interior drawer box height.

Docking Drawer Charging Series

Blade series are designed to charge and power today's technology such as Cell Phones, Tablets and Laptops in Kitchens, Desks, Closets, Furniture. Maximum output is 3 amps therefore cannot be used for items such as Hair Dryers, Curling Irons or Small Kitchen Appliances.

Blade Mounting Details

- For ≤ 24" cabinet depths, minimum drawer box with (OD) ≥ 15"
- Minimum space behind drawer box: 2"
- Minimum interior drawer box height: 3"

Blade Product Details

- Mounts horizontally or vertically
- Works with side mount, under mount and soft closing slides
- A standard 15 amp household outlet is required and must be within 4 1/2' of the cabinet
- Dishwasher, Disposal, Instant Hot Water or Trash Compactor outlets cannot be plugged into Docking Drawer outlets
- Tamper resistant outlets with circuit breaker
- Max. current: AC 3 amps @120 VAC
- USB 3.6 amps @ 5VDC
- ETL listed to UL962a
- 4 1/2" NEMA 5-15P power cord

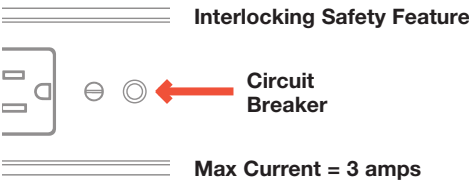

5



Docking Drawer Blade

- With 2 x AC Outlets and 2 x USB Ports

Color	Item No.
black	822.53.160
white	822.53.161
stainless steel	822.53.162



Docking Drawer Blade USB

- With 4 x USB Ports Maximum Current 4.2 amps @ 5VDC

Color	Item No.
black	822.53.163
white	822.53.164
stainless steel	822.53.165



Docking Drawer Blade Duo

- With 2 x AC Outlets and 6 x USB Ports

Color	Item No.
black	822.53.166
white	822.53.167
stainless steel	822.53.168



Docking Drawer Blade Duo 4 X 4

- With 4 x AC Outlets and 4 x USB Ports

Color	Item No.
black	822.53.175
white	822.53.176
stainless steel	822.53.177

Dimensional data not binding. We reserve the right to alter specifications without notice.

Dimensions in mm
Inches are approximate

Docking Drawer Powering Series

Style powering 20 amp outlets are designed to power Hair Dryers, Curling Irons and Small Kitchen Appliances in Bathrooms, Kitchens, Furniture, and Drawers. Style features a UL listed thermostat that cuts power to the outlet in the event that the surrounding temperature exceeds 120° F.

Style Mounting Details

- Minimum space behind drawer box: 2"
- Minimum interior drawer box height: 4" - 5.25"

Style Product Details

- Hardwired
- Power any device up to 20A
- Mounts horizontally or vertically
- Works with side mount, under mount and soft closing slides
- Tamper resistant GFCI protected outlets with manual reset thermostat
- Max. current: AC 20 amps @120 VAC, USB 3.6 amps @ 5VDC
- All models are ETL listed to UL962a
- 4 1/2' Power Cord



Interlocking Safety Feature

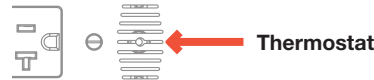

Max Current = 20 amps



Docking Drawer Style 24 Blade

- With 2 x AC GFCI Outlets with Thermostat Reset Feature
- For $\leq 24"$ cabinet depths, minimum drawer box with (OD) $\geq 16"$ - $\geq 19.75"$

Color	Item No.
black	822.53.136
white	822.53.137
stainless steel	822.53.138



Docking Drawer Style 24 Blade Duo

- With 4 x AC GFCI Outlets with Thermostat Reset Feature and 2 x USB Ports
- For $\leq 24"$ cabinet depths, minimum drawer box with (OD) $\geq 16"$ - $\geq 19.75"$

Color	Item No.
black	822.53.186
white	822.53.187
stainless steel	822.53.188



Docking Drawer Style 21 Blade

- With 2 x AC GFCI Outlets with Thermostat Reset Feature
- For $\leq 21"$ cabinet depths, minimum drawer box with (OD) $\geq 14.5"$ - $\geq 18.25"$

Color	Item No.
black	822.53.133
white	822.53.134
stainless steel	822.53.135



Docking Drawer Style 21 Blade Duo

- With 4 x AC GFCI Outlets with Thermostat Reset Feature and 2 x USB Ports
- For $\leq 21"$ cabinet depths, minimum drawer box with (OD) $\geq 14.5"$ - $\geq 18.25"$

Color	Item No.
black	822.53.183
white	822.53.184
stainless steel	822.53.185

Docking Drawer Powering Series

Style powering 20 amp outlets are designed to power Hair Dryers, Curling Irons and Small Kitchen Appliances in Bathrooms, Kitchens, Furniture, and Drawers. Style features a UL listed thermostat that cuts power to the outlet in the event that the surrounding temperature exceeds 120° F.

Style Flush Mounting Details

Minimum space behind drawer box: 5"
Minimum interior drawer box height: 4"

Style Product Details

- Hardwired
- Power any device up to 20A
- Mounts horizontally or vertically
- Works with side mount, under mount and soft closing slides
- Tamper resistant GFCI protected outlets with manual reset thermostat
- Max. current: AC 20 amps @120 VAC
- All models are ETL listed to UL962a
- 4 1/2' Power Cord

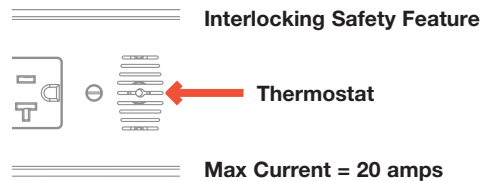

Docking Drawer Style 24 Flush

- With 2 x AC GFCI Outlets with Thermostat Reset Feature
- For ≤ 24 " cabinet depths, minimum drawer box with (OD) ≥ 13.5 "

Color	Item No.
black	822.53.017
white	822.53.018
stainless steel	822.53.073

Docking Drawer Style 21 Flush

- With 2 x AC GFCI Outlets with Thermostat Reset Feature
- For ≤ 21 " cabinet depths, minimum drawer box with (OD) ≥ 12 "

Color	Item No.
black	822.53.019
white	822.53.020
stainless steel	822.53.072

Docking Drawer Style 18 Flush

- With 2 x AC GFCI Outlets with Thermostat Reset Feature
- For ≤ 18 " cabinet depths, minimum drawer box with (OD) ≥ 10.5 "

Color	Item No.
black	822.53.027
white	822.53.028
stainless steel	822.53.053

Dimensional data not binding. We reserve the right to alter specifications without notice.

Docking Drawer Blade with USB-C (PD) Power Delivery



5

Benefits of Docking Drawer series with USB-C with Power Delivery:

Faster

USB-C (PD) can charge your device up to 70% faster than standard 12W charging found in USB-A ports. This means your devices will need less time to reach a full charge. A quick 10-minute charge with USB-C (PD) might be all you need to get going.

More Powerful

With up to 2X more power than typical USB ports, Docking Drawer with USB-C (PD) have up to 30W of power available and can charge larger devices like tablets and laptops with just a USB-C cable.

Safer

Docking Drawer series with USB-C (PD) contain a smart chip which makes charging safer with 3 key features:

- Recognizes and optimizes the charging requirements for each individual device and is especially designed to handle new higher levels of power.
- Built-in overcurrent protection safely keeps devices from receiving too much power.
- Features an internal thermoregulator to prevent electronics from overheating, which USB-A cannot do.

Note: All product specifications and mounting details are the same for all Blade Models - See previous pages for details.



Docking Drawer Blade USB-C (PD)

- With 2 x AC Outlets and 2 x USB-C (PD) Ports

Color	Item No.
black	822.53.210
white	822.53.211
stainless steel	822.53.212



Docking Drawer Blade Duo USB-C (PD)

- With 2 x AC Outlets, 4 x USB-A and 2 x USB-C (PD) Ports

Color	Item No.
black	822.53.213
white	822.53.214
stainless steel	822.53.215



LED Desktop Lamp TL-1000

- Adjustable and flexible arm
 - With 7 dimming levels
 - Glare, flicker, shadow and UV free
 - Light source: LED array
 - Color temperature: 4,000 – 4,500K
 - Lumen output: 300 lumens
 - Power input: AC 100-240V power adapter with DC 12V 1A output
- Height: At 90° = 14", Extended = 25 3/4"
Base: 4 1/2" diameter

Finish	Item No.
white	833.42.120

5



LED Desktop Lamp TL-2000

- Built-in USB charger – DC 5V, 0.7A Max.
 - Adjustable arm
 - With 5 dimming levels
 - Glare, flicker, shadow and UV free
 - Light source: LED array
 - Color temperature: variable; 5 preset modes
 - Lumen output: 300 lumens
 - Power input: AC 100-240V power adapter with DC 12V 1.5A output
- Height: At 90° = 17", Extended = 25 3/4"
Base: 6 1/2" diameter

Finish	Item No.
white	833.42.121



LED Desktop Lamp TL-3000

- Built-in USB charger – DC 5V, 0.7A Max.
 - Adjustable arm
 - With 5 dimming levels
 - Glare, flicker, shadow and UV free
 - Light source: side-emitted LED panel
 - Color temperature: 3,300K – 6,200K
 - Lumen output: 960 lumen max.
 - Power input: AC 100-240V power adapter with DC 12V 2A output
- Height: At 90° = 18 1/2", Extended = 27"
Base: 7" x 7"

Finish	Item No.
white	833.42.122

Dimensional data not binding. We reserve the right to alter specifications without notice.

Grommets

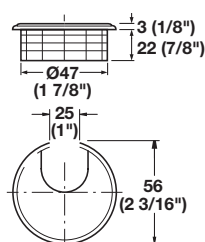

Cable Set, two-piece, round

- With break-away tab cover cap
- For press-fitting or gluing into Ø47 mm (1 7/8") holes

Material: Plastic

Color	Item No.
almond	429.93.019
brown	429.93.117
black	429.93.313

5

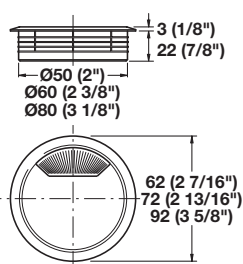

Cable Set, two-piece, round

- With spring closure
- For press-fitting or gluing

Material: Plastic

Color	Ø50 (2")	Ø60 (2 3/8")	Ø80 (3 1/8")
white	429.99.735	429.99.726	429.99.744
light gray	429.99.539	429.99.520	429.99.548
beige	429.99.431	429.99.422	429.99.440
almond	429.99.039	429.99.020	429.99.048
brown	429.99.137	429.99.128	429.99.146
black	429.99.333	429.99.324	429.99.342
chrome matt	429.97.222	429.97.231	429.97.240
brass matt	429.97.526	429.97.535	-

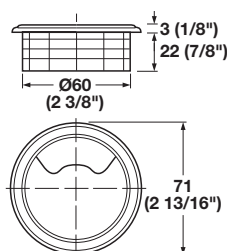

Cable Set, two-piece, round

- With break-away tab cover cap
- For press-fitting or gluing into Ø60 mm (2 3/8") holes

Material: Plastic

Color	Item No.
almond	429.93.028
brown	429.93.126
black	429.93.322

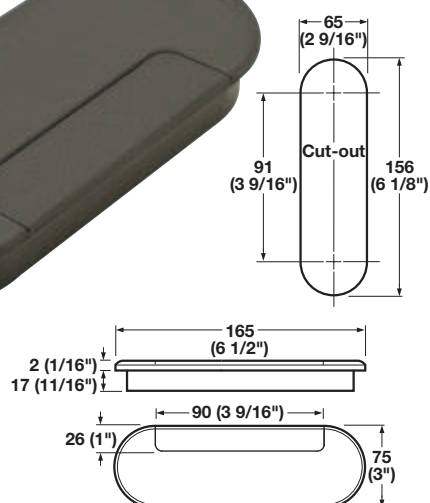

Oval Grommet, two-piece

- With break-away tab cover cap
- For press-fitting or gluing

Material: Plastic

Color	Item No.
black	429.87.306
white	429.87.700

Grommets

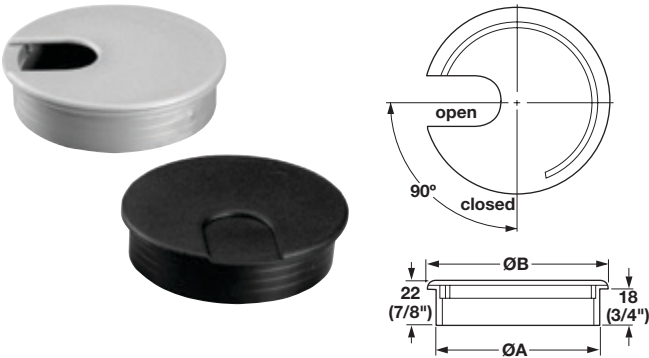

Two-piece round

- With 90° rotating top

Material: Plastic

Color	ØA	ØB	Item No.
black	60 (2 3/8")	70 (2 3/4")	631.26.301
silver	60 (2 3/8")	70 (2 3/4")	631.26.901
black	80 (3 1/8")	88 (3 7/16")	631.26.302
silver	80 (3 1/8")	88 (3 7/16")	631.26.902

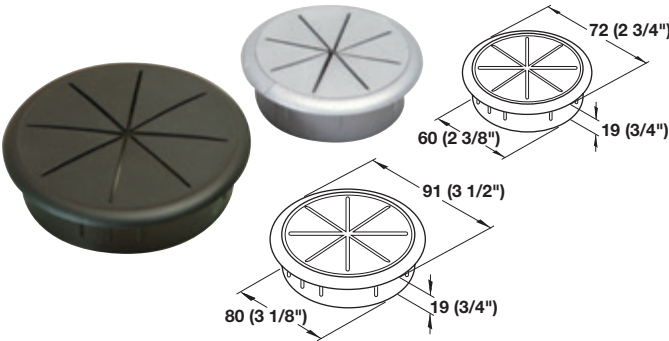

Flexi-Top

- Flexi-Top offers a unique look to any desk or counter
- Flexible top allows easy entry of multiple cables from any direction
- One-piece construction
- 2 sizes requiring a Ø60 or Ø80 mm (2 3/8" or 3 1/8") hole

Material: Plastic

Color	Ø60 (2 3/8")	Ø80 (3 1/8")
black	631.43.302	631.43.304
silver	631.43.902	-

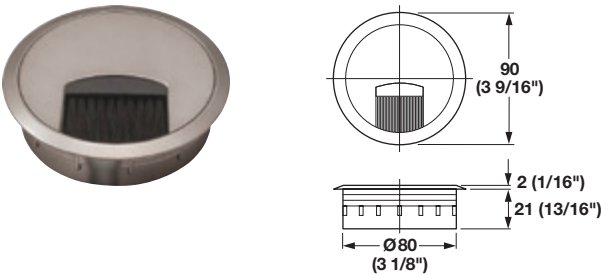

Grommet with Brush

Material: Plastic

Color	Item No.
stainless steel color	631.35.014
silver/aluminum RAL 9006	631.35.214
black	631.35.314

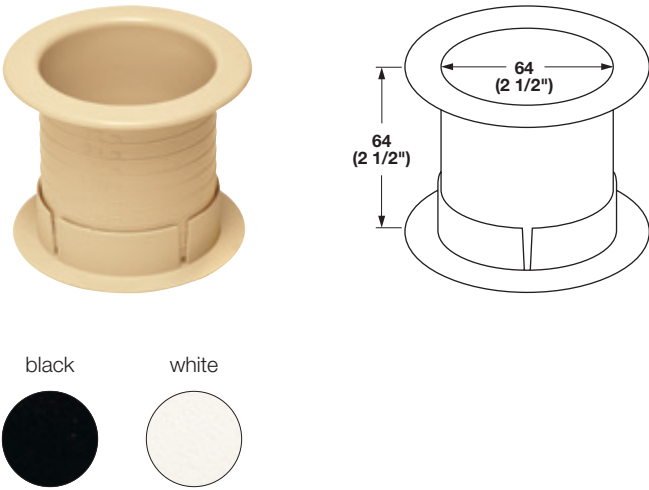

Trim grommet to size



Problem:
Ragged and
unsightly



Solution:
A professional
finish

Dually Grommet

- Dual-sided grommet, locks; no glue is required
- Top panel thickness: 19 - 64 mm (3/4" - 2 1/2")
- Cut to thickness required in 6 mm (1/4") increments with utility knife or scissors
- Ø64 mm (2 1/2") hole required

Material: Plastic

Color	Item No.
black	631.24.340
white	631.24.740

Dimensional data not binding. We reserve the right to alter specifications without notice.

Dimensions in mm
Inches are approximate

Cable Grommets

5

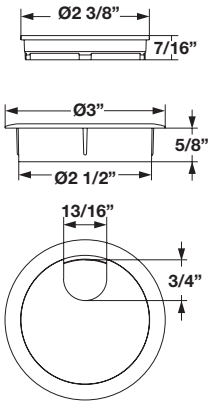

Two-piece, round

- With removable top
- Thin design, can be used with 5/8" thick panels
- For press-fitting in 2 1/2" holes

Material: Plastic

Color	Item No.
bronze	631.26.111
dark brown	631.26.112
black	631.26.311
almond	631.26.411
ivory	631.26.412
gray	631.26.511
stone	631.26.512
candlelight	631.26.611
white	631.26.711

bronze



dark brown



black



almond



ivory

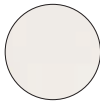

gray



stone

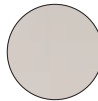

candlelight

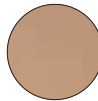

white

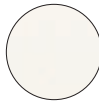

Metal Grommets

- Lid with brush and locking mechanism
- Push fits into Ø60 or Ø80 mm (2 3/8" or 3 1/8") hole

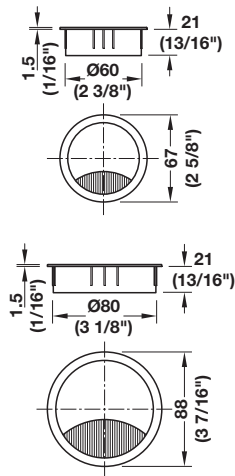

Two-piece, round

Height: 21 mm (7/8")

Material: Zinc alloy

Drill hole	Finish	Item No.
Ø60 (2 3/8")	polished chrome-plated	631.31.212
	matt chrome-plated	631.31.412
	stainless steel look	631.31.012
	white	631.31.712
	black	631.31.312
Ø80 (3 1/8")	polished chrome-plated	631.31.214
	matt chrome-plated	631.31.414
	stainless steel look	631.31.014
	white	631.31.714
	black	631.31.314

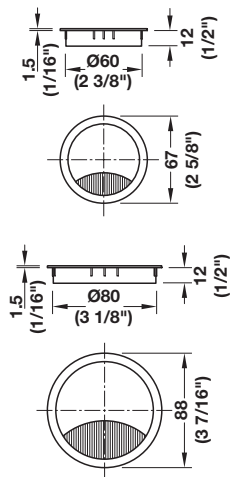

Two-piece, round

Height: 12 mm (1/2")

Material: Zinc alloy

Drill hole	Finish	Item No.
Ø60 (2 3/8")	polished chrome-plated	631.31.202
	matt chrome-plated	631.31.402
	stainless steel look	631.31.002
	white	631.31.702
	black	631.31.302
Ø80 (3 1/8")	polished chrome-plated	631.31.204
	matt chrome-plated	631.31.404
	stainless steel look	631.31.004
	white	631.31.704
	black	631.31.304

Dimensional data not binding. We reserve the right to alter specifications without notice.

Metal Grommets

- Metal grommets are an elegant upgrade from standard plastic grommets
- With straight edge, they can be recessed into top for flush applications

5

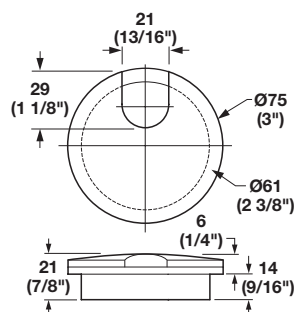
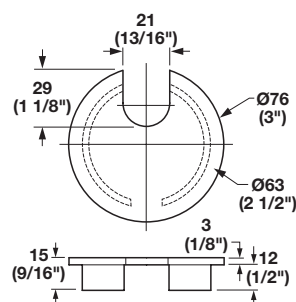
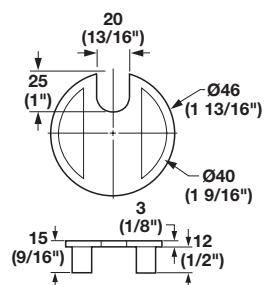
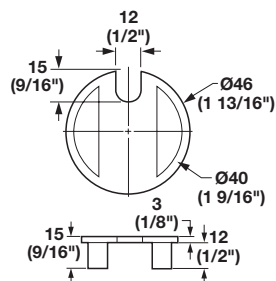

One-piece, round

- For press-fitting or gluing in Ø40 mm (1 9/16") holes
- Two aperture openings to choose from

Material: Zinc die-cast, plated or epoxy-coated

Finish/Color	12 x 15 mm (1/2" x 9/16")	20 x 25 mm (13/16" x 1")
chrome polished	429.94.212	429.94.221
brass polished	429.94.810	429.94.829
black epoxy	429.94.310	429.94.319
brushed bronze	429.94.026	429.94.034
brushed nickel	429.94.612	429.94.621
matt nickel	429.94.412	429.94.421

One-piece, round

- For press-fitting or gluing in Ø63 mm (2 1/2") holes
- Opening: 21 x 29 mm (13/16" x 1 1/8")

Material: Zinc die-cast, plated or epoxy-coated

Finish/Color	Item No.
chrome polished	429.94.258
brass polished	429.94.856
antique copper	429.94.151
black epoxy	429.94.346
brushed bronze	429.94.061
brushed nickel	429.94.658
matt nickel	429.94.448

Two-piece, round

- For press-fitting or gluing in Ø61 mm (2 3/8") holes
- Opening: 21 x 29 mm (13/16" x 1 1/8")

Material: Zinc die-cast, plated or epoxy-coated

Finish/Color	Item No.
black epoxy	631.46.302
nickel matt	631.46.602
polished brass	631.46.802

Anodized Aluminum Grommets with Brush

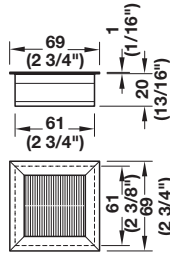

Square 69 x 69 mm

- One-piece with brush seal
- Screw mounted, corner radius R4
- W x D: 69 x 69 mm (2 3/4" x 2 3/4")

Material: Aluminum

Color	Item No.
black	631.29.340
silver	631.29.540

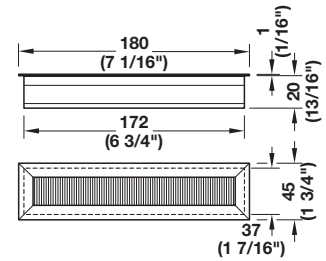

Rectangular 180 x 45 mm

- One-piece with brush seal
- Screw mounted, corner radius R4
- W x D: 180 x 45 mm (7 1/2" x 1 3/4")

Material: Aluminum

Color	Item No.
black	631.29.341
silver	631.29.541

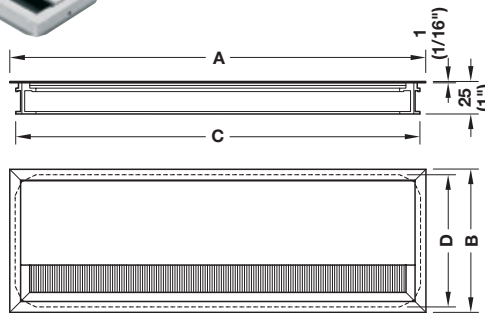

Rectangular with Lid

- With smooth closing mechanism
- One-piece with brush seal
- Screw mounted, corner radius R14

Material: Aluminum

A	B	C	D	Color	Item No.
320 (12 5/8")	110 (4 1/4")	311 (12 1/4")	102 (4")	black	631.29.301
				silver	631.29.901
240 (9 1/2")	120 (4 3/4")	231 (9 1/8")	113 (4 1/2")	black	631.29.312
				silver	631.29.912
450 (17 3/4")	120 (4 3/4")	441 (17 3/8")	113 (4 1/2")	black	631.29.313
				silver	631.29.913

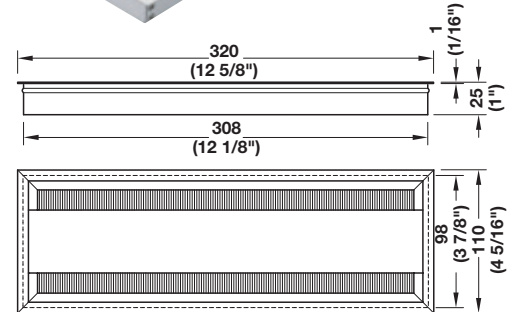

Rectangular 320 x 110 mm Double-Sided

- Two-piece double-sided brush seal with magnetic attached divider
- Screw mounted, corner radius R5
- W x D: 320 x 110 mm (12 5/8" x 4 1/4")

Material: Aluminum

Color	Item No.
black	631.29.321
silver	631.29.921

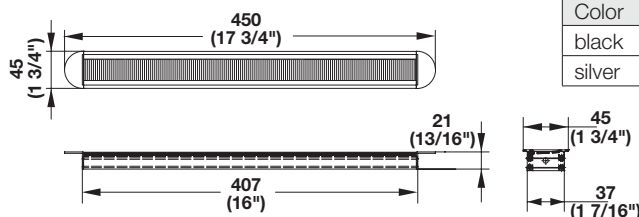

Cable Slot 450 x 45 mm with Brush

- One-piece with brush seal
- Screw mounted
- W x D: 450 x 45 mm (17 3/4" x 1 3/4")

Material: Aluminum

Color	Item No.
black	631.29.350
silver	631.29.950

Dimensional data not binding. We reserve the right to alter specifications without notice.

This page is left blank intentionally.

Grommets

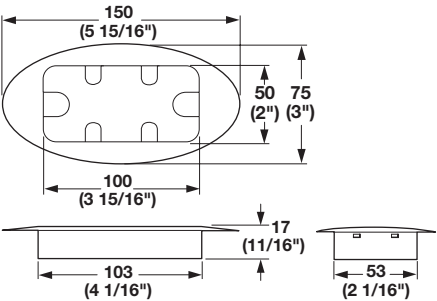

Oval Grommet

- With removable cover for large plugs

Material: Plastic

Color	Item No.
black	631.24.310

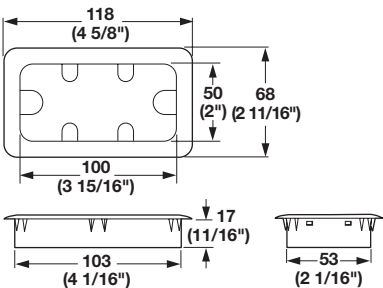

Rectangular Grommet

- With removable cover for large plugs

Material: Plastic

Color	Item No.
black	631.24.300

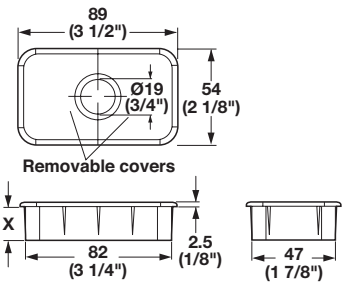
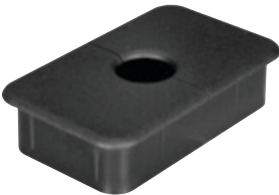

Rectangular Grommet

- With two removable covers
- For various material thicknesses

Material: Plastic; Color: black

X	Item No.
16 (5/8")	631.37.301
19 (3/4")	631.37.302
25 (1")	631.37.303
31 (1 1/4")	631.37.304

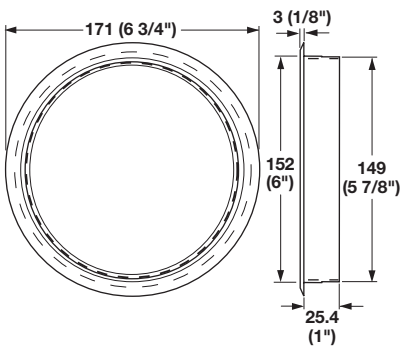

Waste Management Liner

- For press fitting into 152 mm (6") hole

Material: Plastic

Color	Item No.
black	631.24.320

Dimensional data not binding. We reserve the right to alter specifications without notice.

Grommets

- Various diameters and depths to choose from
- Produced from 304 grade stainless steel

5

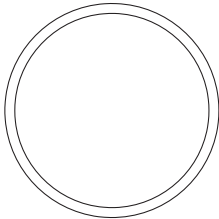

6" Ø Round Trash Rings

Material: Stainless Steel

C	Item No.
25 (1")	631.24.080
52 (2")	631.24.081
152 (6")	631.24.083

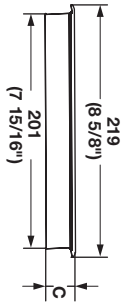
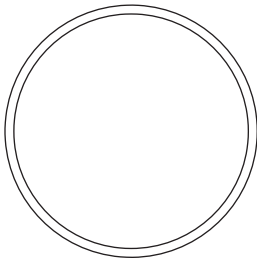

8" Ø Round Trash Rings

Material: Stainless Steel

C	Item No.
25 (1")	631.24.085
52 (2")	631.24.086

This page is left blank intentionally.

- Apply behind desks, along modesty panels, along baseboards, etc.
- Use as individual cable hooks under work surfaces to help separate cables
- Both cable trunking extrusions can be cut to length

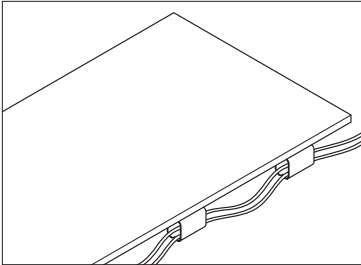

5

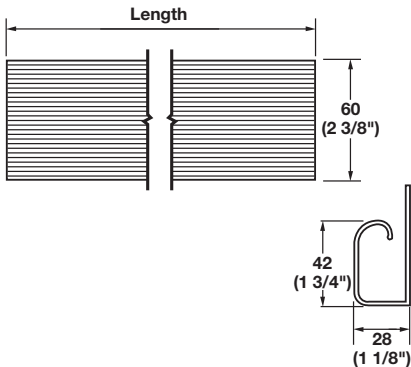

Cable Trunking - Single J

- With self adhesive tape
- Provides efficient cable concealment
- Length: 2438 mm (96")

Material: Plastic PVC, adhesive tape

Color	Item No.
black	829.15.302

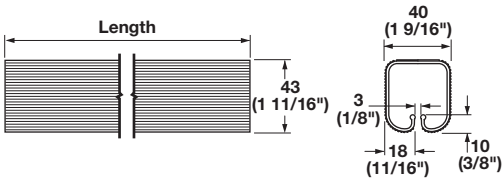

Cable Trunking - Double J

- With self adhesive tape
- Mounts vertically or horizontally
- Length: 2489 mm (98")

Material: Plastic PVC, adhesive tape

Color	Item No.
black	829.20.300

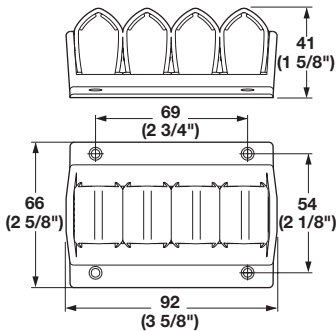

Cable Grip

- Cables are securely gripped when inserted between loops
- Screw-mounted

Material: Plastic

Color	Item No.
black	631.39.310

- These flexible cable management systems are attractively designed and protect the cables from floor to desktop
- An ideal solution for use with adjustable table mechanisms
- The length/height is easily adjusted by removing individual discs as required



5

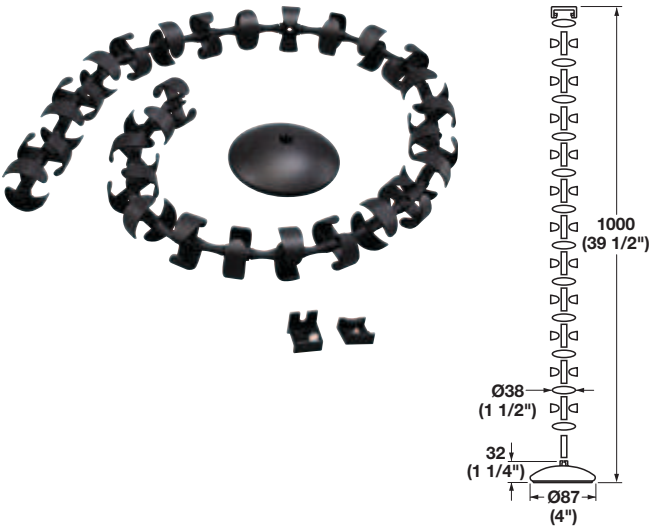

Wire-Guide® Cable Manager
Vertical Wire Guide

Length: 1000 mm (39 1/2")

Material: Plastic; Base: Metal

Color	Item No.
black	631.18.301

Supplied With
2 Fastening clips
Screws

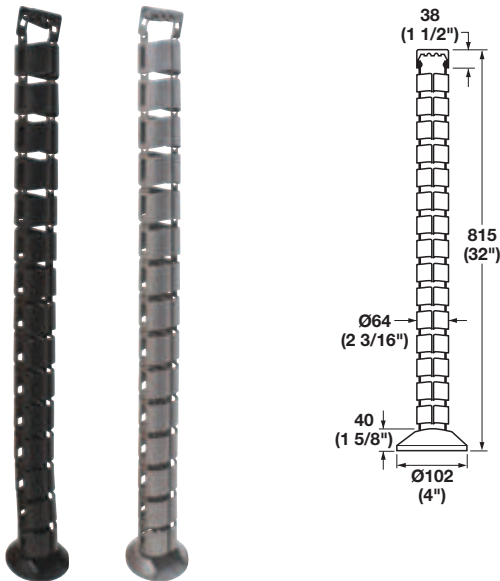

Vertebra Round Cable Manager
Vertical System

- With weighted base and table attachment element

Material: Plastic; Base: Metal

Color	Item No.
black	631.01.300
silver RAL 9006	631.01.900

Supplied With
Mounting screws

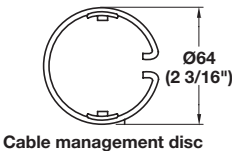

Dimensional data not binding. We reserve the right to alter specifications without notice.

Spiral Wire Guides

5

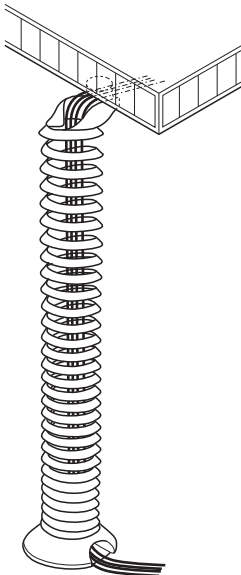

Cable Guide, spiral design

- Flexible, for use with different table heights, especially height adjustable tables
- With weighted base
- Screw mounts under table
- Max. table height: 1200 mm (47")

Material: Plastic

Color	Item No.
black	631.20.310
silver colored	631.20.910
white	631.20.710

This page is left blank intentionally.

- 360° rotation
- Quantity of through holes and non-skid pads depends on model
- Pads can be removed and drilled through if positive attachment is necessary
- Through holes are countersunk with Ø4.5 mm (3/16")

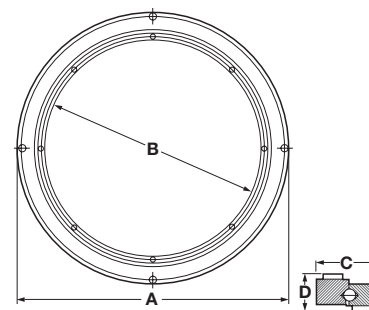

5

Heavy Duty Turntables

- For high quality applications
- Rotates 360° on steel ball bearings

Material: Aluminum

A Outer Dia.	B Inner Dia.	C Width	D Height	Load Capacity	Holes Inner	Pads Inner	Holes Outer	Pads Outer	Item No.
325 (12 3/4")	256 (10 1/16")	30 (1 3/16")	15 (9/16")	80 kg (175 lbs.)	6	0	0	6	646.20.023
442 (17 1/2")	380 (15")	31 (1 1/4")	20 (13/16")	125 kg (275 lbs.)	6	6	0	8	646.20.024
600 (23 5/8")	520 (20 1/2")	40 (1 9/16")	22 (7/8")	250 kg (550 lbs.)	4	8	0	10	646.20.025
750 (29 5/8")	670 (26 3/8")	40 (1 9/16")	22 (7/8")	400 kg (880 lbs.)	5	10	0	13	646.20.026

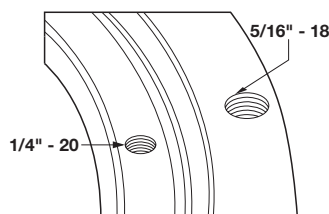

Heavy Duty Turntable

- With threaded inner and outer through holes for "bolting down" of turntable

Material: Aluminum

A Outer Dia.	B Inner Dia.	C Width	D Height	Load Capacity	Holes Inner	Pads Inner	Holes Outer	Pads Outer	Item No.
325 (12 3/4")	265 (10 7/16")	30 (1 3/16")	15 (9/16")	80 kg (175 lbs.)	6 with 1/4"-20	0	6 with 5/6"-18	6 Separate	646.20.006

- Economical turntables for small offices, entertainment centers, kitchens, etc.
- Rotates 360°, ball bearing mounted

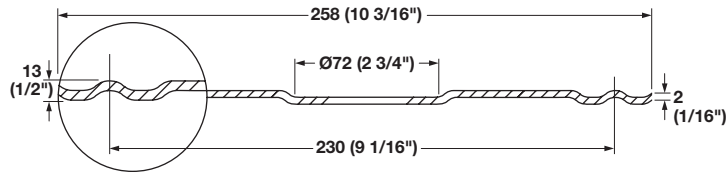
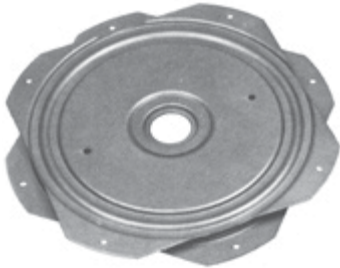

Turntable

Weight capacity: 120 kg (260 lbs.)

Material: Steel, unfinished

Item No.
646.29.902

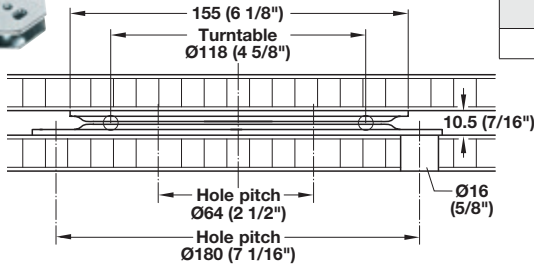

Turntable

Weight capacity: 150 kg (330 lbs.)

Material: Steel, galvanized

Item No.
646.18.908

Dimensional data not binding. We reserve the right to alter specifications without notice.

5

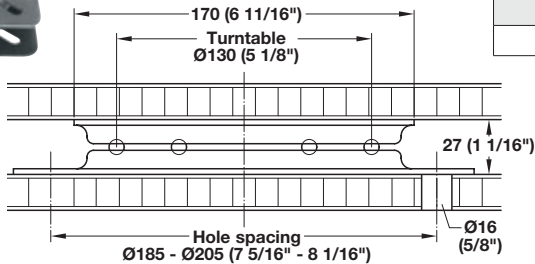

Turntable

- Rotates 360°, ball bearing mounted
- Weight capacity: 100 kg (220 lbs.)

Material: Steel, unfinished

Item No.
646.15.014

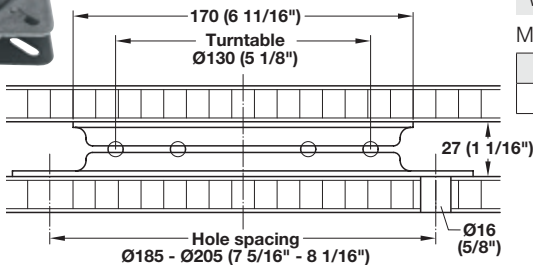

Turntable, spring loaded

- Rotates 90° to the right and left sides, ball bearing mounted
- After turning, a steel spring returns the turntable to its original position
- Weight capacity: 100 kg (220 lbs.)

Material: Steel, unfinished

Item No.
646.15.023