

Fineline – Cutlery Tray

- Your choice of natural walnut or birch
- Easily trimmed to fit most drawers
- Walnut provides a beautiful contrast in maple drawer boxes
- Patented Fineline design
- A large variety of accessories to choose from for increased storage and functionality
- Beautiful mix of natural wood, stainless steel and aluminum
- Elegantly tapered dividers for a distinguished "Fineline" look

Note

For outside cabinet widths of 18" and 24" and width and depth spacers, refer to page 3.64.



Cutlery Tray

- Minimum Inside Drawer Depth: 16 11/16"
- Maximum Inside Drawer Depth: 20 7/8"

Material: MDF veneer; Dividers: Solid Wood

Finish	For outside cabinet width	Actual Width	Min. Trim Width	Item No.
walnut	30"	702 (27 5/8")	13 3/8"	556.87.603
	36"	853 (33 9/16")	13 3/8"	556.87.604
birch	30"	702 (27 5/8")	13 3/8"	556.87.903
	36"	853 (33 9/16")	13 3/8"	556.87.904

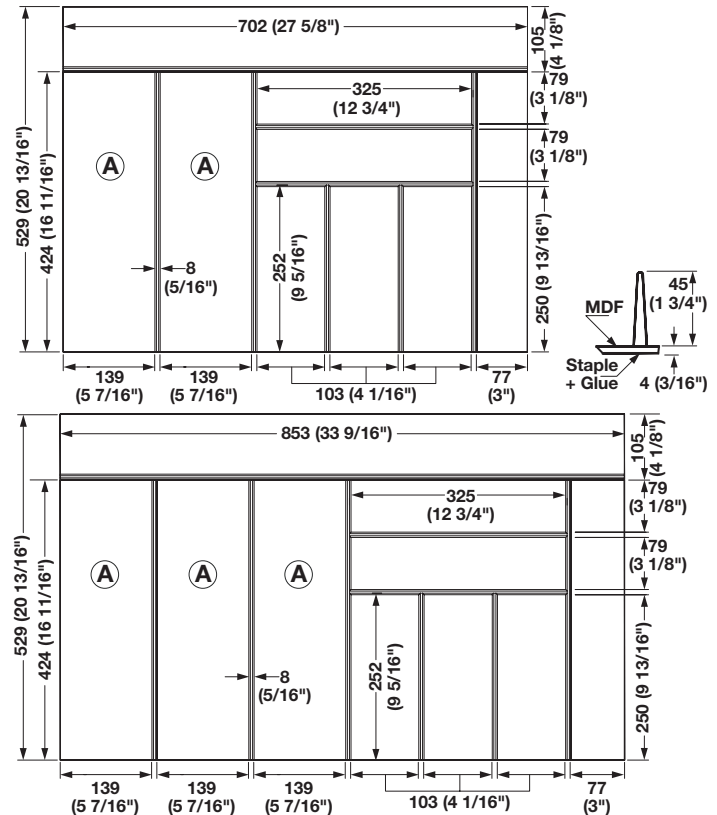

Helpful Design Information

Width	Face Frame Cabinet Construction (1 1/2" Stiles)		Frameless Cabinet Construction (3/4" 19 mm material)	
	Drawer Box Thickness 5/8" (16 mm)	Drawer Box Thickness 3/4" (19 mm)	Drawer Box Thickness 5/8" (16 mm)	Drawer Box Thickness 3/4" (19 mm)
Outside Cabinet Width - 4 5/8" (117 mm) = Interior Drawer Width	Outside Cabinet Width - 4 7/8" (124 mm) = Interior Drawer Width	Outside Cabinet Width - 2 7/8" (73 mm) = Interior Drawer Width	Outside Cabinet Width - 3 1/8" (80 mm) = Interior Drawer Width	
Depth	Wood Drawer with 21" slides and 5/8" material = 19 3/4" (502 mm) Interior Drawer Depth		Moovit Drawer with 550 mm (22") slides = 530 mm (20 7/8") Interior Drawer Depth	
	Wood Drawer with 21" slides and 3/4" material = 19 1/2" (495 mm) Interior Drawer Depth			

Dimensional data not binding. We reserve the right to alter specifications without notice.

Dimensions in mm
Inches are approximate