

## ADJUSTABLE DEPTH | EASY MAINTENANCE | NO LEAKS

Probe cap kits allow Agrowtek's SXL liquid sensors to be installed on the end of standard 1" PVC pipe and installed to any depth within a tank by inserting the sensor into the tank from the normal top opening.

No extra holes are required in the tank which means less chance of leaks. Pipe can be made to any length and can be adjustable for various depth settings. Pipe can be easily pulled up and removed from the tank for easy cleaning and maintenance.

Kit includes threaded sensor cap and adapter for 1" PVC pipe. Simply provide 1" PVC pipe cut to the desired length and bond fitting to pipe. Connect sensor and tighten cap onto pipe fitting. An o-ring in the sensor cap means no thread tape is required on the pipe fitting.

When ordered with sensor kits, the cap and sensors are pre-assembled for convenience.



Made in  
USA



NSF Compliant  
Materials



1-Year  
Warranty

### Cap & Sensor Assembled

### Cap & Adapter Kit

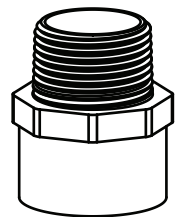
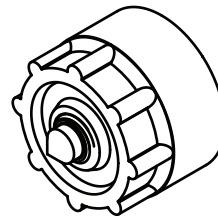
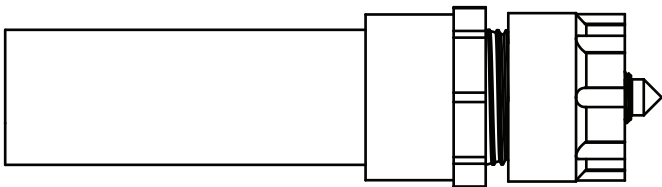

### SXL-D Drain System Example

### SXL-F Fill System Example

