

THERMOCHARGE 6

2 IN 1

HAND WARMER

AND POWER BANK

Model # 48023



Thank you for purchasing the ThermoCharge 6 2-in-1 Hand Warmer and Power Bank! Water-resistant, dust proof, ergonomic, and up to 8 hours of scent-free heat makes the ThermoCharge 6 a must have for the outdoor enthusiast!

WARNING: Read all instructions and warnings thoroughly before using the ThermoCharge 6. Improper use of this product may result in product damage, excess heat, toxic fumes, fire or explosion. Not intended for children.

INCLUDED IN THE BOX ARE:

- 1 - ThermoCharge 6
- 1 - USB Cable
- 1 - Soft Carry bag
- 1 - 4" 550 paracord strap with carabiner clip

PARTS CALLOUT:

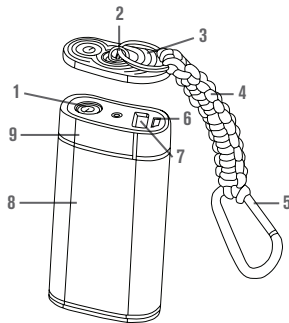

- 1. Power Button
- 2. D Ring/O Ring thumbscrew
- 3. Water-resistant lid
- 4. 4" 550 paracord strap
- 5. Carabiner
- 6. Mini USB "IN" port
- 7. USB "OUT" port: (standard 2.0 USB)
- 8. Main heating surface
- 9. Battery indicator LEDs (under surface)

1. CHARGING THE INTERNAL LITHIUM ION BATTERY

Your ThermoCharge 6 has an internal, 6000 mAh rechargeable lithium ion battery, which allows for up to 8 hours of continuous use at a constant temperature of 40° to 45° Celsius (104° to 113° Fahrenheit). The ThermoCharge 6 ships with a partial charge, but you should charge it completely before using it for the first time.

STEPS

1. Unscrew the thumbscrew, D Ring (2) and lift the water-resistant lid (3) to expose the USB ports (the lid will stay tethered to the main housing.)

2. Plug the standard USB plug end of the included USB cable into a USB port on a PC, laptop, car charger or USB 5V 2.1A Max adapter plug.
3. Plug the mini USB end of the included USB cable into the "IN" port (6) on your ThermoCharge 6.
4. Once plugged in, the blue LEDs (9) will start blinking indicating a charge is in progress.
5. Charging is complete when all 4 blue LEDs stop blinking.

NOTE: Using the O Ring attached to the thumbscrew to open the cover will make the process much easier.

2. USING THE HAND WARMER FEATURE

- Press and release the power button (1) once. The red LED (9) will illuminate and the unit will begin to heat up. In minutes, it will reach its maximum temperature and you'll feel the heat being conducted through the aluminum.
- The Blue LEDs will also tell you the status of the battery power.
- Press the power button once to turn off.
- The ThermoCharge 6 has a protective water-resistant cap (3) that should be secured in place when using the hand warmer feature.

3. CHARGING AN EXTERNAL DEVICE

- Simply plug your device's USB 2.0 plug into the standard USB "OUT" port (7) on the ThermoCharge 6 while the other end of your charging cable is connected to your smartphone, tablet, camera or MP3 player and the internal battery will automatically start charging your device.
- A green LED (9) will illuminate indicating a "charge" is in progress.
- The blue LEDs (9) will illuminate indicating the battery power level.
- (1 LED- 25%, 2 LEDs- 50%, 3 LEDs- 75%, 4 LEDs- 100%).

4. SPECIFICATIONS

BATTERY: Rechargeable lithium ion battery- 6000 mAh

INPUT: Mini USB Connector / 5V 1.8A Max

HAND WARMER CONTINUOUS USE TIME: Up to 8 hours continuous use (based on fully charged battery)

HAND WARMER TEMPERATURE RANGE:

40° TO 45° C (104° TO 113° F)

POWER CURVE FEATURE: Fits ergonomically in your hand or pocket

IP-65 RATED: Complete dust protection (6) Water resistant (5)

C-LINK FEATURE: Compatible with other Celestron Elements power banks for extending heat time and recharging the internal battery

OUTPUT: Standard 2.0 USB connector: 5V 2.1A (Smart Charge Technology)

AUTO-CHARGE FEATURE: Plug into the standard USB port and ThermoCharge 6 will automatically start charging your electronic device.

LED STATUS INDICATORS:

- (4) Blue- Battery indicator LEDs
- (1) Green- Charge OUT indicator
- (1) Red- Hand warmer ON indicator

OPERATING TEMPERATURE RANGE:

0° to 45° Celsius (32° to 113° Fahrenheit)

STORAGE TEMPERATURE RANGE:

68° to 77° Fahrenheit (optimal)

ACCESSORIES: (1) Soft Carry bag

(1) 4" long paracord strap with carabiner clip

WEIGHT: 5.9 oz. (168 grams)

DIMENSIONS: 2.0 in x .96 in x .40 in

(51.34 mm x 24.41 mm x 102.9 mm)

POWER DELIVERY CHART:

Smartphone (2100 mAh): 2.5 charges

Tablet (8200 mAh): .5 charges

MP3 Player (1100 mAh): 4.5 charges

Sports CAM (1100 mAh): 4.5 charges

WARNINGS:

Read all instructions and warnings prior to using this product. Improper use of this product may result in product damage, excess heat, toxic fumes, fire or explosion, for which damages you ("Purchaser") and not Smart Team or Celestron (collectively "Manufacturer") are responsible.

- Do not store battery in high temperature environment, including intense sunlight.
- Do not place battery in fire or other excessively hot environments.
- Be cautious of excessive drops, bumps, abrasions or other impacts to this battery. If there is any damage to the battery such as dents, punctures, tears, deformities or corrosion, due to any cause, discontinue use and contact manufacturer or dispose of it in an appropriate manner at your local battery recycling center.
- Do not disassemble this battery or attempt to repair or modify it in any manner.
- Do not expose this battery to moisture or submerge it in liquid.
- Do not attempt to charge battery using any method, apparatus or connection other than the device's USB connector. For questions or instructions for the various ways to charge the Model #48023 2-in-1 Hand Warmer and Power Bank, refer to this manual.
- Do not attempt to replace any part of this battery.

- This battery is intended for adult use only. If this battery is intended by Purchaser to be used by a minor, purchasing adult agrees to provide detailed instructions and warnings to any minor prior to use. Failure to do so is sole responsibility of Purchaser, who agrees to indemnify Manufacturer for any unintended use/misuse by a minor.
- If you find that your battery is excessively hot, is emitting odor, is deformed, abraded, cut or is experiencing or demonstrating an abnormal phenomenon, immediately stop all battery use and contact Manufacturer.
- For extended storage, first charge your battery for at least one hour.
- It is not recommended to store device for more than 3 months without use as batteries may have a tendency to discharge.
- Never dispose of batteries in the garbage. Disposal of batteries in the garbage is unlawful, in The United States, under state and federal environmental laws and regulations. Always take used batteries to your local battery-recycling center.

DISCLAIMER:

Manufacturer shall not in any way be liable to you or to any third party for any damages you or any third party may suffer as a result of use, intended or unintended, or misuse of this battery. Manufacturer will not be responsible for any damages you or any third party may suffer as a result of misuse of this battery as outlined above. If you are responsible for battery use with an unintended mobile device and damages result from such use, you agree to indemnify Manufacturer for any resulting injuries to any third party or parties.

This device complies with part 15 of the FCC Rules. Operation is subject to the following two conditions:

- (1) This device may not cause harmful interference, and (2) this device must accept any interference received, including interference that may cause undesired operation.

NOTE: This equipment has been tested and found to comply with the limits for a Class B digital device, pursuant to part 15 of the FCC Rules. These limits are designed to provide reasonable protection against harmful interference in a residential installation. This equipment generates uses and can radiate radio frequency energy and, if not installed and used in accordance with the instructions, may cause harmful interference to radio communications. However, there is no guarantee that interference will not occur in a particular installation. If this equipment does cause harmful interference to radio or television reception, which can be determined by turning the equipment off and on, the user is encouraged to try to correct the interference by one or more of the following measures:

1. Reorient or relocate the receiving antenna.
2. Increase the separation between the equipment and receiver.
3. Connect the equipment into an outlet on a circuit different from that to which the receiver is connected.
4. Consult the dealer or an experienced technician for help.

CAUTION: To comply with the limits of the Class B digital device, pursuant to Part 15 of the FCC Rules, this device is comply with Class B limits. All peripherals must be shielded and grounded. Operation with non-certified peripherals or non-shielded cables may results in interference to radio or reception.

MODIFICATION: Any changes or modifications not expressly approved by the grantee of this device could void the user's authority to operate the device.



Torrance, CA 90503
 TEL (800) 421-9649 | celestron.com
 Copyright 2015 Celestron | All rights reserved.

(Products or instructions may change without notice or obligation.)

Designed and intended for those 14 years of age and older.
 V2.0