

DO Tip (35660-64) Instruction Manual

* "DO" is an abbreviation of Dissolved Oxygen.

Cautions during handling

CAUTION



Chemical solution

Highly concentrated potassium hydroxide (KOH) is used in the internal solution of the electrode. If the internal solution in the electrode comes in contact with your hands or skin, wash immediately with water. If the internal solution comes in contact with your eyes, flush immediately with large amounts of water and seek treatment by a physician.

- Do not allow the electrode to be in contact with any hard surface.
- An extremely thin membrane is stretched across the DO tip and the DO responsive part. Do not allow the membrane to come in contact with any hard surface and do not exert undue force on the diaphragm.
- When attaching the DO tip to the electrode body, make sure that the O-ring is attached. Attach the DO tip securely to the electrode body.
- The electrode connector requires a high degree of insulation. Do not allow the connector to be in contact with water or dirty hands.
- DO tips that are no longer usable should be disposed of as industrial waste.
- The water-resistant construction of meters can be used in construction (conforming to IP-67). When measuring, do not immerse the cap, the lead or connector in the sample.

Storage

- The electrode should remain to be connected to the meter during storage.
 - To store the electrode without the meter, follow the below procedure.
1. Remove the electrode from the connector on the meter.
 2. Clean the electrode well with tap water, then dry it with a soft cloth.
 3. Remove the DO tip from the holder.
 4. Put the short socket on the DO tip, then store it in a cool, dark location with an oxygen scavenger.

Note

Avoid storing the electrode in hot place or places with high humidity. Store the electrode indoors and out of direct sunlight.

Installation procedure

1. Remove the DO tip (35660-64) from the package.

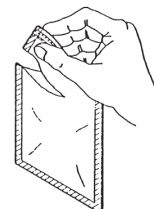

2. Remove the short socket and the paper cap from the DO tip.

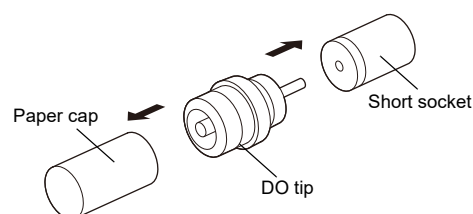

3. Attach the DO tip to the holder.

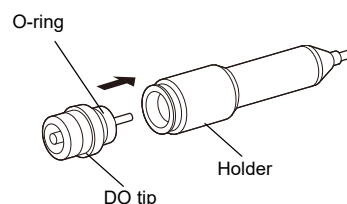

4. Attach the protective cap securely to the holder.

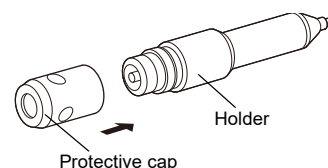

Note

- **Do not dispose of the short socket that was removed. It is necessary when storing the electrode.**
- **Screw the protective cap on firmly, until it stops. When attaching the DO tip to the electrode body, make sure that the O-ring is attached to the DO tip.**