

Easytherm 1



The Easytherm 1 is a small powerful microprocessor controlled induction heater for heating of small sized components including bearings up to 10 kg!! It is easy to use and portable, complete with a robust case, ideal to use on location.



Display



Increase Temperature

Decrease Temperature



Technical information	
Voltage	110-230V
Frequency	50 or 60 Hz
Power	2.2 kVA
Heater mass	7 kG
Dimensions	230x200x240mm
Temp. mode	Max 240°C
Width U-core (D)	65mm
Height U-core	95mm

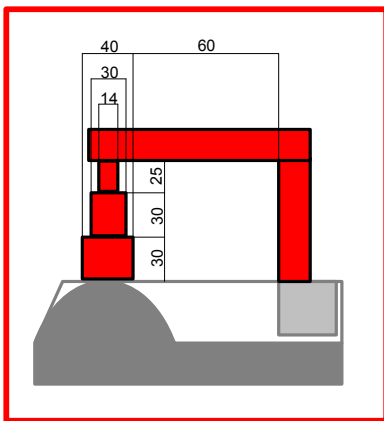

Dimensions				
Size induction yokes mm	Standard min. bore part (A)	Standard max. outer diameter part (B)	Standard max. width part (C)	Max. Weight part
14x14x25*	20mm	150mm	25mm	10kG
30x30x30*	45mm	150mm	55mm	10kG
40x40x30*	65mm	150mm	95mm	10Kg

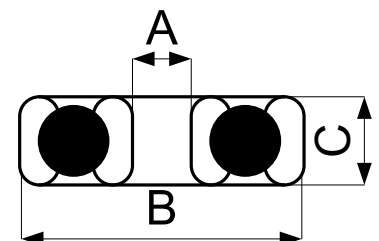

* Standard delivered within induction heater