

33" Standard-Depth French Door Bottom-Freezer

800 Series - Stainless Steel

B22FT80SNS



Features and Benefits

Design

- Full-Width Glass Shelves With Metal Trim

Performance

- Dual Evaporator
- Deli Drawer
- Crisper Drawer
- Electronic Controls for Precise Temperature Management

Efficiency

- Energy Star™ Qualified

Convenience

- Door Open Alarm
- Automatic Ice Maker

Capacity

- 21.9 cu.ft Total Capacity
- 15.60 cu.ft. Refrigerator Capacity
- 6.3 cu.ft. Freezer Capacity
- Gallon Door Bins
- Full Length Cantilever Racks for Ultimate Flexibility

Notes: All height, width and depth dimensions are shown in inches. *Please refer to installation instructions prior to making cutout. BSH reserves the absolute and unrestricted right to change product materials and specifications, at any time, without notice. Consult the product's installation instructions for final dimensional data and other details. Applicable product warranty can be found in a accompanying product literature or you may contact your account manager for further details.

For more information on our entire line of products, go to boschappliances.com or call 1-800-944-2904.
Copyright ©2014 BSH Home Appliances Corporation. All rights reserved. Bosch is a registered trademark of Robert Bosch GmbH.

Litho Date: 03/2014



33" Standard-Depth French Door Bottom-Freezer

800 Series - Stainless Steel

B22FT80SNS

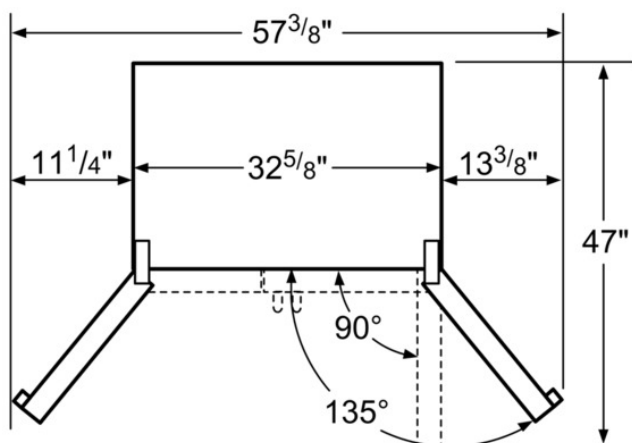

Drawers can be pulled out with door open 90°.

Drawers can be taken out with door completely open.

measurements in inches

Features

Multi-Flow Air Tower	Yes
SUPERCOOL	No
SUPERFREEZE	No
Temperature Controlled Drawer	
Humidity Control Drawer	
Number of Door Bins - Refrigerator	
Adjustable Door Bins - Refrigerator	
Tilt-Out Door Bins - Refrigerator	
Gallon Storage	No
Gallon Storage Bins	
Motorized Shelf	No
Adjustable Shelves - Refrigerator	9
Shelf Material - Refrigerator	
Reversible Door Hinge	No
Lighting	
Door Open Indicator	No
Drawers with telescopic rails	
Ice Maker	No
Ice Storage Capacity (lbs)	10
Ice Cubes per Day (lbs)	9.9

Technical Specification

UPC code	825225908524
Variant color	Stainless steel
Panel ready	
Silence level (dBA)	
Watts (W)	0
Current (A)	10
Volts (V)	115
Frequency (Hz)	60
Total annual energy consumption (kWh)	
Energy Star® qualified	No
Approval certificates	CSA, UL
Power Cord Length	84"
Plug type	120V-3 prong
Required cutout size (HxWxD) (in)	x x
Appliance dimensions (h x w x d) inch	69 " x 33 " x 34 "
Product packaging dimensions (HxWxD) (in)	74.80 x 35.43 x 35.43
Total unit gross capacity (cu. ft.) - AHAM	100
Refrigerator Gross capacity (cu. ft.)	100
Freezer Gross capacity (cu ft)	
Net weight (lbs)	251
Gross weight (lbs)	278

Notes: All height, width and depth dimensions are shown in inches. *Please refer to installation instructions prior to making cutout. BSH reserves the absolute and unrestricted right to change product materials and specifications, at any time, without notice. Consult the product's installation instructions for final dimensional data and other details. Applicable product warranty can be found in a accompanying product literature or you may contact your account manager for further details.

For more information on our entire line of products, go to boschappliances.com or call 1-800-944-2904.

Copyright ©2014 BSH Home Appliances Corporation. All rights reserved. Bosch is a registered trademark of Robert Bosch GmbH.

Litho Date: 03/2014

