

How to Install an Overlay Panel

Only for Model Numbers:

A115WC-O; A124WC-O; A115BEV-O; A124BEV-O; A115R-O; A124R-O

1. Remove the door gasket from the interior of the door.
2. The screws that come with the unit are intended to be used with a 3/4" front panel.
3. Clamp your front panels to the frame of the door and then anchor the panel to the door, using the screw, lock washer and flat washer provided for each mounting hole.
4. Re-install the gasket into the door assembly.

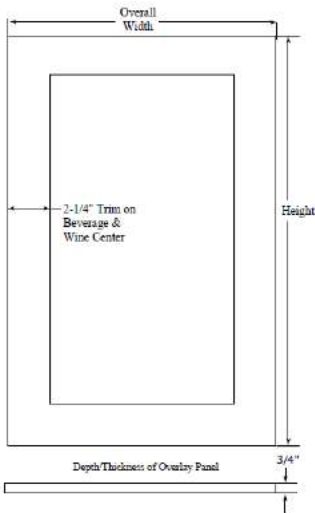
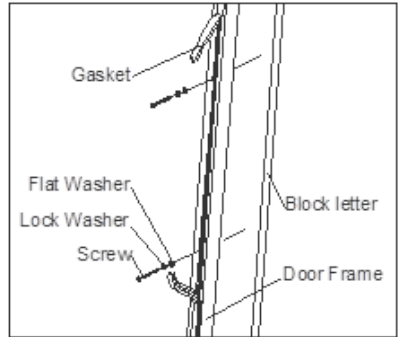

Dimensions for Overlay Panels

Model	Height	Total Width of Door	Width of Trim	Depth / Thickness of Trim
A115WC-O	23-3/8"	14-1/2"	2-1/4"	3/4"
A124WC-O	28-1/8"	23-1/8"	2-1/4"	3/4"
A115BEV-O	23-3/8"	14-1/2"	2-1/4"	3/4"
A124BEV-O	28-1/8"	23-1/8"	2-1/4"	3/4"
A115R-O	23-3/8"	14-1/2"	N/A	3/4"
A124R-O	28-1/8"	23-1/8"	N/A	3/4"