

**30 SERIES DBI663PHS****FEATURES**

Premium height-adjustable upper rack and premium lower rack

Top tray with Instant Lift™

Heavy-duty stainless steel construction

Nylon-coated steel racks

TouchProof™ stainless steel

Condensation drying system

16 place-setting capacity

Quiet operation—44 dB(A)

8Spray™ wash system

Hidden controls

LED display

Delayed start

ADA height compliant

**PROGRAMS**

- Normal Wash
- Eco Wash
- Sanitation Wash
- Time Program
- Plastic Wash
- Hygiene Wash
- Crystal Glass
- Lower Half Wash
- Upper Half Wash
- Self-Cleaning
- Rinse and Hold

**PRODUCT SPECIFICATIONS**

|                   |  |
|-------------------|--|
| Model             | DBI663THS  |
| Width             | 23 <sup>7</sup> / <sub>8</sub> "                                       |
| Height            | 32 <sup>3</sup> / <sub>4</sub> "*** – 34 <sup>3</sup> / <sub>4</sub> " |
| Depth             | 22"  |
| Door Clearance    | 24 <sup>5</sup> / <sub>8</sub> "                                       |
| Weight            | 112 lb   |
| Electrical Supply | 115 VAC, 60 Hz   |
| Service           | 15 amp dedicated circuit   |
| Receptacle        | 3-prong grounding-type   |
| Power Cord        | 4'   |
| Water Connection  | 6" PEX tubing with<br>3/8" NPT female connection                       |
| Drain Connection  | 5' corrugated tubing   |
| Pressure          | 4.2–140 psi  |

Electrical supply, plumbing supply, and drain should be located in an adjacent cabinet. If not, they must be located within the shaded area shown in the illustrations below.

**ELECTRICAL | PLUMBING**



**DIMENSIONS**

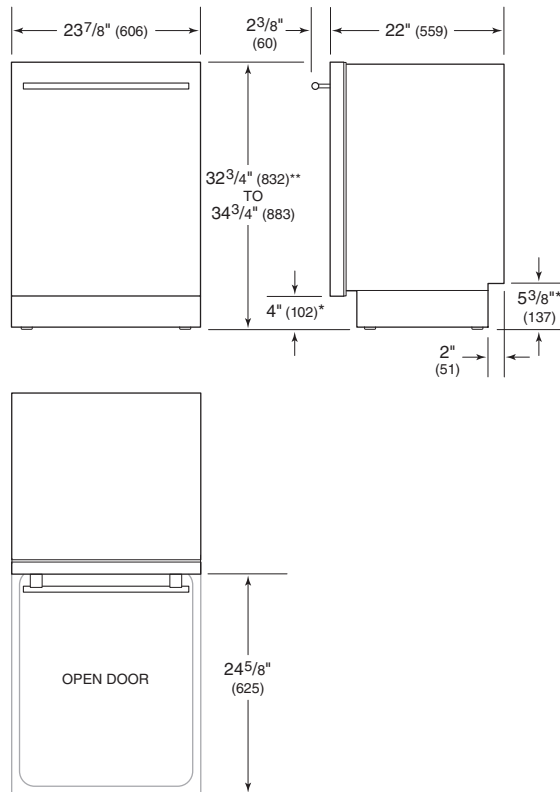

\*Dimension will vary with product height.  
\*\*Can be reduced to 32<sup>1</sup>/<sub>4</sub>" (819).

**INSTALLATION**

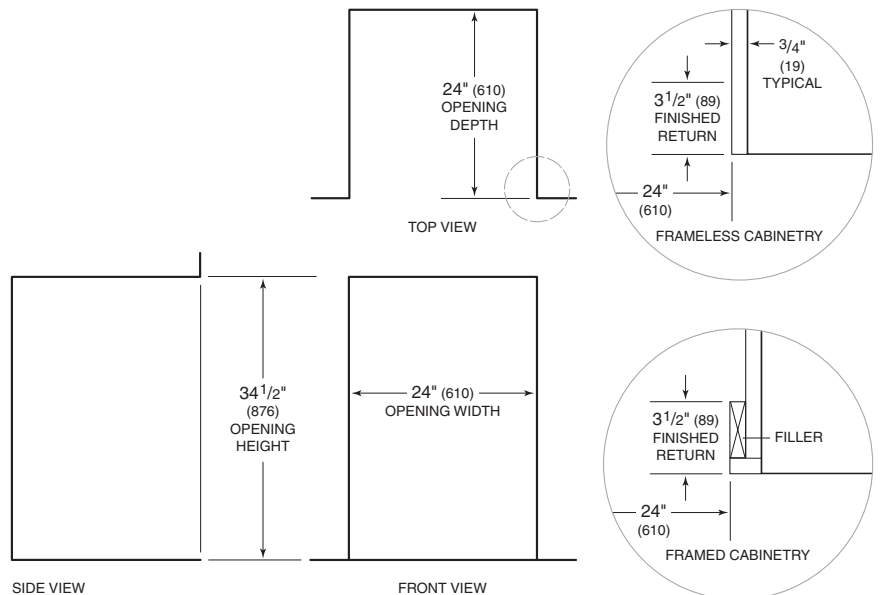

NOTE: 3<sup>1</sup>/<sub>2</sub>" (89) finished returns will be visible and should be finished to match cabinetry.